

1 DEMOLITION PARTIAL PLAN @ EX. LIFT  
A1 SCALE 1:50

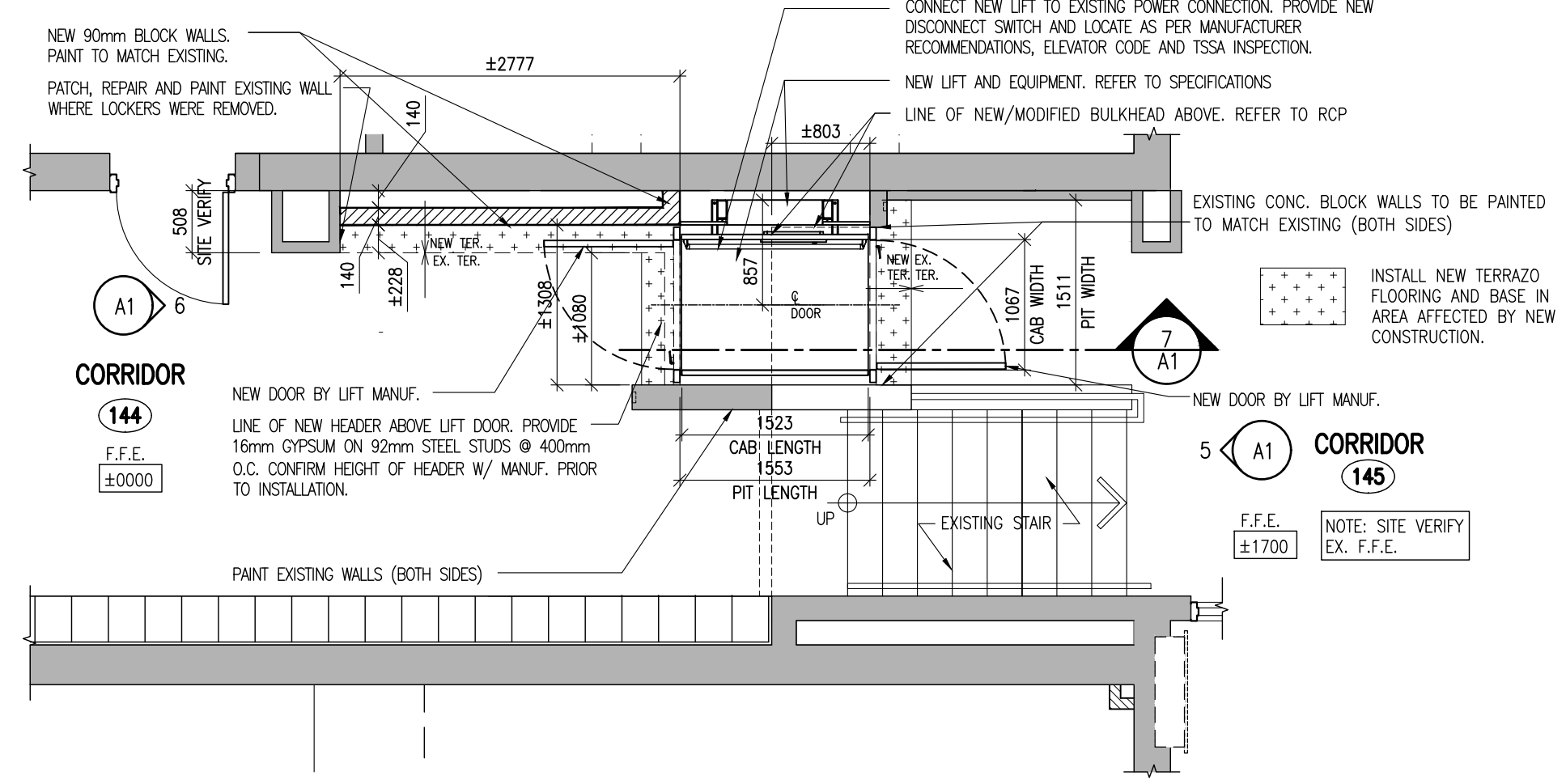

2 PROPOSED PARTIAL PLAN @ NEW LIFT  
A1 SCALE 1:50

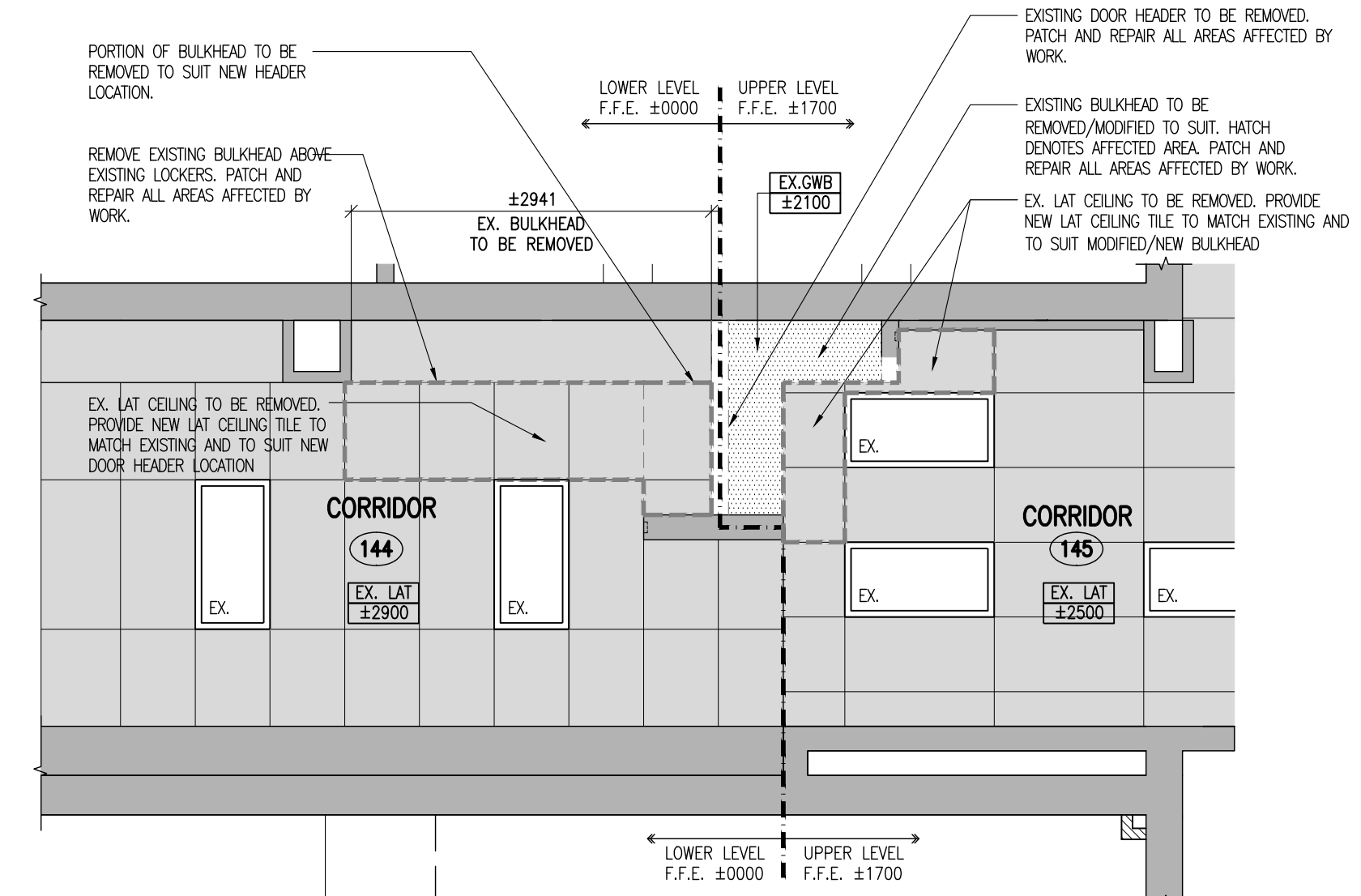

3 DEMOLITION PARTIAL RCP @ EX. LIFT  
A1 SCALE 1:50

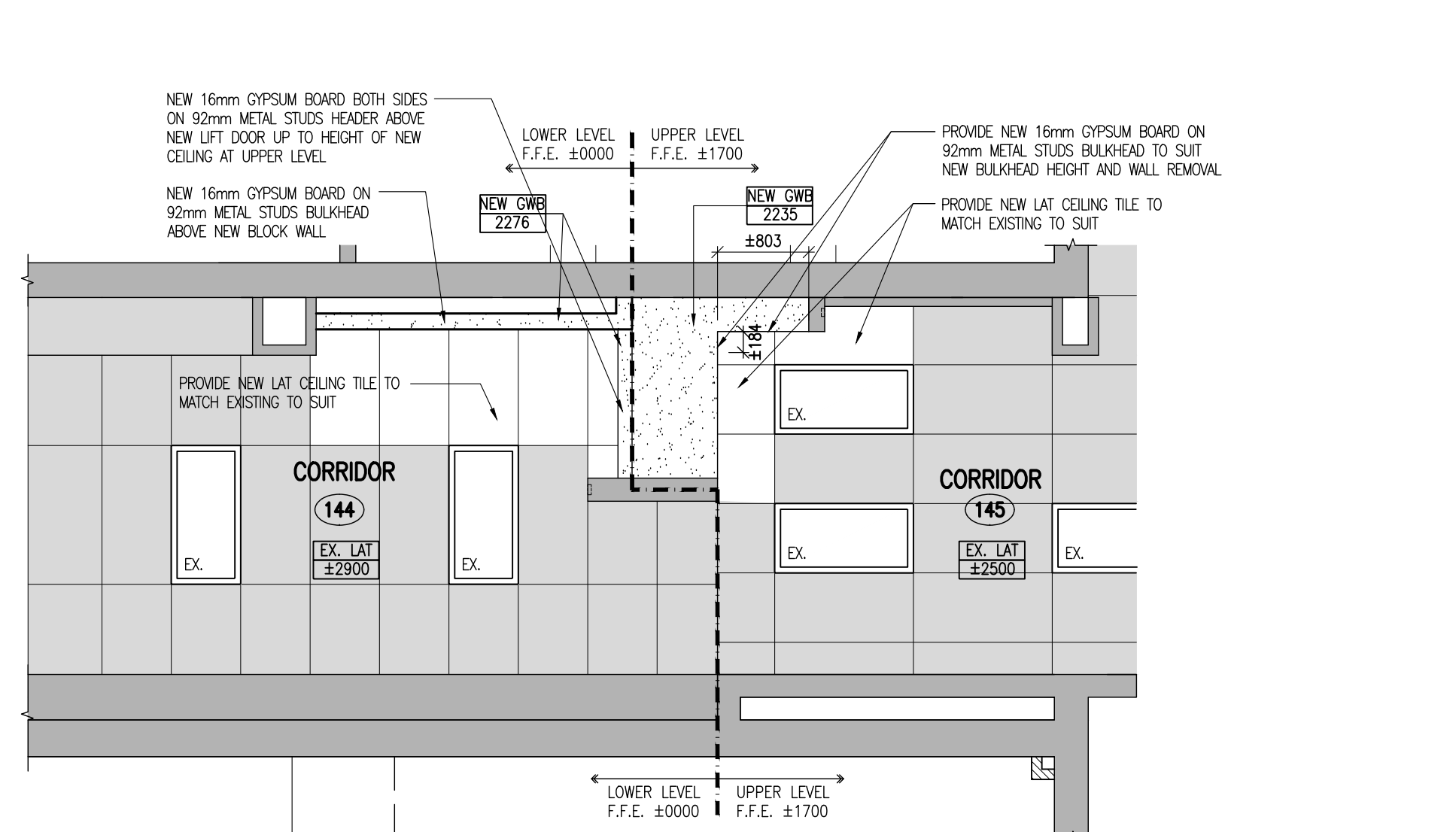

4 PROPOSED PARTIAL RCP @ NEW LIFT  
A1 SCALE 1:50

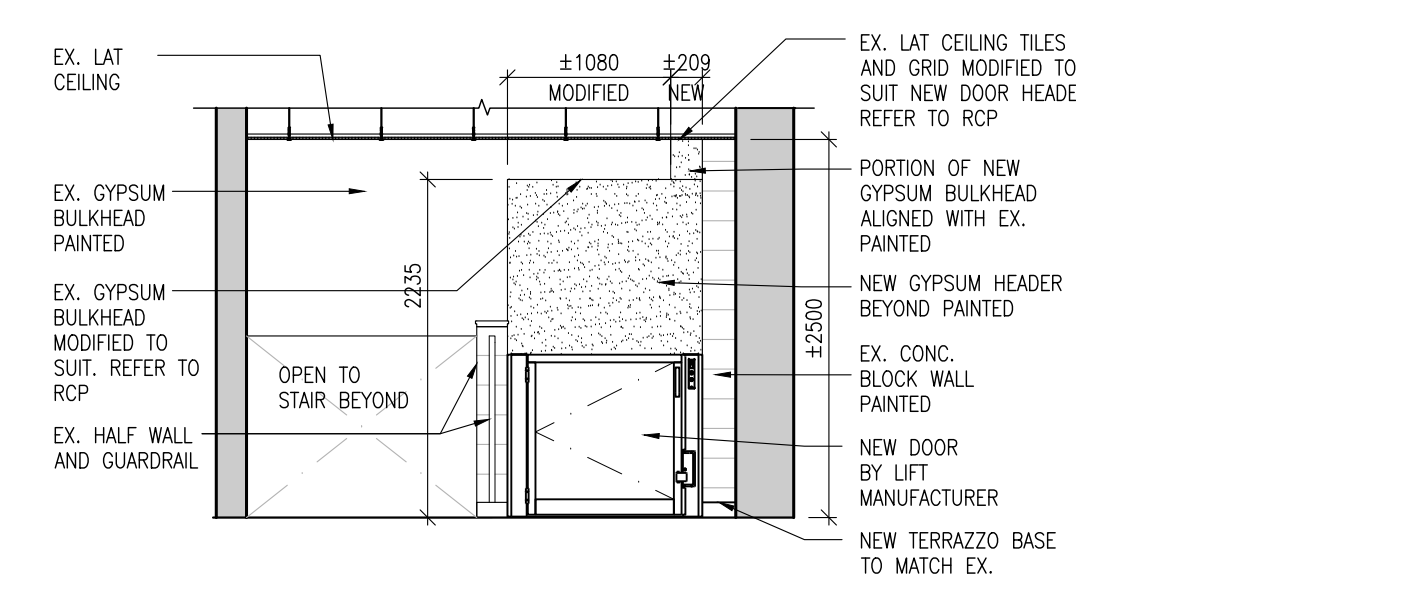

5 ELEVATION  
A1 SCALE 1:50

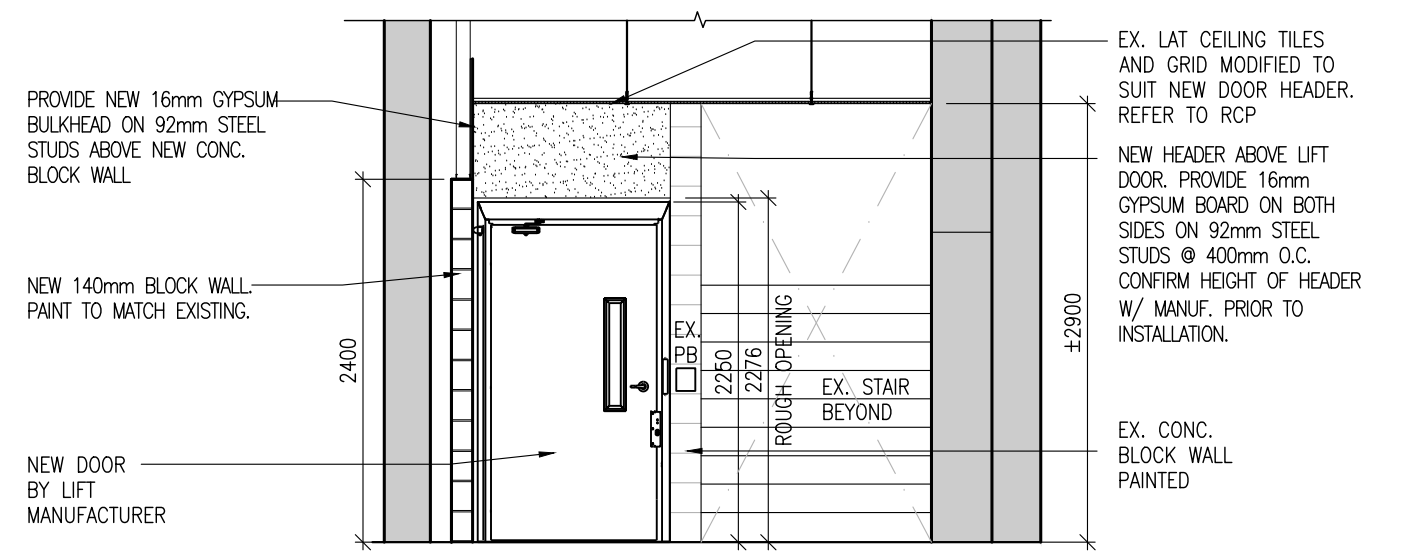

6 ELEVATION  
A1 SCALE 1:50

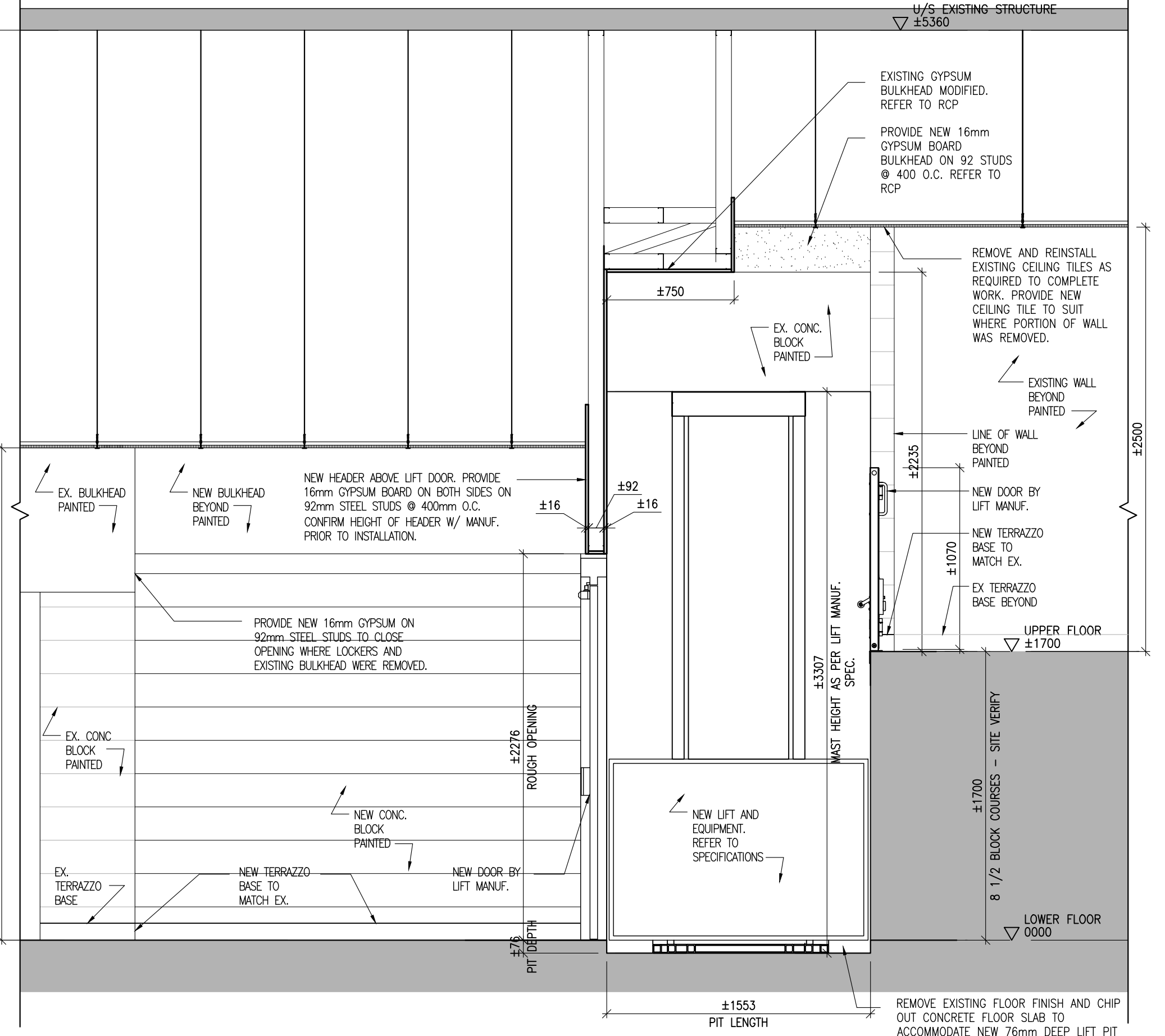

7 SECTION  
A1 SCALE 1:50

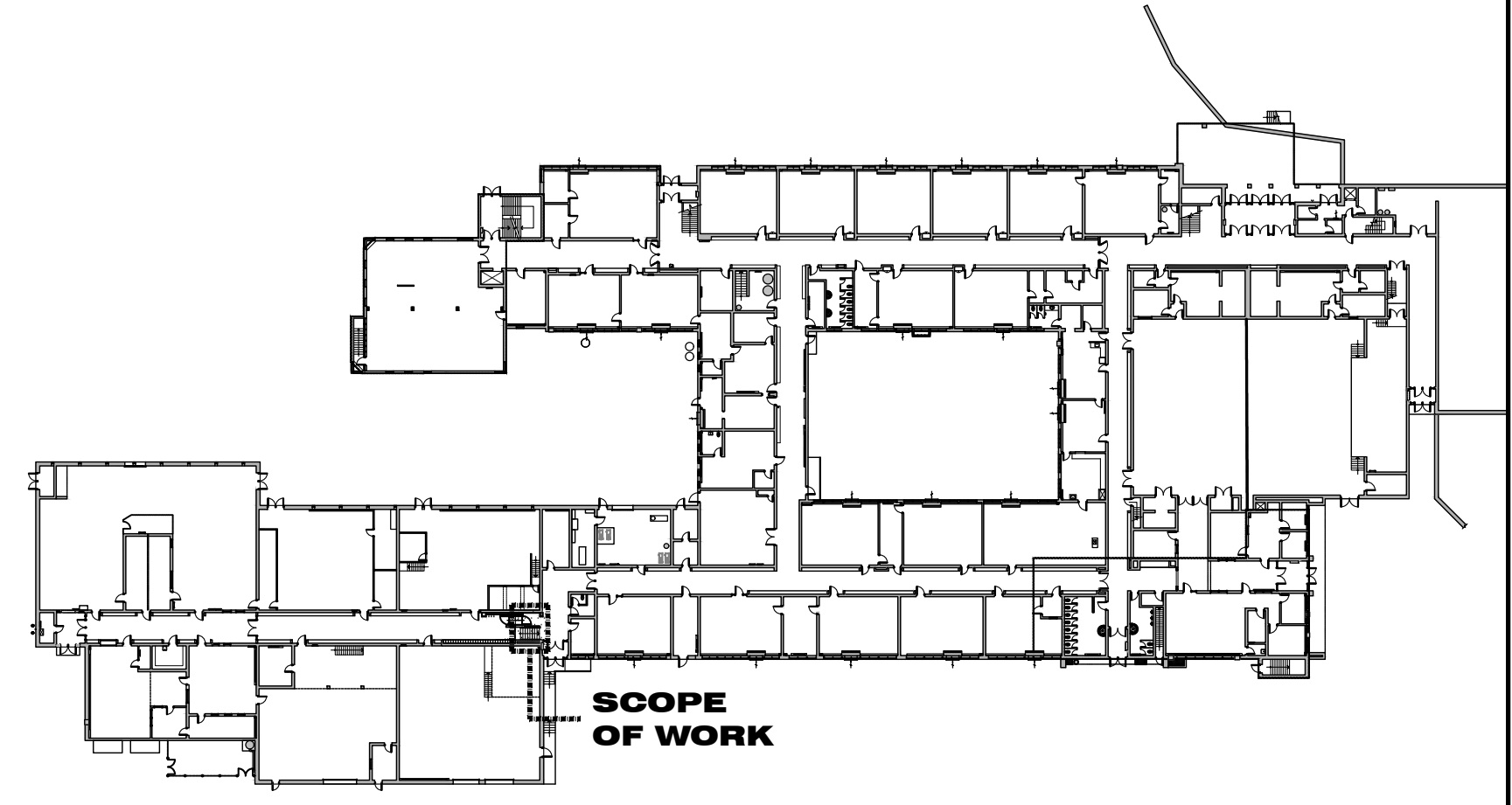

KEY PLAN  
SCALE: N.T.S.

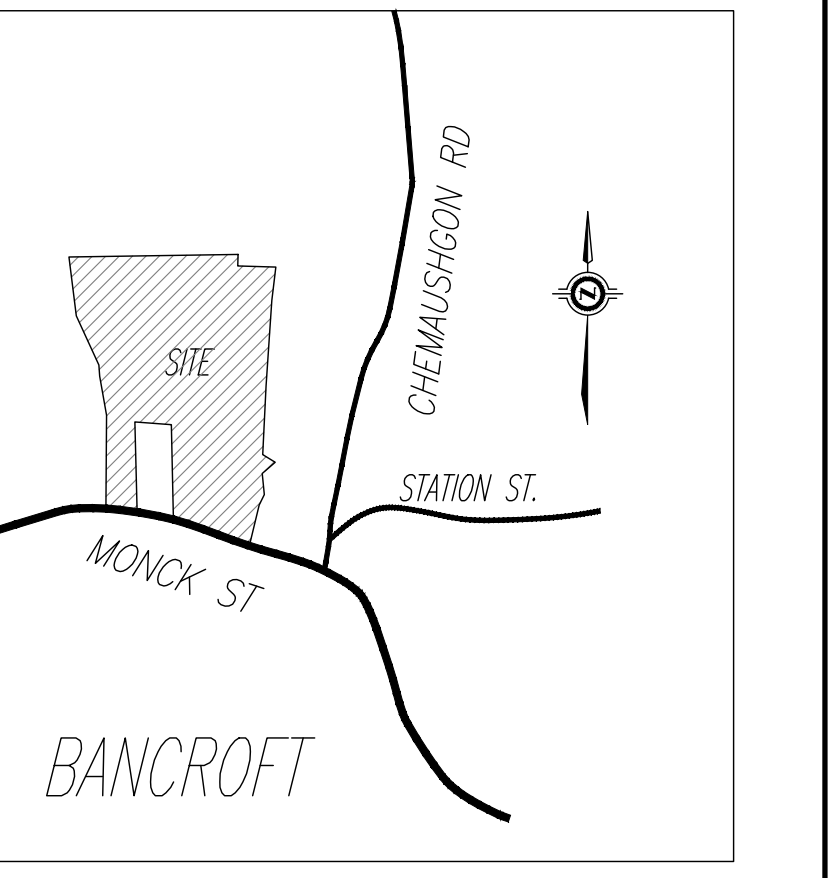

KEY SITE PLAN  
SCALE: N.T.S.

Ontario Building Code Data Matrix - Part 11 - Renovation of Existing Building		OBC Reference
11.00 Building Code Version:	0, Reg. 332/12 Last Amendment: 0, Reg. 191/14	
11.01 Project Type:	<input type="checkbox"/> Addition <input checked="" type="checkbox"/> Renovation <input type="checkbox"/> Addition and renovation Description: New Vertical Lift	[A]1.1.2
11.02 Major Occupancy Classification:	Occupancy: A2-Assembly Use: School	3.1.2.1.(1)
11.03 Superimposed Major Occupancies:	<input checked="" type="checkbox"/> No <input type="checkbox"/> Yes Description:	3.2.2.7
11.04 Building Area (m <sup>2</sup> ):	Description: New Vertical Lift Existing Renovation Total 4.7 m <sup>2</sup> 4.7 m <sup>2</sup>	[A]1.4.1.2
11.05 Building Height:	Two Storeys above grade 7.5m (m) Above grade 0 Storeys below grade	[A]1.4.1.2 & 3.2.1.1
11.06 Number of Streets/Firefighter access:	One Streets	3.2.2.10 & 3.2.5
11.07 Building Size:	<input type="checkbox"/> Small <input type="checkbox"/> Medium <input checked="" type="checkbox"/> Large <input type="checkbox"/> > Large	1.11.2.1.B
11.08 Existing Building Classification:	Change in major occupancy: <input type="checkbox"/> Yes <input checked="" type="checkbox"/> Not Applicable (no change of major occupancy) Hazard Index Importance Category: <input type="checkbox"/> Low <input type="checkbox"/> Normal <input type="checkbox"/> High <input type="checkbox"/> Post-disaster	11.2.1.1 1.11.2.1.1A 1.11.2.1.1B to N 4.2.1.(3) 5.2.2.1.(2)
11.09 Renovation type:	Basic Renovation <input checked="" type="checkbox"/> Extensive Renovation <input type="checkbox"/>	11.3.3.1 11.3.3.2
11.10 Occupant Load:	Floor Level/Area Occupancy Type Based On Occupant Load (Persons) Not Compliant (Existing)	3.1.17
11.11 Plumbing Fixture Requirements:	Ratio: M/F = 1/1 Except as otherwise noted Floor Level/Area Occupant Load OBC Reference Fixtures Required Fixtures Provided No Change in Occupant Load, No Change to W.C. Count	3.7.4.3.1
11.12 Barrier-free Design:	<input checked="" type="checkbox"/> Yes Explanation: <input type="checkbox"/> No	11.3.3.2.(2)
11.13 Reduction in Performance Level:	Structural: <input checked="" type="checkbox"/> NO <input type="checkbox"/> YES By increase in occupant load: <input checked="" type="checkbox"/> NO <input type="checkbox"/> YES By change in major occupancy: <input checked="" type="checkbox"/> NO <input type="checkbox"/> YES Plumbing: <input checked="" type="checkbox"/> NO <input type="checkbox"/> YES Sewage-system: <input checked="" type="checkbox"/> NO <input type="checkbox"/> YES Extension of Combustible Construction: <input checked="" type="checkbox"/> NO <input type="checkbox"/> YES	11.4.2.1 11.4.2.2 11.4.2.3 11.4.2.4 11.4.2.5 11.4.2.6
11.14 Compensating Construction:	<input checked="" type="checkbox"/> No <input type="checkbox"/> Yes Structural: <input checked="" type="checkbox"/> NO <input type="checkbox"/> YES (Describe) Increase in occupant load: <input checked="" type="checkbox"/> NO <input type="checkbox"/> YES (Describe) Change in major occupancy: <input checked="" type="checkbox"/> NO <input type="checkbox"/> YES (Describe) Plumbing: <input checked="" type="checkbox"/> NO <input type="checkbox"/> YES (Describe) Sewage-system: <input checked="" type="checkbox"/> NO <input type="checkbox"/> YES (Describe) Extension of Combustible Construction: <input checked="" type="checkbox"/> NO <input type="checkbox"/> YES (Describe)	11.4.3.1 11.4.3.2 11.4.3.3 11.4.3.4 11.4.3.5 11.4.3.6 11.4.3.7
11.15 Compliance Alternatives Proposed:	<input checked="" type="checkbox"/> NO <input type="checkbox"/> YES (list numbers and describe) (list numbers and describe)	11.5.1
11.16 Notes:		11.5.1

01 MAY 05, 2026 ISSUED FOR TENDER AND PERMIT

**NORTH HASTINGS HIGH SCHOOL - LIFT REPLACEMENT**

14 MONCK STREET BANCROFT, ONTARIO

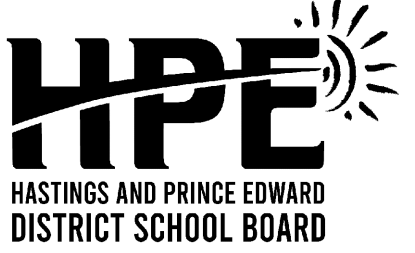

O.B.C. MATRIX / PARTIAL PROPOSED & DEMOLITION PLAN / RCP / ELEVATIONS & SECTION

ONTARIO ASSOCIATION OF ARCHITECTS  
Ken MacSpörran  
LICENCE 4751

TRUE NORTH DWG. NORTH

2614 JOB NO.

AS NOTED SCALE

**MOFFET & DUNCAN architects inc.**

5052 DUNDAS ST. WEST TORONTO, ONT. M9A 1B9  
TEL: (416) 239-2775  
FAX: (416) 239-6729  
EMAIL: mdarch@mdarch.ca

MAY 2026 DATE  
MAY 05, 2026 PRINTED

A1 DWG. NO.

DRAWN BY: M. J. DUNCAN, NORTH HASTINGS HS LIFT REPLACEMENT 10 - 40023, REVISED DRAWING 2024.03.01, FLOOR PLAN, 10/05/2024, 10:58 AM