

ASBESTOS-CONTAINING BUILDING MATERIALS RE-ASSESSMENT REPORT

Bracebridge Muskoka Lakes Secondary School

100 Clearbrook Trail
Bracebridge, Ontario

Presented to:

Trillium Lakelands District School Board

Box 420, County Road 36
Lindsay, Ontario
K9V 4S4

Attention: Daniel Whalen

September 2025

Maple Project No. 22300-50

Executive Summary

2025 Asbestos-Containing Building Materials Re-Assessment Report

Maple Project	School Name	Address
22300-50	Bracebridge Muskoka Lakes Secondary School	100 Clearbrook Trail Bracebridge, Ontario

Maple Environmental Inc. was retained by Trillium Lakelands District School Board to perform a re-assessment of known asbestos-containing building materials within the subject building.

The findings and recommendations of the current assessment are summarized below. Please refer to the main body of the report for details.

FINDINGS

Asbestos-containing materials (ACM) identified within the building at the time of the assessment are as follows:

ASBESTOS BUILDING MATERIALS SUMMARY							
MATERIAL	ASBESTOS			FRIABILITY			Remedial Work Required
	Yes	No	Suspect	Friable	Non-Friable	Potentially	
Sprayed Fireproofing		X		X			NO
Textured Finish		X		X			NO
Mechanical Insulations	Pipe Fittings		X		X		NO
	Pipe Straight		X		X		NO
	Ductwork		X		X		NO
	Mechanical Equip.		X		X		NO
Ceiling Tiles		X				X	NO
Vinyl Sheet Flooring		X				X	NO
Vinyl Floor Tiles		X			X		NO
Asbestos Cement (Transite)	X				X		NO
Plaster		X				X	NO
Drywall Joint Compound		X			X		NO
Other		X					NO

Please refer to Room by Room Inventory in Appendix I to view location, quantities, and condition of ACM observed within the building at the time of the assessment.

Executive Summary

2025 Asbestos-Containing Building Materials Re-Assessment Report

RECOMMENDATIONS

As asbestos-containing materials were found to be present within the building, Ontario Regulation 278/05 requires that the Trillium Lakelands District School Board's Asbestos Management Plan must apply to this building. In addition, an annual re-assessment of all ACM must be performed.

All asbestos-containing materials identified within the building were observed to be in GOOD condition and therefore no immediate recommendations are warranted.

General Statement

The Executive Summary must be read in conjunction with the main body of this report.

TABLE OF CONTENTS

EXECUTIVE SUMMARY	<i>i</i>
1.0 INTRODUCTION	1
2.0 APPLICABLE ONTARIO REGULATIONS.....	1
2.1 ONTARIO REGULATION 278/05 (ASBESTOS).....	1
2.2 ONTARIO REGULATION 347	2
3.0 SURVEY SCOPE AND METHODOLOGY.....	2
3.1 INVENTORY METHODOLOGY.....	3
3.2 ASBESTOS ASSESSMENT CRITERIA	3
3.3 LIMITATIONS AND OMISSIONS FROM SCOPE	4
3.4 SAMPLING STRATEGY AND ANALYTICAL METHODS	5
3.5 DRAWINGS	6
4.0 INVENTORY FINDINGS.....	6
4.1 SPRAYED FIREPROOFING (FRIABLE)	7
4.2 THERMAL MECHANICAL INSULATION (FRIABLE).....	7
4.3 TEXTURE FINISH (FRIABLE)	7
4.4 ACOUSTIC CEILING TILES (POTENTIALLY FRIABLE)	7
4.5 VINYL SHEET FLOORING (POTENTIALLY FRIABLE)	7
4.6 VINYL FLOOR TILE (NON-FRIABLE).....	7
4.7 ASBESTOS CEMENT PRODUCTS "TRANSITE" (NON-FRIABLE).....	7
4.8 DRYWALL JOINT COMPOUND (DJC)	8
4.9 PLASTER	8
5.0 RECOMMENDATIONS	8
5.1 GENERAL RECOMMENDATIONS	8
5.2 SPECIFIC RECOMMENDATIONS	8
6.0 LIMITATIONS.....	8
APPENDIX I	ROOM-BY-ROOM ASBESTOS INVENTORY
APPENDIX II	DRAWINGS
APPENDIX III	POTENTIAL ASBESTOS-CONTAINING MATERIAL IDENTIFICATION SHEET

1.0 INTRODUCTION

MAPLE Environmental Inc. ("MAPLE") was retained by the Trillium Lakelands District School Board (TLDSB) to perform a re-assessment of known asbestos-containing building materials within all TLDSB schools where asbestos was previously confirmed to be present (by others).

The assessment was completed in accordance with the requirement of Ontario Regulation 278/05 to complete a re-assessment on an annual basis.

The following report presents the findings and recommendations of the assessment for the specific building listed.

SUMMARY OF BUILDING INFORMATION	
School Name:	Bracebridge Muskoka Lakes Secondary School
Building Address:	100 Clearbrook Trail, Bracebridge, Ontario
Number of Floors:	2
Approximate Square Footage:	165,000
Assessed by:	Josh Prosser
Assessment Date:	July 8, 2025

2.0 APPLICABLE ONTARIO REGULATIONS

Applicable Ontario Regulations for each of the materials included in the investigation are briefly described below.

2.1 Ontario Regulation 278/05 (Asbestos)

The Ontario Ministry of Labour Regulation 278/05 requires a detailed asbestos inventory be performed in all buildings where friable and non-friable asbestos-containing materials (ACM) are present. The inventory must be available at the work place and must identify the type and location of asbestos-containing materials on a room-by-room basis, where necessary.

Each individual building report prepared by MAPLE meets or exceeds the requirements for an asbestos survey under Ontario Regulation 278/05.

Ontario Regulation 278/05 applies to buildings with regards to maintenance, renovation or demolition work where ACM is present and may be disturbed. The regulation requires all buildings where asbestos is known to be part of the building materials to implement an Asbestos Management Program (AMP). TLDSB has prepared and maintains an AMP of which the current Re-Assessment report is part of.

2.2 Ontario Regulation 347

Ontario Regulation 347 applies to the transport of waste from the location of generation to a landfill site authorized to receive specific wastes. The regulation also prescribes procedures on how the specific wastes are to be handled at the landfill site.

The major requirements of the building owner and the person(s) removing the waste are to ensure that:

- The waste is appropriately packaged and labelled;
- The transport vehicle is appropriately placard; and
- The waste is to be transported as directly as possible to the landfill site once it leaves the site.

Some wastes require the Owner to register a Generator (of waste) number and many wastes require classification that can restrict or even prohibit their disposal in landfill.

It is important to note that the building owner can be held responsible for the waste until the waste disposal site accepts it.

3.0 SURVEY SCOPE AND METHODOLOGY

The surveys were performed on a Room-by-Room basis within each building included in the scope of the assessment where asbestos was previously identified (by others).

The scope of the surveys included all friable and major non-friable materials suspected to contain asbestos. The term friable is applied to a material that can be readily reduced to dust or powder by hand or moderate pressure. Asbestos materials that are friable have a much greater potential to release airborne asbestos fibres when disturbed.

Typical friable asbestos materials include; sprayed fireproofing or thermal insulation, textured (stippled) plaster, and thermal mechanical insulation. Typical non-friable materials include: asbestos cement (transite) products, caulking, vinyl floor tiles, asbestos textiles and gaskets. Additional materials such as ceiling tiles and drywall joint compounds are classified as non-friable, but because of their ability to release dust when disturbed they are considered as "potentially friable" for the purpose of this report.

3.1 Inventory Methodology

In order to determine the location of the materials included in the assessment, each room or area was entered where practical (i.e.: where access was possible without the demolition of walls, roof or ceilings or destruction of flooring) where asbestos materials were previously identified. An investigation of areas of the building where asbestos was not previously identified was not included in the scope of the current project.

Representative views were made above accessible suspended ceiling systems. Drywall or plaster ceilings were accessed via existing ceiling access panels only. The inventory did not include destructive testing of building systems or finishes to observe possible hidden conditions.

3.2 Asbestos Assessment Criteria

The recommendations and suggestions made as part of this report with respect to asbestos have taken into consideration the condition and accessibility of the asbestos-containing material as well as other factors such as water damage, vibration, air movement, and general activities in the area.

Where ACM is found to be in GOOD condition and not likely to deteriorate or fall, the general recommendation would be to re-evaluate the condition of the material on an annual basis (required by Regulation 278/05). This recommendation can be subject to change if the material is located in a manner that persons untrained in asbestos awareness could physically damage it.

Where the ACM is found to be damaged (i.e. FAIR or POOR condition), a recommendation to have the material cleaned-up, repaired, removed, enclosed, or encapsulated is offered. The recommendation will also indicate which asbestos procedure should be used to perform the remedial work (i.e. Type 1, Type 2, Type 3, or Glove Bag Removal Methods).

In each area or room inventoried, the quantity, condition (GOOD, FAIR, or POOR) and accessibility (A, B, C, D or E) of each suspect material was recorded.

The definitions for condition and accessibility items are as follows:

- | | |
|-----------------|---|
| GOOD | Material is intact with no visible signs of damage. |
| FAIR | Material is visibly damaged but can be repaired. |
| POOR | Material is damaged beyond repair and likely needs to be removed. |
| Access A | Accessible to all occupants of the building. |

- Access B** Accessible to Maintenance personnel without the use of a ladder (i.e. Mechanical Room, pipe chase etc.).
- Access C** Accessible to Maintenance personnel with the use of a ladder and is exposed to view without removing building components.
- Access D** Accessible to Maintenance personnel with the use of a ladder and is concealed from viewing due to a building component (i.e. above a removable ceiling).
- Access E** Not accessible without demolition of a building component (i.e. above a fixed ceiling system).

The asbestos related information collected during the previous assessments was confirmed and the room-by-room data updated to reflect the current information.

3.3 Limitations and Omissions from Scope

Due to the nature of building construction, some limitations exist in regards to the possible thoroughness of any building materials inventory. The field observations, measurements, and analysis are considered sufficient in detail and scope to form a reasonable basis for the findings presented in this report. MAPLE warrants that the findings and conclusions contained herein have been made in accordance with generally accepted evaluation methods in the industry and applicable regulations at the time of the performance of the inventory.

It is possible that conditions may exist which could not be reasonably identified within the scope of the inventory or which were not apparent during the site investigation. MAPLE believes that the information collected during the inventory period concerning the property is reliable. No other warranties are implied or expressed.

In addition, during a standard asbestos assessment, performed for the purposes of regulatory compliance, it is industry practice to exclude some non-friable materials in the inventory. Examples of such assumptions include; elevator brakes, roofing felts and mastics, high voltage wiring, mechanical packing and gaskets, underground services or piping, fire-doors, window caulking, levelling compound, and/or materials used in operating equipment. As such, these materials were not sampled at the time of this survey and where present are assumed to be asbestos containing until proven otherwise.

3.4 Sampling Strategy and Analytical Methods

As the majority of materials were previously sampled by others, the requirement for sampling during the current survey was limited. Where samples were collected, they conformed to the criteria outlined below and in compliance with O. Reg. 278/05.

A small volume of the material was removed either from a damaged section or cut out of intact material and then repaired by sealing with tape to prevent the release of fibres. The collected samples were placed in plastic bags, sealed and labelled and then sent to an independent laboratory for analysis. To ensure quality results, the independent laboratory chosen is NVLAP accredited and successfully participates in an "Asbestos Proficiency Analytical Testing Program" and as such, these laboratories are responsible for their findings.

The collection of samples was performed in accordance with regulatory sampling requirements and with sufficient frequency to obtain a general pattern of asbestos use within the building. Due to building renovations or modifications that have occurred, the consistency of the application of asbestos materials may not be uniform throughout the entire building. It is important to note that without sampling every wall, pipe section, ceiling tile etc. it is not possible to identify the possible asbestos content in every material present in the building. For this reason, materials similar in appearance to those sampled elsewhere in the building were visually identified as being homogeneous and thus are assumed to be composed of the same material, thus additional sampling is not required.

In accordance with Reg. 278/05, samples were collected at the following frequency.

Material Type	No. Samples
Sprayed Fireproofing	Up to 7
Texture Coat	Up to 7
Pipe Fitting Insulation	3
Pipe Straight Insulation	3
Ductwork Insulation	3
Ceiling Tiles	3
Vinyl Sheeting Flooring	3
Vinyl Floor Tile	3
Plaster Finishes	Up to 7
Drywall Compound	Up to 7

An independent NVLAP accredited laboratory, was used to analyse the collected samples. Analysis was performed following the Code of Practice for the identification of asbestos in bulk material, as detailed in Ontario Regulation 278/05. Bulk samples were analysed using the Polarized Light Microscopy ("PLM") Technique with Dispersion Staining. The identification of asbestos fibre in bulk material is based on a collective set of parameters dependent on the unique shape and crystallographic properties of each fibre as viewed through the microscope. This method is useful for the qualitative identification of asbestos and the semi-quantitative determination of asbestos content in bulk materials expressed as a percent of projected area. The method identifies types of asbestos and also measures percent of asbestos as perceived by the analyst in comparison to standard area projections or trained experience.

Given the composition of some vinyl floor products, the PLM analysis method is often prone to yielding false negative analysis results. Therefore it may be prudent that the Transmission Electron Microscopy (TEM) analysis method be used to determine the asbestos content in the vinyl floor products, if negative results are obtain from the laboratory analysis.

3.5 Drawings

Drawings provided for each building indicate the following (where present):

- ◇ Location Numbers (reference to Room-by-Room asbestos data)
- ◇ Asbestos-Containing Sprayed Fireproofing
- ◇ Asbestos-Containing Texture Finishes
- ◇ Asbestos Containing Ceiling Tiles
- ◇ Asbestos-Containing Flooring Materials
- ◇ Presence of Asbestos-Containing Mechanical Insulations will not be specifically indicated on the drawings; however, a general statement regarding the presence of ACM mechanical insulations, where present, has been indicated on the drawings.
- ◇ Presence of asbestos-containing drywall joint compound and hard plaster will not be specifically identified on the drawings; however, a general statement regarding the presence of these ACM materials, where present, has been indicated on the drawings.

4.0 INVENTORY FINDINGS

The following is a brief discussion of the extent to which asbestos-containing materials (ACM) was identified in the building. The discussion is organized under the headings of materials that are generally suspected of containing asbestos. Refer to the Room-by-Room Survey Inventory in Appendix I for a detailed description and location of all ACM.

Destructive testing was not conducted and as such some areas within the building were not accessible for an assessment (i.e. above solid ceilings, behind walls). Access for viewing within wall and ceiling cavities was not always possible. Suspect asbestos materials may be present within ceiling and wall cavities that were not identified in this report. This comment is particularly important for materials such as mechanical insulation. Caution should be taken when demolishing solid wall finishes within the building.

4.1 Sprayed Fireproofing (Friable)

No sprayed fireproofing was observed in the building.

4.2 Thermal Mechanical Insulation (Friable)

No asbestos-containing mechanical insulations are present in the building. It is important to note that mechanical systems may be present within walls and ceiling cavities or pipe chases that were not accessible during this assessment. The presence of ACM mechanical insulations in these locations should be suspected.

4.3 Texture Finish (Friable)

No asbestos-containing texture finishes were identified to be present within the building.

4.4 Acoustic Ceiling Tiles (Potentially Friable)

No asbestos-containing ceiling tiles were identified to be present within the building.

4.5 Vinyl Sheet Flooring (Potentially Friable)

No asbestos-containing vinyl sheet flooring was identified to be present within the building.

4.6 Vinyl Floor Tile (Non-Friable)

Vinyl floor tiles in the building are not suspected of containing asbestos.

4.7 Asbestos Cement Products "Transite" (Non-Friable)

Asbestos-containing transite is present in the form of rain water leaders and roof drains. All transite was found to be in GOOD condition. Refer to the Room-by-Room Inventory in Appendix I for details regarding location and quantity.

It is important to note that previous reports did not indicate the presence of asbestos rain water leaders in various areas of the building. Therefore, caution should be taken when performing work in the building that may

disturb rain water leaders as the drawings and asbestos inventory data may not accurately reflect actual site conditions.

4.8 Drywall Joint Compound (DJC)

Due to the recent age of the building, the presence of asbestos in drywall joint compound is not suspected.

4.9 Plaster

No plaster finishes are present in the building.

5.0 RECOMMENDATIONS

5.1 General Recommendations

Due to the presence of ACM within the building, TLDSB must maintain their existing Asbestos Management Program for this property.

A re-assessment of known ACM is to be conducted at least once annually.

It is important to note that due to the presence of solid walls and ceiling systems, ACM may be present in concealed locations not identified in this report.

Removal or disturbance of transite cement products requires the use of Type 1 Asbestos procedures (provided no power tools are used and the material is wetted). If power tools are required Type 3 Asbestos procedures need be applied.

5.2 Specific Recommendations

All ACM was identified in GOOD condition. As such no immediate recommendations are warranted at this time.

6.0 LIMITATIONS

Due to the nature of building construction some limitations exist as to the possible thoroughness of the subject investigation. The field observations are considered sufficient in detail and scope to form a reasonable basis for the findings presented in this report. MAPLE warrants that the findings and conclusions contained herein have been made in accordance with generally accepted evaluation methods in the industry and applicable regulations at the time of the performance of the assessment.

It is possible that conditions may exist which could not be reasonably identified within the scope of the investigation or which were not apparent during the site investigation. MAPLE believes that the information collected during the investigation period concerning the property is reliable. No other warranties are implied or expressed.

Information provided by Maple is intended for Client use only. Any use by a third party, of reports or documents authored by Maple, or any reliance by a third party on or decisions made by a third party based on the findings described in said documents, is the sole responsibility of such third parties. Maple accepts no responsibility for damages suffered by any third party as a result of decisions made or actions conducted.

The liability of Maple or its staff will be limited to the lesser of the fees paid or actual damages incurred by the Client. Maple will not be responsible for any consequential or indirect damages. Maple will only be liable for damages resulting from negligence of Maple; all claims by the Client shall be deemed relinquished if not made within two years after last date of services provided.

Please contact Maple Environmental Inc. at (905) 257-4408 for inquiries regarding this project.

Sincerely,

MAPLE ENVIRONMENTAL INC.
Environment, Health and Safety Consultants

Prepared By:



Josh Prosser
Project Technologist

APPENDIX I
ROOM-BY-ROOM ASBESTOS INVENTORY



STRUCTURAL ELEMENT

RF: Roof
WN: Window
FL: Floor
CL: Ceiling
WL: Wall
DK: Deck

B/J: Beams/Joists
CB: Chalkboard
PI: Pipe
DT: Duct
BL: Boiler
MC: Mechanical

ACCESSIBILITY

A: All occupants of the facility
B: Maintenance staff without a ladder
C: Maintenance staff with a ladder, exposed to view without moving building components
D: Maintenance staff with a ladder, concealed from view by building components

E: No access without demolition or removal of fixed building components or systems

TERMINOLOGY

ACM: Asbestos Containing Material
CT: Ceiling Tile
DJC: Drywall Joint Compound
FT: Fitting
LF: Linear Feet

N/A: Not Applicable
N/Anz: Not Analyzed
N/D: None Detected
PI-AC: Pipe Insulation - Aircell
PI-PC: Pipe Insulation-Pariging Cement
PI-CP: Pipe Insulation-Caposite

PL: Plaster
RM: Roofing Materials
SFP: Sprayed Fireproofing
SF: Square Feet
TF: Texture Finish

TB: Transite Board
TP: Transite Pipe
VI: Vermiculite Insulation
VFT: Vinyl Floor Tile

VSF: Vinyl Sheet Flooring
V/C: Visually Consistent w/ Other Sampled Material
WC: Window Caulking

CONDITION G: Good F: Fair P: Poor

ID	Facility	Floor #	Room #	Room name	Has ACM	Friable	Struct. Elem.	Application	Material	Type	Qty	Condition	Sample #	Action	Ref #	Comments 1	Comments 2	Comments 3	Notes
77848	Bracebridge & Muskoka Lakes Secondary School	1	101	Vestibule 1C	No	No	CL	DJC	4	N/D	-	-	V/C:14152-46-04	-	-	-	-	-	-
77793	Bracebridge & Muskoka Lakes Secondary School	1	102	Atrium	No	No	WL	DJC	3	N/D	-	-	14152-46-03F,G	-	-	-	-	-	-
77846	Bracebridge & Muskoka Lakes Secondary School	1	103	Room 112	No	No	FL	VFT	1	N/D	-	-	V/C:14152-46-06	-	-	-	-	-	-
77847	Bracebridge & Muskoka Lakes Secondary School	1	103	Room 112	No	No	CL	DJC	4	N/D	-	-	V/C:14152-46-04	-	-	-	-	-	-
77836	Bracebridge & Muskoka Lakes Secondary School	1	104	Auditorium 110	No	No	CL	DJC	4	N/D	-	-	V/C:14152-46-04	-	-	-	-	-	-
77838	Bracebridge & Muskoka Lakes Secondary School	1	104A	Servery 110A	No	No	FL	VFT	1	N/D	-	-	V/C:14152-46-06	-	-	-	-	-	-
77839	Bracebridge & Muskoka Lakes Secondary School	1	104A	Servery 110A	No	No	CL	DJC	4	N/D	-	-	V/C:14152-46-04	-	-	-	-	-	-
77840	Bracebridge & Muskoka Lakes Secondary School	1	104B	Theatre Box Office 110B	No	No	FL	VFT	1	N/D	-	-	V/C:14152-46-06	-	-	-	-	-	-
77841	Bracebridge & Muskoka Lakes Secondary School	1	104B	Theatre Box Office 110B	No	No	CL	DJC	4	N/D	-	-	V/C:14152-46-04	-	-	-	-	-	-
77844	Bracebridge & Muskoka Lakes Secondary School	1	105	Vestibule 1B	No	No	FL	VFT	1	N/D	-	-	V/C:14152-46-06	-	-	-	-	-	-
77845	Bracebridge & Muskoka Lakes Secondary School	1	105	Vestibule 1B	No	No	CL	CT	1	N/D	-	-	V/C:14152-46-05	-	-	-	-	-	-
77837	Bracebridge & Muskoka Lakes Secondary School	1	106	Stage 110	No	No	WL	DJC	3	N/D	-	-	V/C:14152-46-03	-	-	-	-	-	-
77833	Bracebridge & Muskoka Lakes Secondary School	1	107	Stairwell 7	No	No	FL	VFT	1	N/D	-	-	V/C:14152-46-06	-	-	-	-	-	-
77834	Bracebridge & Muskoka Lakes Secondary School	1	107	Stairwell 7	No	No	WL	DJC	3	N/D	-	-	V/C:14152-46-03	-	-	-	-	-	-
77835	Bracebridge & Muskoka Lakes Secondary School	1	107	Stairwell 7	No	No	CL	CT	1	N/D	-	-	V/C:14152-46-05	-	-	-	-	-	-
77831	Bracebridge & Muskoka Lakes Secondary School	1	108	"Drama Vestibule"	No	No	FL	VFT	1	N/D	-	-	V/C:14152-46-06	-	-	-	-	-	-
77832	Bracebridge & Muskoka Lakes Secondary School	1	108	"Drama Vestibule"	No	No	CL	CT	1	N/D	-	-	V/C:14152-46-05	-	-	-	-	-	-
77842	Bracebridge & Muskoka Lakes Secondary School	1	109	Vestibule 1A	No	No	FL	VFT	1	N/D	-	-	V/C:14152-46-06	-	-	-	-	-	-
77843	Bracebridge & Muskoka Lakes Secondary School	1	109	Vestibule 1A	No	No	CL	CT	1	N/D	-	-	V/C:14152-46-05	-	-	-	-	-	-
77830	Bracebridge & Muskoka Lakes Secondary School	1	111	Corridor "1C"	No	No	CL	CT	1	N/D	-	-	V/C:14152-46-05	-	-	-	-	-	-
77817	Bracebridge & Muskoka Lakes Secondary School	1	112	Drama 108	No	-	-	-	-	-	-	-	-	-	-	-	-	-	No ACM or presumed ACM material
77818	Bracebridge & Muskoka Lakes Secondary School	1	112A	Storage Room 108A	No	No	FL	VFT	1	N/D	-	-	V/C:14152-46-06	-	-	-	-	-	-
77819	Bracebridge & Muskoka Lakes Secondary School	1	112A	Storage Room 108A	No	No	CL	CT	1	N/D	-	-	V/C:14152-46-05	-	-	-	-	-	-
77820	Bracebridge & Muskoka Lakes Secondary School	1	112B	Practice Room 108B	No	No	FL	VFT	1	N/D	-	-	V/C:14152-46-06	-	-	-	-	-	-
77821	Bracebridge & Muskoka Lakes Secondary School	1	112B	Practice Room 108B	No	No	CL	CT	1	N/D	-	-	V/C:14152-46-05	-	-	-	-	-	-
77822	Bracebridge & Muskoka Lakes Secondary School	1	112C	Washroom 108C	No	No	CL	DJC	4	N/D	-	-	V/C:14152-46-04	-	-	-	-	-	-
77823	Bracebridge & Muskoka Lakes Secondary School	1	112D	Dressing Room 108D	No	No	FL	VFT	1	N/D	-	-	V/C:14152-46-06	-	-	-	-	-	-
77824	Bracebridge & Muskoka Lakes Secondary School	1	112D	Dressing Room 108D	No	No	CL	CT	1	N/D	-	-	V/C:14152-46-05	-	-	-	-	-	-
77825	Bracebridge & Muskoka Lakes Secondary School	1	112E	Washroom 108E	No	No	CL	DJC	4	N/D	-	-	V/C:14152-46-04	-	-	-	-	-	-
77826	Bracebridge & Muskoka Lakes Secondary School	1	112F	Dressing Room 108F	No	No	FL	VFT	1	N/D	-	-	V/C:14152-46-06	-	-	-	-	-	-
77827	Bracebridge & Muskoka Lakes Secondary School	1	112F	Dressing Room 108F	No	No	CL	CT	1	N/D	-	-	V/C:14152-46-05	-	-	-	-	-	-
77828	Bracebridge & Muskoka Lakes Secondary School	1	112G	Storage Room 108G	No	-	-	-	-	-	-	-	-	-	-	-	-	-	No ACM or presumed ACM material
77829	Bracebridge & Muskoka Lakes Secondary School	1	112H	Water Meter 108H	No	-	-	-	-	-	-	-	-	-	-	-	-	-	No ACM or presumed ACM material
77816	Bracebridge & Muskoka Lakes Secondary School	1	113	Data 106	No	-	-	-	-	-	-	-	-	-	-	-	-	-	No ACM or presumed ACM material
77812	Bracebridge & Muskoka Lakes Secondary School	1	114	Cafeteria 104	No	No	FL	VFT	1	N/D	-	-	V/C:14152-46-06	-	-	-	-	-	-
77813	Bracebridge & Muskoka Lakes Secondary School	1	114	Cafeteria 104	No	No	WL	DJC	3	N/D	-	-	14152-46-03A,B	-	-	-	-	-	-
77814	Bracebridge & Muskoka Lakes Secondary School	1	114A	Storage 104A	No	-	-	-	-	-	-	-	-	-	-	-	-	-	No ACM or presumed ACM material
77815	Bracebridge & Muskoka Lakes Secondary School	1	114B	AV Storage 104B	No	-	-	-	-	-	-	-	-	-	-	-	-	-	No ACM or presumed ACM material
77810	Bracebridge & Muskoka Lakes Secondary School	1	115	Classroom 102	No	No	FL	VFT	1	N/D	-	-	V/C:14152-46-06	-	-	-	-	-	-
77811	Bracebridge & Muskoka Lakes Secondary School	1	115	Classroom 102	No	No	CL	CT	1	N/D	-	-	V/C:14152-46-05	-	-	-	-	-	-
77794	Bracebridge & Muskoka Lakes Secondary School	1	116	Hospitality Lab 100	No	No	FL	VSF	1	N/D	-	-	14152-46-08A	-	-	-	-	-	-
77795	Bracebridge & Muskoka Lakes Secondary School	1	116	Hospitality Lab 100	No	No	WL	DJC	3	N/D	-	-	14152-46-03C	-	-	-	-	-	-
77796	Bracebridge & Muskoka Lakes Secondary School	1	116	Hospitality Lab 100	No	No	CL	CT	1	N/D	-	-	V/C:14152-46-05	-	-	-	-	-	-
77797	Bracebridge & Muskoka Lakes Secondary School	1	116A	Storage Room 100A	No	No	FL	VSF	1	N/D	-	-	V/C:14152-46-08B	-	-	-	-	-	-
77798	Bracebridge & Muskoka Lakes Secondary School	1	116A	Storage Room 100A	No	No	WL	DJC	3	N/D	-	-	14152-46-03D,E	-	-	-	-	-	-
77799	Bracebridge & Muskoka Lakes Secondary School	1	116A	Storage Room 100A	No	No	CL	CT	1	N/D	-	-	V/C:14152-46-05	-	-	-	-	-	-
77800	Bracebridge & Muskoka Lakes Secondary School	1	116B	Servery 100B	No	No	FL	VSF	1	N/D	-	-	V/C:14152-46-08	-	-	-	-	-	-
77801	Bracebridge & Muskoka Lakes Secondary School	1	116B	Servery 100B	No	No	CL	CT	1	N/D	-	-	V/C:14152-46-05	-	-	-	-	-	-
77802	Bracebridge & Muskoka Lakes Secondary School	1	116C	Washroom 100C	No	No	FL	VSF	1	N/D	-	-	V/C:14152-46-08	-	-	-	-	-	-
77803	Bracebridge & Muskoka Lakes Secondary School	1	116C	Washroom 100C	No	No	CL	CT	1	N/D	-	-	V/C:14152-46-05	-	-	-	-	-	-
77804	Bracebridge & Muskoka Lakes Secondary School	1	116D	Office 100D	No	No	FL	VSF	1	N/D	-	-	14152-46-08C	-	-	-	-	-	-
77805	Bracebridge & Muskoka Lakes Secondary School	1	116D	Office 100D	No	No	CL	CT	1	N/D	-	-	V/C:14152-46-05	-	-	-	-	-	-
77806	Bracebridge & Muskoka Lakes Secondary School	1	116E	Room 100E	No	No	FL	VSF	1	N/D	-	-	V/C:14152-46-08	-	-	-	-	-	-
77807	Bracebridge & Muskoka Lakes Secondary School	1	116E	Room 100E	No	No	CL	CT	1	N/D	-	-	V/C:14152-46-05	-	-	-	-	-	-
77808	Bracebridge & Muskoka Lakes Secondary School	1	116F	Servery 100F	No	No	FL	VSF	1	N/D	-	-	V/C:14152-46-08	-	-	-	-	-	-
77809	Bracebridge & Muskoka Lakes Secondary School	1	116F	Servery 100F	No	No	CL	CT	1	N/D	-	-	V/C:14152-46-05	-	-	-	-	-	-
77700	Bracebridge & Muskoka Lakes Secondary School	1	118	Fitness Room 101	No	No	CL	CT	1	N/D	-	-	V/C:14152-46-05	-	-	-	-	-	-
77701	Bracebridge & Muskoka Lakes Secondary School	1	118	Fitness Room 101	No	No	WL	DJC	3	N/D	-	-	V/C:14152-46-03	-	-	-	-	-	-
77702	Bracebridge & Muskoka Lakes Secondary School	1	118A	Storage Room 101A	No	-	-	-	-	-	-	-	-	-	-	-	-	-	No ACM or presumed ACM material
77703	Bracebridge & Muskoka Lakes Secondary School	1	118B	Storage Room 101B	No	-	-	-	-	-	-	-	-	-	-	-	-	-	No ACM or presumed ACM material
77704	Bracebridge & Muskoka Lakes Secondary School	1	119	Exterior Electrical Room	No	-	-	-	-	-	-	-	-	-	-	-	-	-	No ACM or presumed ACM material
77705	Bracebridge & Muskoka Lakes Secondary School	1	120A	GYM A-C and GYM Storage	Yes	No	WL	TP	NA	ACM Assumed	-	G	-	-	C	-	-	-	Transite Pipe presumed asbestos
77706	Bracebridge & Muskoka Lakes Secondary School	1	120B	GYM A-C and GYM Storage	Yes	No	WL	TP	NA	ACM Assumed	-	G	-	-	C	-	-	-	Transite Pipe presumed asbestos
77707	Bracebridge & Muskoka Lakes Secondary School	1	120C	GYM A-C and GYM Storage	Yes	No	WL	TP	NA	ACM Assumed	-	G	-	-	C	-	-	-	Transite Pipe presumed asbestos
77708	Bracebridge & Muskoka Lakes Secondary School	1	120D	GYM A-C and GYM Storage	Yes	No	WL	TP	NA	ACM Assumed	-	G	-	-	C	-	-	-	Transite Pipe presumed asbestos
77732	Bracebridge & Muskoka Lakes Secondary School	1	120E	Gym Storage 109A	No	-	-	-	-	-	-	-	-	-	-	-	-	-	No ACM or presumed ACM material
77735	Bracebridge & Muskoka Lakes Secondary School	1	122	Custodial Room 107	No	-	-	-	-	-	-	-	-	-	-	-	-	-	No ACM or presumed ACM material
77736	Bracebridge & Muskoka Lakes Secondary School	1	123	Boys & Girls Washroom	No	No	CL	DJC	4	N/D	-	-	V/C:14152-46-04	-	-	-	-	-	-
77729	Bracebridge & Muskoka Lakes Secondary School	1	124	Boys Changeroom 127	No	No	FL	VFT	1	N/D	-	-	V/C:14152-46-06	-	-	-	-	-	-
77730	Bracebridge & Muskoka Lakes Secondary School	1	124	Boys Changeroom 127	No	No	CL	CT	1	N/D	-	-	V/C:14152-46-05	-	-	-	-	-	Bathroom section had drywall ceiling



STRUCTURAL ELEMENT

RF: Roof
WN: Window
FL: Floor
CL: Ceiling
WL: Wall
DK: Deck

B/J: Beams/Joists
CB: Chalkboard
PI: Pipe
DT: Duct
BL: Boiler
MC: Mechanical

ACCESSIBILITY

A: All occupants of the facility
B: Maintenance staff without a ladder
C: Maintenance staff with a ladder, exposed to view without moving building components
D: Maintenance staff with a ladder, concealed from view by building components

TERMINOLOGY

ACM: Asbestos Containing Material
CT: Ceiling Tile
DJC: Drywall Joint Compound
FTG: Fitting
LF: Linear Feet

N/A: Not Applicable
N/Anz: Not Analyzed
N/D: None Detected
PI-AC: Pipe Insulation - Aircell
PI-PC: Pipe Insulation-Parging Cement
PI-CP: Pipe Insulation-Caposite

PL: Plaster
RM: Roofing Materials
SFP: Sprayed Fireproofing
SF: Square Feet
TF: Texture Finish

TB: Transite Board
TP: Transite Pipe
VI: Vermiculite Insulation
VFT: Vinyl Floor Tile

VSF: Vinyl Sheet Flooring
V/C: Visually Consistent w/ Other Sampled Material
WC: Window Caulking

E: No access without demolition or removal of fixed building components or systems

CONDITION G: Good F: Fair P: Poor

ID	Facility	Floor #	Room #	Room name	Has ACM	Friable	Struct. Elem.	Application	Material	Type	Qty	Condition	Sample #	Action	Ref #	Comments 1	Comments 2	Comments 3	Notes
77731	Bracebridge & Muskoka Lakes Secondary School	1	124	Boys Changeroom 127	No	No	CL	DJC	4	N/D	-	-	V/C:14152-46-04	-	-	-	-	-	-
77726	Bracebridge & Muskoka Lakes Secondary School	1	125	Girls Changeroom 123	No	No	FL	VFT	1	N/D	-	-	V/C:14152-46-06	-	-	-	-	-	-
77727	Bracebridge & Muskoka Lakes Secondary School	1	125	Girls Changeroom 123	No	No	CL	CT	1	N/D	-	-	V/C:14152-46-05	-	-	-	-	-	Bathroom section had drywall ceiling
77728	Bracebridge & Muskoka Lakes Secondary School	1	125	Girls Changeroom 123	No	No	CL	DJC	4	N/D	-	-	V/C:14152-46-04	-	-	-	-	-	-
77717	Bracebridge & Muskoka Lakes Secondary School	1	126	Gym Office 121	No	No	FL	VFT	1	N/D	-	-	V/C:14152-46-06	-	-	-	-	-	-
77718	Bracebridge & Muskoka Lakes Secondary School	1	126	Gym Office 121	No	No	CL	CT	1	N/D	-	-	V/C:14152-46-05	-	-	-	-	-	-
77719	Bracebridge & Muskoka Lakes Secondary School	1	126A	Male Staff Washroom 121A	No	No	FL	VFT	1	N/D	-	-	V/C:14152-46-06	-	-	-	-	-	-
77720	Bracebridge & Muskoka Lakes Secondary School	1	126A	Male Staff Washroom 121A	No	No	CL	CT	1	N/D	-	-	V/C:14152-46-05	-	-	-	-	-	Bathroom section had drywall ceiling
77721	Bracebridge & Muskoka Lakes Secondary School	1	126A	Male Staff Washroom 121A	No	No	CL	DJC	4	N/D	-	-	V/C:14152-46-04	-	-	-	-	-	-
77722	Bracebridge & Muskoka Lakes Secondary School	1	126B	Female Staff Washroom 121B	No	No	FL	VFT	1	N/D	-	-	V/C:14152-46-06	-	-	-	-	-	-
77723	Bracebridge & Muskoka Lakes Secondary School	1	126B	Female Staff Washroom 121B	No	No	CL	CT	1	N/D	-	-	V/C:14152-46-05	-	-	-	-	-	Bathroom section had drywall ceiling
77724	Bracebridge & Muskoka Lakes Secondary School	1	126B	Female Staff Washroom 121B	No	No	CL	DJC	4	N/D	-	-	V/C:14152-46-04	-	-	-	-	-	-
77725	Bracebridge & Muskoka Lakes Secondary School	1	126B	Female Staff Washroom 121B	No	No	BH	DJC	2	N/D	-	-	14152-46-02A, B, C	-	-	-	-	-	-
77714	Bracebridge & Muskoka Lakes Secondary School	1	127	Boys Changeroom 119	No	No	FL	VFT	1	N/D	-	-	V/C:14152-46-06	-	-	-	-	-	-
77715	Bracebridge & Muskoka Lakes Secondary School	1	127	Boys Changeroom 119	No	No	CL	CT	1	N/D	-	-	V/C:14152-46-05	-	-	-	-	-	Bathroom section had drywall ceiling
77716	Bracebridge & Muskoka Lakes Secondary School	1	127	Boys Changeroom 119	No	No	CL	DJC	4	N/D	-	-	V/C:14152-46-04	-	-	-	-	-	-
77709	Bracebridge & Muskoka Lakes Secondary School	1	128	Girls Changeroom 117	No	No	FL	VFT	1	N/D	-	-	V/C:14152-46-06	-	-	-	-	-	-
77710	Bracebridge & Muskoka Lakes Secondary School	1	128	Girls Changeroom 117	No	No	CL	CT	1	N/D	-	-	V/C:14152-46-05	-	-	-	-	-	-
77711	Bracebridge & Muskoka Lakes Secondary School	1	128	Girls Changeroom 117	No	No	CL	DJC	4	N/D	-	-	V/C:14152-46-04	-	-	-	-	-	-
77712	Bracebridge & Muskoka Lakes Secondary School	1	129	Female Staff Washroom 115	No	No	CL	CT	1	N/D	-	-	V/C:14152-46-05	-	-	-	-	-	-
77713	Bracebridge & Muskoka Lakes Secondary School	1	129	Female Staff Washroom 115	No	No	BH	DJC	1	N/D	-	-	V/C:14152-46-01	-	-	-	-	-	-
77733	Bracebridge & Muskoka Lakes Secondary School	1	132	Elevator "A"	No	-	-	-	-	-	-	-	-	-	-	-	-	-	No ACM or presumed ACM material
77734	Bracebridge & Muskoka Lakes Secondary School	1	133	Elevator Machine Room 129	No	No	CL	CT	1	N/D	-	-	V/C:14152-46-05	-	-	-	-	-	-
77697	Bracebridge & Muskoka Lakes Secondary School	1	134	Corridor "1B"	No	No	CL	CT	1	N/D	-	-	V/C:14152-46-05	-	-	-	-	-	-
77698	Bracebridge & Muskoka Lakes Secondary School	1	134	Corridor "1B"	No	No	CL	DJC	4	N/D	-	-	V/C:14152-46-04	-	-	-	-	-	Ceiling has C access Drywall/DJC
77737	Bracebridge & Muskoka Lakes Secondary School	1	135	Library 131	No	No	WL	DJC	3	N/D	-	-	V/C:14152-46-03	-	-	-	-	-	-
77738	Bracebridge & Muskoka Lakes Secondary School	1	135	Library 131	No	No	CL	DJC	4	N/D	-	-	14152-46-04F	-	-	-	-	-	-
77739	Bracebridge & Muskoka Lakes Secondary School	1	135A	Data Closet 131A	No	-	-	-	-	-	-	-	-	-	-	-	-	-	No ACM or presumed ACM material
77740	Bracebridge & Muskoka Lakes Secondary School	1	135B	Electrical Room 131B	No	-	-	-	-	-	-	-	-	-	-	-	-	-	No ACM or presumed ACM material
77741	Bracebridge & Muskoka Lakes Secondary School	1	137	Room 133	No	No	CL	CT	1	N/D	-	-	V/C:14152-46-05	-	-	-	-	-	-
77742	Bracebridge & Muskoka Lakes Secondary School	1	137	Special Ed Office 135	No	No	FL	VFT	1	N/D	-	-	V/C:14152-46-06	-	-	-	-	-	-
77743	Bracebridge & Muskoka Lakes Secondary School	1	137	Special Ed Office 135	No	No	CL	CT	1	N/D	-	-	V/C:14152-46-05	-	-	-	-	-	-
77744	Bracebridge & Muskoka Lakes Secondary School	1	138	Staff Room 137	No	No	FL	VFT	1	N/D	-	-	V/C:14152-46-06	-	-	-	-	-	-
77745	Bracebridge & Muskoka Lakes Secondary School	1	138	Staff Room 137	No	No	CL	CT	1	N/D	-	-	V/C:14152-46-05	-	-	-	-	-	-
77746	Bracebridge & Muskoka Lakes Secondary School	1	138B	Washroom 137B & C	No	No	CL	CT	1	N/D	-	-	V/C:14152-46-05	-	-	-	-	-	-
77748	Bracebridge & Muskoka Lakes Secondary School	1	138B	Washroom 137B & C	No	No	BH	DJC	1	N/D	-	-	V/C:14152-46-01	-	-	-	-	-	-
77747	Bracebridge & Muskoka Lakes Secondary School	1	138C	Washroom 137B & C	No	No	CL	CT	1	N/D	-	-	V/C:14152-46-05	-	-	-	-	-	-
77749	Bracebridge & Muskoka Lakes Secondary School	1	138C	Washroom 137B & C	No	No	BH	DJC	1	N/D	-	-	V/C:14152-46-01	-	-	-	-	-	-
77792	Bracebridge & Muskoka Lakes Secondary School	1	139	Stairwell 1	No	No	CL	DJC	4	N/D	-	-	14152-46-04E	-	-	-	-	-	-
77683	Bracebridge & Muskoka Lakes Secondary School	1	141	Music 166	No	No	FL	VFT	1	N/D	-	-	14152-46-06B	-	-	-	-	-	-
77684	Bracebridge & Muskoka Lakes Secondary School	1	141	Music 166	No	No	CL	CT	1	N/D	-	-	V/C:14152-46-05	-	-	-	-	-	-
77685	Bracebridge & Muskoka Lakes Secondary School	1	141	Music 166	No	No	CL	DJC	4	N/D	-	-	V/C:14152-46-04	-	-	-	-	-	Ceiling has C access Drywall/DJC
77686	Bracebridge & Muskoka Lakes Secondary School	1	141A	Rehearsal Room 166A	No	No	FL	VFT	1	N/D	-	-	V/C:14152-46-06	-	-	-	-	-	-
77687	Bracebridge & Muskoka Lakes Secondary School	1	141A	Rehearsal Room 166A	No	No	CL	CT	1	N/D	-	-	V/C:14152-46-05	-	-	-	-	-	-
77688	Bracebridge & Muskoka Lakes Secondary School	1	141B	Office 166B	No	No	FL	VFT	1	N/D	-	-	V/C:14152-46-06	-	-	-	-	-	-
77689	Bracebridge & Muskoka Lakes Secondary School	1	141B	Office 166B	No	No	CL	CT	1	N/D	-	-	V/C:14152-46-05	-	-	-	-	-	-
77690	Bracebridge & Muskoka Lakes Secondary School	1	141C	Rehearsal Room 166C	No	No	FL	VFT	1	N/D	-	-	V/C:14152-46-06	-	-	-	-	-	-
77691	Bracebridge & Muskoka Lakes Secondary School	1	141C	Rehearsal Room 166C	No	No	CL	CT	1	N/D	-	-	V/C:14152-46-05	-	-	-	-	-	-
77692	Bracebridge & Muskoka Lakes Secondary School	1	141D	Rehearsal Room 166D	No	No	FL	VFT	1	N/D	-	-	V/C:14152-46-06	-	-	-	-	-	-
77693	Bracebridge & Muskoka Lakes Secondary School	1	141D	Rehearsal Room 166D	No	No	CL	CT	1	N/D	-	-	V/C:14152-46-05	-	-	-	-	-	-
77676	Bracebridge & Muskoka Lakes Secondary School	1	142	Room 164	No	No	FL	VFT	1	N/D	-	-	V/C:14152-46-06	-	-	-	-	-	-
77677	Bracebridge & Muskoka Lakes Secondary School	1	142	Room 164	No	No	CL	CT	1	N/D	-	-	V/C:14152-46-05	-	-	-	-	-	-
77678	Bracebridge & Muskoka Lakes Secondary School	1	142	Room 164	No	No	BH	DJC	1	N/D	-	-	V/C:14152-46-01	-	-	-	-	-	-
77679	Bracebridge & Muskoka Lakes Secondary School	1	142A	Rehearsal Room 164A	No	No	FL	VFT	1	N/D	-	-	V/C:14152-46-06	-	-	-	-	-	-
77680	Bracebridge & Muskoka Lakes Secondary School	1	142A	Rehearsal Room 164A	No	No	CL	CT	1	N/D	-	-	V/C:14152-46-05	-	-	-	-	-	-
77681	Bracebridge & Muskoka Lakes Secondary School	1	142B	Rehearsal Room 164B	No	No	FL	VFT	1	N/D	-	-	V/C:14152-46-06	-	-	-	-	-	-
77682	Bracebridge & Muskoka Lakes Secondary School	1	142B	Rehearsal Room 164B	No	No	CL	CT	1	N/D	-	-	V/C:14152-46-05	-	-	-	-	-	-
77673	Bracebridge & Muskoka Lakes Secondary School	1	143	Room 162	No	No	FL	VFT	1	N/D	-	-	V/C:14152-46-06	-	-	-	-	-	-
77674	Bracebridge & Muskoka Lakes Secondary School	1	143	Room 162	No	No	CL	CT	1	N/D	-	-	V/C:14152-46-05	-	-	-	-	-	-
77675	Bracebridge & Muskoka Lakes Secondary School	1	143	Room 162	No	No	BH	DJC	1	N/D	-	-	V/C:14152-46-01	-	-	-	-	-	-
77662	Bracebridge & Muskoka Lakes Secondary School	1	144	Family Studies 160	No	No	FL	VFT	1	N/D	-	-	V/C:14152-46-06	-	-	-	-	-	-
77663	Bracebridge & Muskoka Lakes Secondary School	1	144	Family Studies 160	No	No	CL	CT	1	N/D	-	-	V/C:14152-46-05	-	-	-	-	-	-
77664	Bracebridge & Muskoka Lakes Secondary School	1	144A	Storage Room 160A	No	No	FL	VFT	1	N/D	-	-	V/C:14152-46-06	-	-	-	-	-	-
77665	Bracebridge & Muskoka Lakes Secondary School	1	144A	Storage Room 160A	No	No	CL	CT	1	N/D	-	-	V/C:14152-46-05	-	-	-	-	-	-
77659	Bracebridge & Muskoka Lakes Secondary School	1	145	Family Studies 158	No	No	FL	VFT	1	N/D	-	-	V/C:14152-46-06	-	-	-	-	-	-
77660	Bracebridge & Muskoka Lakes Secondary School	1	145	Family Studies 158	No	No	CL	DJC	4	N/D	-	-	V/C:14152-46-04	-	-	-	-	-	First part of location was CTs
77661	Bracebridge & Muskoka Lakes Secondary School	1	145	Family Studies 158	No	No	CL	CT	1	N/D	-	-	V/C:14152-46-05	-	-	-	-	-	-
77635	Bracebridge & Muskoka Lakes Secondary School	1	146	Stairwell 4	No	No	CL	DJC	4	N/D	-	-	14152-46-04B	-	-	-	-	-	-
77628	Bracebridge & Muskoka Lakes Secondary School	1	147	Construction 156	Yes	No	WL	TP	NA	ACM Assumed	50 LF	G	-	-	C	-	-	-	Transite Pipe presumed asbestos
77629	Bracebridge & Muskoka Lakes Secondary School	1	147	Construction 156	No	No	CL	CT	1	N/D	-	-	14152-46-05A	-	-	-	-	-	-



STRUCTURAL ELEMENT

RF: Roof B/J: Beams/Joists
 WN: Window CB: Chalkboard
 FL: Floor PI: Pipe
 CL: Ceiling DT: Duct
 WL: Wall BL: Boiler
 DK: Deck MC: Mechanical

ACCESSIBILITY

A: All occupants of the facility
 B: Maintenance staff without a ladder
 C: Maintenance staff with a ladder, exposed to view without moving building components
 D: Maintenance staff with a ladder, concealed from view by building components

TERMINOLOGY

ACM: Asbestos Containing Material N/A: Not Applicable
 CT: Ceiling Tile N/Anz: Not Analyzed
 DJC: Drywall Joint Compound N/D: None Detected
 FTG: Fitting PI-AC: Pipe Insulation - Aircell
 LF: Linear Feet PI-PC: Pipe Insulation-Parqing Cement
 PI-CP: Pipe Insulation-Caposite

PL: Plaster
 RM: Roofing Materials
 SFP: Sprayed Fireproofing
 SF: Square Feet
 TF: Texture Finish

TB: Transite Board
 TP: Transite Pipe
 VI: Vermiculite Insulation
 VFT: Vinyl Floor Tile

VSF: Vinyl Sheet Flooring
 V/C: Visually Consistent w/ Other Sampled Material
 WC: Window Caulking

E: No access without demolition or removal of fixed building components or systems

CONDITION G: Good F: Fair P: Poor

ID	Facility	Floor #	Room #	Room name	Has ACM	Friable	Struct. Elem.	Application	Material	Type	Qty	Condition	Sample #	Action	Ref #	Comments 1	Comments 2	Comments 3	Notes
77626	Bracebridge & Muskoka Lakes Secondary School	1	148	Production 154	No	No	CL	CT	1	N/D	-	-	V/C:14152-46-05	-	-	-	-	-	-
77997	Bracebridge & Muskoka Lakes Secondary School	1	148	SHOP	Yes	No	WL	TP	NA	ACM Assumed	50 LF	G	-	-	-	-	-	-	C
77627	Bracebridge & Muskoka Lakes Secondary School	1	148C	Storage Room 154C	No	-	-	-	-	-	-	-	-	-	-	-	-	-	-
77694	Bracebridge & Muskoka Lakes Secondary School	1	149	Corridor "1A"	No	No	CL	CT	1	N/D	-	-	V/C:14152-46-05	-	-	-	-	-	No ACM or presumed ACM material
77695	Bracebridge & Muskoka Lakes Secondary School	1	149	Corridor "1A"	No	No	CL	DJC	4	N/D	-	-	V/C:14152-46-04	-	-	-	-	-	Ceiling has C access Drywall/DJC
77621	Bracebridge & Muskoka Lakes Secondary School	1	150	Manufacturing 152	Yes	No	WL	TP	NA	ACM Assumed	50 LF	G	-	-	-	-	-	-	C
77622	Bracebridge & Muskoka Lakes Secondary School	1	150	Manufacturing 152	No	No	CL	CT	1	N/D	-	-	V/C:14152-46-05	-	-	-	-	-	Transite Pipe presumed asbestos
77623	Bracebridge & Muskoka Lakes Secondary School	1	150A	Storage Room 152A	No	-	-	-	-	-	-	-	-	-	-	-	-	-	-
77624	Bracebridge & Muskoka Lakes Secondary School	1	150B	Wood Storage Room 152E	No	No	CL	CT	1	N/D	-	-	V/C:14152-46-05	-	-	-	-	-	No ACM or presumed ACM material
77625	Bracebridge & Muskoka Lakes Secondary School	1	150C	Workroom 152F	No	No	CL	CT	1	N/D	-	-	V/C:14152-46-05	-	-	-	-	-	-
77617	Bracebridge & Muskoka Lakes Secondary School	1	151	Transportation 150	Yes	No	WL	TP	NA	ACM Assumed	50 LF	G	-	-	-	-	-	-	C
77618	Bracebridge & Muskoka Lakes Secondary School	1	151	Transportation 150	No	No	CL	CT	1	N/D	-	-	V/C:14152-46-05	-	-	-	-	-	Transite Pipe presumed asbestos
77619	Bracebridge & Muskoka Lakes Secondary School	1	151A	Welding Room 150A	No	-	-	-	-	-	-	-	-	-	-	-	-	-	-
77620	Bracebridge & Muskoka Lakes Secondary School	1	151B	Compressor Room 150B	No	-	-	-	-	-	-	-	-	-	-	-	-	-	-
77612	Bracebridge & Muskoka Lakes Secondary School	1	152	Electrical Room 148	No	-	-	-	-	-	-	-	-	-	-	-	-	-	-
77611	Bracebridge & Muskoka Lakes Secondary School	1	153	Data Closet 146	No	-	-	-	-	-	-	-	-	-	-	-	-	-	-
77609	Bracebridge & Muskoka Lakes Secondary School	1	154	Custodial Office Corridor 144	No	No	FL	VFT	1	N/D	-	-	V/C:14152-46-06	-	-	-	-	-	-
77610	Bracebridge & Muskoka Lakes Secondary School	1	154	Custodial Office Corridor 144	No	No	CL	CT	1	N/D	-	-	V/C:14152-46-05	-	-	-	-	-	-
77607	Bracebridge & Muskoka Lakes Secondary School	1	154A	Custodial Office 144A	No	No	FL	VFT	1	N/D	-	-	V/C:14152-46-06	-	-	-	-	-	-
77608	Bracebridge & Muskoka Lakes Secondary School	1	154A	Custodial Office 144A	No	No	CL	CT	1	N/D	-	-	V/C:14152-46-05	-	-	-	-	-	-
77600	Bracebridge & Muskoka Lakes Secondary School	1	154B	Receiving Room 144B	No	-	-	-	-	-	-	-	-	-	-	-	-	-	-
77602	Bracebridge & Muskoka Lakes Secondary School	1	154C	Garage 144C	No	-	-	-	-	-	-	-	-	-	-	-	-	-	-
77601	Bracebridge & Muskoka Lakes Secondary School	1	154D	Storage 144D	No	-	-	-	-	-	-	-	-	-	-	-	-	-	-
77598	Bracebridge & Muskoka Lakes Secondary School	1	154E	Staff Lunch Room 144E	No	No	FL	VFT	1	N/D	-	-	14152-46-06A	-	-	-	-	-	-
77599	Bracebridge & Muskoka Lakes Secondary School	1	154E	Staff Lunch Room 144E	No	No	CL	CT	1	N/D	-	-	V/C:14152-46-05	-	-	-	-	-	-
77603	Bracebridge & Muskoka Lakes Secondary School	1	154F	Female Washroom 144F	No	No	FL	VFT	1	N/D	-	-	V/C:14152-46-06	-	-	-	-	-	-
77604	Bracebridge & Muskoka Lakes Secondary School	1	154F	Female Washroom 144F	No	No	CL	CT	1	N/D	-	-	V/C:14152-46-05	-	-	-	-	-	-
77605	Bracebridge & Muskoka Lakes Secondary School	1	154G	Male Washroom 144G	No	No	FL	VFT	1	N/D	-	-	V/C:14152-46-06	-	-	-	-	-	-
77606	Bracebridge & Muskoka Lakes Secondary School	1	154G	Male Washroom 144G	No	No	CL	CT	1	N/D	-	-	V/C:14152-46-05	-	-	-	-	-	-
77613	Bracebridge & Muskoka Lakes Secondary School	1	155	Stairwell 3	No	No	CL	DJC	4	N/D	-	-	14152-46-04A	-	-	-	-	-	-
77636	Bracebridge & Muskoka Lakes Secondary School	1	157	Room 142	No	No	FL	VFT	1	N/D	-	-	V/C:14152-46-06	-	-	-	-	-	-
77637	Bracebridge & Muskoka Lakes Secondary School	1	157	Room 142	No	No	WL	DJC	3	N/D	-	-	V/C:14152-46-03	-	-	-	-	-	-
77638	Bracebridge & Muskoka Lakes Secondary School	1	157	Room 142	No	No	CL	CT	1	N/D	-	-	V/C:14152-46-05	-	-	-	-	-	-
77639	Bracebridge & Muskoka Lakes Secondary School	1	158	Room 140	No	No	FL	VFT	1	N/D	-	-	V/C:14152-46-06	-	-	-	-	-	-
77640	Bracebridge & Muskoka Lakes Secondary School	1	158	Room 140	No	No	CL	CT	1	N/D	-	-	V/C:14152-46-05	-	-	-	-	-	-
77641	Bracebridge & Muskoka Lakes Secondary School	1	159	Room 138	No	No	FL	VFT	1	N/D	-	-	V/C:14152-46-06	-	-	-	-	-	-
77642	Bracebridge & Muskoka Lakes Secondary School	1	159	Room 138	No	No	CL	CT	1	N/D	-	-	V/C:14152-46-05	-	-	-	-	-	-
77643	Bracebridge & Muskoka Lakes Secondary School	1	160	Room 136	No	No	FL	VFT	1	N/D	-	-	V/C:14152-46-06	-	-	-	-	-	-
77644	Bracebridge & Muskoka Lakes Secondary School	1	160	Room 136	No	No	CL	CT	1	N/D	-	-	V/C:14152-46-05	-	-	-	-	-	-
77645	Bracebridge & Muskoka Lakes Secondary School	1	161	Room 134	No	No	FL	VFT	1	N/D	-	-	V/C:14152-46-06	-	-	-	-	-	-
77646	Bracebridge & Muskoka Lakes Secondary School	1	161	Room 134	No	No	CL	CT	1	N/D	-	-	V/C:14152-46-05	-	-	-	-	-	-
77647	Bracebridge & Muskoka Lakes Secondary School	1	162	Room 132	No	No	FL	VFT	1	N/D	-	-	V/C:14152-46-06	-	-	-	-	-	-
77648	Bracebridge & Muskoka Lakes Secondary School	1	162	Room 132	No	No	CL	CT	1	N/D	-	-	V/C:14152-46-05	-	-	-	-	-	-
77649	Bracebridge & Muskoka Lakes Secondary School	1	163	Staff Room 139	No	No	FL	VFT	1	N/D	-	-	V/C:14152-46-06	-	-	-	-	-	-
77650	Bracebridge & Muskoka Lakes Secondary School	1	163	Staff Room 139	No	No	CL	CT	1	N/D	-	-	V/C:14152-46-05	-	-	-	-	-	-
77651	Bracebridge & Muskoka Lakes Secondary School	1	164	Male Staff Washroom 141	No	No	CL	CT	1	N/D	-	-	V/C:14152-46-05	-	-	-	-	-	-
77652	Bracebridge & Muskoka Lakes Secondary School	1	164	Male Staff Washroom 141	No	No	BH	DJC	1	N/D	-	-	V/C:14152-46-01	-	-	-	-	-	-
77653	Bracebridge & Muskoka Lakes Secondary School	1	165	Boys & Girls Washroom	No	No	CL	CT	1	N/D	-	-	V/C:14152-46-05	-	-	-	-	-	-
77655	Bracebridge & Muskoka Lakes Secondary School	1	165	Boys & Girls Washroom	No	No	CL	DJC	4	N/D	-	-	V/C:14152-46-04	-	-	-	-	-	First part of WR has drywall ceiling
77657	Bracebridge & Muskoka Lakes Secondary School	1	165	Boys & Girls Washroom	No	No	BH	DJC	1	N/D	-	-	V/C:14152-46-01	-	-	-	-	-	-
77654	Bracebridge & Muskoka Lakes Secondary School	1	166	Boys & Girls Washroom	No	No	CL	CT	1	N/D	-	-	V/C:14152-46-05	-	-	-	-	-	-
77656	Bracebridge & Muskoka Lakes Secondary School	1	166	Boys & Girls Washroom	No	No	CL	DJC	4	N/D	-	-	V/C:14152-46-04	-	-	-	-	-	First part of WR has drywall ceiling
77658	Bracebridge & Muskoka Lakes Secondary School	1	166	Boys & Girls Washroom	No	No	BH	DJC	1	N/D	-	-	V/C:14152-46-01	-	-	-	-	-	-
77614	Bracebridge & Muskoka Lakes Secondary School	1	167	CADD Lab 147	No	No	FL	VFT	2	N/D	-	-	14152-46-07A	-	-	-	-	-	-
77615	Bracebridge & Muskoka Lakes Secondary School	1	167	CADD Lab 147	No	No	CL	CT	1	N/D	-	-	V/C:14152-46-05	-	-	-	-	-	-
77616	Bracebridge & Muskoka Lakes Secondary School	1	167	CADD Lab 147	No	No	BH	DJC	1	N/D	-	-	V/C:14152-46-01	-	-	-	-	-	-
77630	Bracebridge & Muskoka Lakes Secondary School	1	168	Communications 149	No	No	FL	VFT	2	N/D	-	-	14152-46-07B	-	-	-	-	-	-
77631	Bracebridge & Muskoka Lakes Secondary School	1	168	Communications 149	No	No	CL	CT	1	N/D	-	-	V/C:14152-46-05	-	-	-	-	-	-
77632	Bracebridge & Muskoka Lakes Secondary School	1	168	Communications 149	No	No	BH	DJC	1	N/D	-	-	14152-46-01A	-	-	-	-	-	-
77633	Bracebridge & Muskoka Lakes Secondary School	1	168A	Storage Room 149A	No	No	FL	VFT	2	N/D	-	-	V/C:14152-46-07	-	-	-	-	-	-
77634	Bracebridge & Muskoka Lakes Secondary School	1	169	Storage Room 151	No	No	FL	VFT	1	N/D	-	-	V/C:14152-46-06	-	-	-	-	-	-
77666	Bracebridge & Muskoka Lakes Secondary School	1	170	Visual Arts 153	No	No	FL	VFT	1	N/D	-	-	V/C:14152-46-06	-	-	-	-	-	-
77667	Bracebridge & Muskoka Lakes Secondary School	1	170	Visual Arts 153	No	No	CL	CT	1	N/D	-	-	V/C:14152-46-05	-	-	-	-	-	-
77668	Bracebridge & Muskoka Lakes Secondary School	1	170	Visual Arts 153	No	No	BH	DJC	1	N/D	-	-	14152-46-01B	-	-	-	-	-	-
77669	Bracebridge & Muskoka Lakes Secondary School	1	170A	Klin 153A	No	No	CL	CT	1	N/D	-	-	V/C:14152-46-05	-	-	-	-	-	-
77670	Bracebridge & Muskoka Lakes Secondary School	1	170B	Storage Room 153B	No	-	-	-	-	-	-	-	-	-	-	-	-	-	-
77671	Bracebridge & Muskoka Lakes Secondary School	1	171	Visual Arts 159	No	No	FL	VFT	1	N/D	-	-	V/C:14152-46-06	-	-	-	-	-	No ACM or presumed ACM material
77672	Bracebridge & Muskoka Lakes Secondary School	1	171</																



STRUCTURAL ELEMENT RF: Roof WN: Window FL: Floor CL: Ceiling WL: Wall DK: Deck	B/J: Beams/Joists CB: Chalkboard PI: Pipe DT: Duct BL: Boiler MC: Mechanical	ACCESSIBILITY A: All occupants of the facility B: Maintenance staff without a ladder C: Maintenance staff with a ladder, exposed to view without moving building components D: Maintenance staff with a ladder, concealed from view by building components	TERMINOLOGY ACM: Asbestos Containing Material CT: Ceiling Tile DJC: Drywall Joint Compound FTG: Fitting LF: Linear Feet	N/A: Not Applicable N/Anz: Not Analyzed N/D: None Detected PI-AC: Pipe Insulation - Aircell PI-PC: Pipe Insulation-Parging Cement PI-CP: Pipe Insulation-Caposite	PL: Plaster RM: Roofing Materials SFP: Sprayed Fireproofing SF: Square Feet TF: Texture Finish	TB: Transite Board TP: Transite Pipe VI: Vermiculite Insulation VFT: Vinyl Floor Tile	VSF: Vinyl Sheet Flooring V/C: Visually Consistent w/ Other Sampled Material WC: Window Caulking
		E: No access without demolition or removal of fixed building components or systems	CONDITION G: Good F: Fair P: Poor				

ID	Facility	Floor #	Room #	Room name	Has ACM	Friable	Struct. Elem.	Application	Material	Type	Qty	Condition	Sample #	Action	Ref #	Comments 1	Comments 2	Comments 3	Notes
77751	Bracebridge & Muskoka Lakes Secondary School	1	174	Room 130	No	No	WL	DJC	3	N/D	-	-	V/C:14152-46-03	-	-	-	-	-	-
77752	Bracebridge & Muskoka Lakes Secondary School	1	174	Room 130	No	No	CL	CT	1	N/D	-	-	V/C:14152-46-05	-	-	-	-	-	-
77753	Bracebridge & Muskoka Lakes Secondary School	1	175	Room 128	No	No	FL	VFT	1	N/D	-	-	V/C:14152-46-06	-	-	-	-	-	-
77754	Bracebridge & Muskoka Lakes Secondary School	1	175	Room 128	No	No	CL	CT	1	N/D	-	-	V/C:14152-46-05	-	-	-	-	-	-
77755	Bracebridge & Muskoka Lakes Secondary School	1	176	Special Ed Office 126	No	No	FL	VFT	1	N/D	-	-	V/C:14152-46-06	-	-	-	-	-	-
77756	Bracebridge & Muskoka Lakes Secondary School	1	176	Special Ed Office 126	No	No	CL	CT	1	N/D	-	-	V/C:14152-46-05	-	-	-	-	-	-
77757	Bracebridge & Muskoka Lakes Secondary School	1	176A	Handicap Washroom 126A	No	No	CL	DJC	4	N/D	-	-	14152-46-04D	-	-	-	-	-	-
77758	Bracebridge & Muskoka Lakes Secondary School	1	177	Room 124	No	No	FL	VFT	1	N/D	-	-	V/C:14152-46-06	-	-	-	-	-	-
77759	Bracebridge & Muskoka Lakes Secondary School	1	177	Room 124	No	No	CL	CT	1	N/D	-	-	V/C:14152-46-05	-	-	-	-	-	-
77760	Bracebridge & Muskoka Lakes Secondary School	1	177A	Computer Room 124A	No	No	FL	VFT	2	N/D	-	-	V/C:14152-46-07	-	-	-	-	-	-
77761	Bracebridge & Muskoka Lakes Secondary School	1	177A	Computer Room 124A	No	No	CL	CT	1	N/D	-	-	V/C:14152-46-05	-	-	-	-	-	-
77762	Bracebridge & Muskoka Lakes Secondary School	1	178	Student Services 122	No	No	FL	VFT	1	N/D	-	-	V/C:14152-46-06	-	-	-	-	-	-
77763	Bracebridge & Muskoka Lakes Secondary School	1	178	Student Services 122	No	No	WL	DJC	3	N/D	-	-	V/C:14152-46-03	-	-	-	-	-	-
77764	Bracebridge & Muskoka Lakes Secondary School	1	178	Student Services 122	No	No	CL	CT	1	N/D	-	-	V/C:14152-46-05	-	-	-	-	-	-
77765	Bracebridge & Muskoka Lakes Secondary School	1	178A	Student Success Office 122A	No	No	WL	DJC	3	N/D	-	-	V/C:14152-46-03	-	-	-	-	-	-
77766	Bracebridge & Muskoka Lakes Secondary School	1	178A	Student Success Office 122A	No	No	CL	CT	1	N/D	-	-	V/C:14152-46-05	-	-	-	-	-	-
77767	Bracebridge & Muskoka Lakes Secondary School	1	178B	Office/Admin Area 122B	No	No	WL	DJC	3	N/D	-	-	V/C:14152-46-03	-	-	-	-	-	-
77768	Bracebridge & Muskoka Lakes Secondary School	1	178B	Office/Admin Area 122B	No	No	CL	CT	1	N/D	-	-	V/C:14152-46-05	-	-	-	-	-	-
77769	Bracebridge & Muskoka Lakes Secondary School	1	178C	Office/Admin Area 122C	No	No	WL	DJC	3	N/D	-	-	V/C:14152-46-03	-	-	-	-	-	-
77770	Bracebridge & Muskoka Lakes Secondary School	1	178C	Office/Admin Area 122C	No	No	CL	CT	1	N/D	-	-	V/C:14152-46-05	-	-	-	-	-	-
77771	Bracebridge & Muskoka Lakes Secondary School	1	178D	Office/Admin Area 122D	No	No	WL	DJC	3	N/D	-	-	V/C:14152-46-03	-	-	-	-	-	-
77772	Bracebridge & Muskoka Lakes Secondary School	1	178D	Office/Admin Area 122D	No	No	CL	CT	1	N/D	-	-	V/C:14152-46-05	-	-	-	-	-	-
77773	Bracebridge & Muskoka Lakes Secondary School	1	179	Room 120	No	No	FL	VFT	2	N/D	-	-	V/C:14152-46-07	-	-	-	-	-	-
77774	Bracebridge & Muskoka Lakes Secondary School	1	179	Room 120	No	No	CL	CT	1	N/D	-	-	V/C:14152-46-05	-	-	-	-	-	-
77775	Bracebridge & Muskoka Lakes Secondary School	1	180	Community Resources 118	No	No	FL	VFT	2	N/D	-	-	V/C:14152-46-07	-	-	-	-	-	-
77776	Bracebridge & Muskoka Lakes Secondary School	1	180	Community Resources 118	No	No	CL	CT	1	N/D	-	-	V/C:14152-46-05	-	-	-	-	-	-
77777	Bracebridge & Muskoka Lakes Secondary School	1	181	Meeting Room 116	No	No	FL	VFT	2	N/D	-	-	V/C:14152-46-07	-	-	-	-	-	-
77778	Bracebridge & Muskoka Lakes Secondary School	1	181	Meeting Room 116	No	No	CL	CT	1	N/D	-	-	V/C:14152-46-05	-	-	-	-	-	-
77779	Bracebridge & Muskoka Lakes Secondary School	1	182	Reception 114	No	No	CL	CT	1	N/D	-	-	V/C:14152-46-05	-	-	-	-	-	-
77780	Bracebridge & Muskoka Lakes Secondary School	1	182A	Principals Office 114A	No	No	WL	DJC	3	N/D	-	-	V/C:14152-46-03	-	-	-	-	-	-
77781	Bracebridge & Muskoka Lakes Secondary School	1	182A	Principals Office 114A	No	No	CL	CT	1	N/D	-	-	V/C:14152-46-05	-	-	-	-	-	-
77782	Bracebridge & Muskoka Lakes Secondary School	1	182B	Vice-Principals Office 114B	No	No	WL	DJC	3	N/D	-	-	V/C:14152-46-03	-	-	-	-	-	-
77783	Bracebridge & Muskoka Lakes Secondary School	1	182B	Vice-Principals Office 114B	No	No	CL	CT	1	N/D	-	-	V/C:14152-46-05	-	-	-	-	-	-
77784	Bracebridge & Muskoka Lakes Secondary School	1	182C	Vice-Principals Office 114C	No	No	WL	DJC	3	N/D	-	-	V/C:14152-46-03	-	-	-	-	-	-
77785	Bracebridge & Muskoka Lakes Secondary School	1	182C	Vice-Principals Office 114C	No	No	CL	CT	1	N/D	-	-	V/C:14152-46-05	-	-	-	-	-	-
77786	Bracebridge & Muskoka Lakes Secondary School	1	182D	Photocopy Room 114D	No	No	FL	VFT	2	N/D	-	-	V/C:14152-46-07	-	-	-	-	-	-
77787	Bracebridge & Muskoka Lakes Secondary School	1	182D	Photocopy Room 114D	No	No	CL	CT	1	N/D	-	-	V/C:14152-46-05	-	-	-	-	-	-
77788	Bracebridge & Muskoka Lakes Secondary School	1	182E	Washroom 114E	No	No	CL	CT	1	N/D	-	-	V/C:14152-46-05	-	-	-	-	-	-
77789	Bracebridge & Muskoka Lakes Secondary School	1	182F	Vault 114F	-	-	-	-	-	-	-	-	-	-	-	-	-	-	No access to area during survey
77790	Bracebridge & Muskoka Lakes Secondary School	1	182G	File Room 114G	No	No	WL	DJC	3	N/D	-	-	V/C:14152-46-03	-	-	-	-	-	-
77791	Bracebridge & Muskoka Lakes Secondary School	1	182G	File Room 114G	No	No	CL	CT	1	N/D	-	-	V/C:14152-46-05	-	-	-	-	-	-
77699	Bracebridge & Muskoka Lakes Secondary School	1	183	Stairwell 5	No	No	CL	DJC	4	N/D	-	-	14152-46-04G	-	-	-	-	-	-
77960	Bracebridge & Muskoka Lakes Secondary School	2	201	Stairwell 1	No	No	CL	CT	1	N/D	-	-	V/C:14152-46-05	-	-	-	-	-	-
77924	Bracebridge & Muskoka Lakes Secondary School	2	202	Corridor "2B"	No	No	CL	DJC	4	N/D	-	-	V/C:14152-46-04	-	-	-	-	-	-
77925	Bracebridge & Muskoka Lakes Secondary School	2	202	Corridor "2B"	No	No	CL	CT	1	N/D	-	-	V/C:14152-46-05	-	-	-	-	-	-
77912	Bracebridge & Muskoka Lakes Secondary School	2	203	Physics 250	No	No	FL	VFT	1	N/D	-	-	V/C:14152-46-06	-	-	-	-	-	-
77913	Bracebridge & Muskoka Lakes Secondary School	2	203	Physics 250	No	No	CL	CT	1	N/D	-	-	V/C:14152-46-05	-	-	-	-	-	-
77909	Bracebridge & Muskoka Lakes Secondary School	2	204	Chemistry 248	No	No	FL	VFT	1	N/D	-	-	V/C:14152-46-06	-	-	-	-	-	-
77910	Bracebridge & Muskoka Lakes Secondary School	2	204	Chemistry 248	No	No	CL	CT	1	N/D	-	-	V/C:14152-46-05	-	-	-	-	-	-
77911	Bracebridge & Muskoka Lakes Secondary School	2	204	Chemistry 248	No	No	BH	DJC	1	N/D	-	-	V/C:14152-46-01	-	-	-	-	-	-
77906	Bracebridge & Muskoka Lakes Secondary School	2	205	Chemistry 244	No	No	CL	DJC	4	N/D	-	-	V/C:14152-46-04	-	-	-	-	-	-
77907	Bracebridge & Muskoka Lakes Secondary School	2	205	Chemistry 244	No	No	CL	CT	1	N/D	-	-	V/C:14152-46-05	-	-	-	-	-	-
77908	Bracebridge & Muskoka Lakes Secondary School	2	205	Chemistry 244	No	No	BH	DJC	1	N/D	-	-	V/C:14152-46-01	-	-	-	-	-	-
77901	Bracebridge & Muskoka Lakes Secondary School	2	206	Chemical 246	No	No	FL	VFT	1	N/D	-	-	V/C:14152-46-06	-	-	-	-	-	-
77902	Bracebridge & Muskoka Lakes Secondary School	2	206	Chemical 246	No	No	WL	DJC	3	N/D	-	-	V/C:14152-46-03	-	-	-	-	-	-
77903	Bracebridge & Muskoka Lakes Secondary School	2	206	Chemical 246	No	No	CL	CT	1	N/D	-	-	V/C:14152-46-05	-	-	-	-	-	-
77904	Bracebridge & Muskoka Lakes Secondary School	2	206A	Storage/Shower Area 246A	No	No	FL	VFT	1	N/D	-	-	V/C:14152-46-06	-	-	-	-	-	-
77905	Bracebridge & Muskoka Lakes Secondary School	2	206A	Storage/Shower Area 246A	No	No	CL	CT	1	N/D	-	-	V/C:14152-46-05	-	-	-	-	-	-
77865	Bracebridge & Muskoka Lakes Secondary School	2	207	Stairwell 4	No	No	CL	CT	1	N/D	-	-	V/C:14152-46-05	-	-	-	-	-	-
77862	Bracebridge & Muskoka Lakes Secondary School	2	208	Room 242	No	No	FL	VFT	1	N/D	-	-	V/C:14152-46-06	-	-	-	-	-	-
77863	Bracebridge & Muskoka Lakes Secondary School	2	208	Room 242	No	No	CL	CT	1	N/D	-	-	V/C:14152-46-05	-	-	-	-	-	-
77864	Bracebridge & Muskoka Lakes Secondary School	2	208	Room 242	No	No	BH	DJC	1	N/D	-	-	V/C:14152-46-01	-	-	-	-	-	-
77920	Bracebridge & Muskoka Lakes Secondary School	2	209	Corridor "2A"	No	No	CL	CT	1	N/D	-	-	V/C:14152-46-05	-	-	-	-	-	-
77921	Bracebridge & Muskoka Lakes Secondary School	2	209	Corridor "2A"	No	No	CL	DJC	4	N/D	-	-	V/C:14152-46-04	-	-	-	-	-	-
77922	Bracebridge & Muskoka Lakes Secondary School	2	209	Corridor "2A"	No	No	WL	DJC	3	N/D	-	-	V/C:14152-46-03	-	-	-	-	-	-
77859	Bracebridge & Muskoka Lakes Secondary School	2	210	Room 240	No	No	FL	VFT	1	N/D	-	-	V/C:14152-46-06	-	-	-	-	-	-
77860	Bracebridge & Muskoka Lakes Secondary School	2	210	Room 240	No	No	CL	CT	1	N/D	-	-	V/C:14152-46-05	-	-	-	-	-	-
77861	Bracebridge & Muskoka Lakes Secondary School	2	210	Room 240	No	No	BH	DJC	1	N/D	-	-	V/C:14152-46-01	-	-	-	-	-	-
77856	Bracebridge & Muskoka Lakes Secondary School	2	211	Room 238	No	No	FL	VFT	1	N/D	-	-	V/C:14152-46-06	-	-	-	-	-	-
77857	Bracebridge & Muskoka Lakes Secondary School	2	211	Room 238	No	No	CL	CT	1	N/D	-	-	V/C:14152-46-05	-	-	-	-	-	-



STRUCTURAL ELEMENT

RF: Roof B/J: Beams/Joists
 WN: Window CB: Chalkboard
 FL: Floor PI: Pipe
 CL: Ceiling DT: Duct
 WL: Wall BL: Boiler
 DK: Deck MC: Mechanical

ACCESSIBILITY

A: All occupants of the facility
 B: Maintenance staff without a ladder
 C: Maintenance staff with a ladder, exposed to view without moving building components
 D: Maintenance staff with a ladder, concealed from view by building components

TERMINOLOGY

ACM: Asbestos Containing Material N/A: Not Applicable
 CT: Ceiling Tile N/Anz: Not Analyzed
 DJC: Drywall Joint Compound N/D: None Detected
 FTG: Fitting PI-AC: Pipe Insulation - Aircell
 LF: Linear Feet PI-PC: Pipe Insulation-Parging Cement
 PI-CP: Pipe Insulation-Caposite

PL: Plaster
 RM: Roofing Materials
 SFP: Sprayed Fireproofing
 SF: Square Feet
 TF: Texture Finish

TB: Transite Board
 TP: Transite Pipe
 VI: Vermiculite Insulation
 VFT: Vinyl Floor Tile

VSF: Vinyl Sheet Flooring
 V/C: Visually Consistent w/ Other Sampled Material
 WC: Window Caulking

E: No access without demolition or removal of fixed building components or systems

CONDITION G: Good F: Fair P: Poor

ID	Facility	Floor #	Room #	Room name	Has ACM	Friable	Struct. Elem.	Application	Material	Type	Qty	Condition	Sample #	Action	Ref #	Comments 1	Comments 2	Comments 3	Notes
77858	Bracebridge & Muskoka Lakes Secondary School	2	211	Room 238	No	No	BH	DJC	1	N/D	-	-	V/C:14152-46-01	-	-	-	-	-	-
77853	Bracebridge & Muskoka Lakes Secondary School	2	212	Room 236	No	No	FL	VFT	1	N/D	-	-	V/C:14152-46-06	-	-	-	-	-	-
77854	Bracebridge & Muskoka Lakes Secondary School	2	212	Room 236	No	No	CL	CT	1	N/D	-	-	V/C:14152-46-05	-	-	-	-	-	-
77855	Bracebridge & Muskoka Lakes Secondary School	2	212	Room 236	No	No	BH	DJC	1	N/D	-	-	V/C:14152-46-01	-	-	-	-	-	-
77850	Bracebridge & Muskoka Lakes Secondary School	2	213	Staff Room 234	No	No	FL	VFT	1	N/D	-	-	V/C:14152-46-06	-	-	-	-	-	-
77851	Bracebridge & Muskoka Lakes Secondary School	2	213	Staff Room 234	No	No	CL	CT	1	N/D	-	-	V/C:14152-46-05	-	-	-	-	-	-
77852	Bracebridge & Muskoka Lakes Secondary School	2	213	Staff Room 234	No	No	BH	DJC	1	N/D	-	-	V/C:14152-46-01	-	-	-	-	-	-
77849	Bracebridge & Muskoka Lakes Secondary School	2	214	Stairwell 3	No	No	CL	CT	1	N/D	-	-	V/C:14152-46-05	-	-	-	-	-	-
77883	Bracebridge & Muskoka Lakes Secondary School	2	215	Room 232	No	No	FL	VFT	1	N/D	-	-	14152-46-06C	-	-	-	-	-	-
77884	Bracebridge & Muskoka Lakes Secondary School	2	215	Room 232	No	No	BH	DJC	1	N/D	-	-	V/C:14152-46-01	-	-	-	-	-	-
77885	Bracebridge & Muskoka Lakes Secondary School	2	215	Room 232	No	No	CL	CT	1	N/D	-	-	V/C:14152-46-05	-	-	-	-	-	-
77886	Bracebridge & Muskoka Lakes Secondary School	2	216	Room 230	No	No	FL	VFT	1	N/D	-	-	V/C:14152-46-06	-	-	-	-	-	-
77887	Bracebridge & Muskoka Lakes Secondary School	2	216	Room 230	No	No	BH	DJC	1	N/D	-	-	V/C:14152-46-01	-	-	-	-	-	-
77888	Bracebridge & Muskoka Lakes Secondary School	2	216	Room 230	No	No	CL	CT	1	N/D	-	-	V/C:14152-46-05	-	-	-	-	-	-
77889	Bracebridge & Muskoka Lakes Secondary School	2	217	Room 228	No	No	FL	VFT	1	N/D	-	-	V/C:14152-46-06	-	-	-	-	-	-
77890	Bracebridge & Muskoka Lakes Secondary School	2	217	Room 228	No	No	BH	DJC	1	N/D	-	-	14152-46-01D	-	-	-	-	-	-
77891	Bracebridge & Muskoka Lakes Secondary School	2	217	Room 228	No	No	CL	CT	1	N/D	-	-	14152-46-05C	-	-	-	-	-	-
77892	Bracebridge & Muskoka Lakes Secondary School	2	218	Room 226	No	No	FL	VFT	1	N/D	-	-	V/C:14152-46-06	-	-	-	-	-	-
77893	Bracebridge & Muskoka Lakes Secondary School	2	218	Room 226	No	No	BH	DJC	1	N/D	-	-	V/C:14152-46-01	-	-	-	-	-	-
77894	Bracebridge & Muskoka Lakes Secondary School	2	218	Room 226	No	No	CL	CT	1	N/D	-	-	V/C:14152-46-05	-	-	-	-	-	-
77895	Bracebridge & Muskoka Lakes Secondary School	2	219	Room 224	No	No	FL	VFT	1	N/D	-	-	V/C:14152-46-06	-	-	-	-	-	-
77896	Bracebridge & Muskoka Lakes Secondary School	2	219	Room 224	No	No	BH	DJC	1	N/D	-	-	V/C:14152-46-01	-	-	-	-	-	-
77897	Bracebridge & Muskoka Lakes Secondary School	2	219	Room 224	No	No	CL	CT	1	N/D	-	-	V/C:14152-46-05	-	-	-	-	-	-
77898	Bracebridge & Muskoka Lakes Secondary School	2	220	Room 222	No	No	FL	VFT	1	N/D	-	-	V/C:14152-46-06	-	-	-	-	-	-
77899	Bracebridge & Muskoka Lakes Secondary School	2	220	Room 222	No	No	BH	DJC	1	N/D	-	-	V/C:14152-46-01	-	-	-	-	-	-
77900	Bracebridge & Muskoka Lakes Secondary School	2	220	Room 222	No	No	CL	CT	1	N/D	-	-	V/C:14152-46-05	-	-	-	-	-	-
77882	Bracebridge & Muskoka Lakes Secondary School	2	221	Storage Room 207	No	No	CL	CT	1	N/D	-	-	14152-46-05B	-	-	-	-	-	-
77881	Bracebridge & Muskoka Lakes Secondary School	2	222	Data Room 209	No	No	CL	CT	1	N/D	-	-	V/C:14152-46-05	-	-	-	-	-	-
77880	Bracebridge & Muskoka Lakes Secondary School	2	223	Electrical Room 211	No	No	CL	CT	1	N/D	-	-	V/C:14152-46-05	-	-	-	-	-	-
77877	Bracebridge & Muskoka Lakes Secondary School	2	224	Room 213	No	No	FL	VFT	1	N/D	-	-	V/C:14152-46-06	-	-	-	-	-	-
77878	Bracebridge & Muskoka Lakes Secondary School	2	224	Room 213	No	No	BH	DJC	1	N/D	-	-	V/C:14152-46-01	-	-	-	-	-	-
77879	Bracebridge & Muskoka Lakes Secondary School	2	224	Room 213	No	No	CL	CT	1	N/D	-	-	V/C:14152-46-05	-	-	-	-	-	-
77871	Bracebridge & Muskoka Lakes Secondary School	2	225	Boys & Girls Washrooms	No	No	CL	DJC	4	N/D	-	-	V/C:14152-46-04	-	-	-	-	-	-
77873	Bracebridge & Muskoka Lakes Secondary School	2	225	Boys & Girls Washrooms	No	No	BH	DJC	1	N/D	-	-	V/C:14152-46-01	-	-	-	-	-	-
77875	Bracebridge & Muskoka Lakes Secondary School	2	225	Boys & Girls Washrooms	No	No	CL	CT	1	N/D	-	-	V/C:14152-46-05	-	-	-	-	-	-
77872	Bracebridge & Muskoka Lakes Secondary School	2	226	Boys & Girls Washrooms	No	No	CL	DJC	4	N/D	-	-	V/C:14152-46-04	-	-	-	-	-	-
77874	Bracebridge & Muskoka Lakes Secondary School	2	226	Boys & Girls Washrooms	No	No	BH	DJC	1	N/D	-	-	V/C:14152-46-01	-	-	-	-	-	-
77876	Bracebridge & Muskoka Lakes Secondary School	2	226	Boys & Girls Washrooms	No	No	CL	CT	1	N/D	-	-	V/C:14152-46-05	-	-	-	-	-	-
77869	Bracebridge & Muskoka Lakes Secondary School	2	227	Business Studies 219	No	No	FL	VFT	2	N/D	-	-	V/C:14152-46-07	-	-	-	-	-	-
77870	Bracebridge & Muskoka Lakes Secondary School	2	227	Business Studies 219	No	No	CL	CT	1	N/D	-	-	V/C:14152-46-05	-	-	-	-	-	-
77867	Bracebridge & Muskoka Lakes Secondary School	2	228	Computer Science 221	No	No	FL	VFT	2	N/D	-	-	14152-46-07C	-	-	-	-	-	-
77868	Bracebridge & Muskoka Lakes Secondary School	2	228	Computer Science 221	No	No	CL	CT	1	N/D	-	-	V/C:14152-46-05	-	-	-	-	-	-
77866	Bracebridge & Muskoka Lakes Secondary School	2	229	Mechanical Room 223	No	No	WL	DJC	3	N/D	-	-	V/C:14152-46-03	-	-	-	-	-	-
77918	Bracebridge & Muskoka Lakes Secondary School	2	230	Storage Room 225	No	No	FL	VFT	1	N/D	-	-	V/C:14152-46-06	-	-	-	-	-	-
77919	Bracebridge & Muskoka Lakes Secondary School	2	230	Storage Room 225	No	No	CL	CT	1	N/D	-	-	V/C:14152-46-05	-	-	-	-	-	-
77915	Bracebridge & Muskoka Lakes Secondary School	2	231	Room 227	No	No	FL	VFT	1	N/D	-	-	V/C:14152-46-06	-	-	-	-	-	-
77916	Bracebridge & Muskoka Lakes Secondary School	2	231	Room 227	No	No	BH	DJC	1	N/D	-	-	V/C:14152-46-01	-	-	-	-	-	-
77917	Bracebridge & Muskoka Lakes Secondary School	2	231	Room 227	No	No	CL	CT	1	N/D	-	-	V/C:14152-46-05	-	-	-	-	-	-
77914	Bracebridge & Muskoka Lakes Secondary School	2	232	Greenhouse 229	No	No	BH	DJC	1	N/D	-	-	V/C:14152-46-01	-	-	-	-	-	-
77926	Bracebridge & Muskoka Lakes Secondary School	2	233	Stairwell 2	No	No	CL	CT	1	N/D	-	-	V/C:14152-46-05	-	-	-	-	-	-
77927	Bracebridge & Muskoka Lakes Secondary School	2	234	Room 220	No	No	FL	VFT	1	N/D	-	-	V/C:14152-46-06	-	-	-	-	-	-
77928	Bracebridge & Muskoka Lakes Secondary School	2	234	Room 220	No	No	BH	DJC	1	N/D	-	-	V/C:14152-46-01	-	-	-	-	-	-
77929	Bracebridge & Muskoka Lakes Secondary School	2	234	Room 220	No	No	CL	CT	1	N/D	-	-	V/C:14152-46-05	-	-	-	-	-	-
77930	Bracebridge & Muskoka Lakes Secondary School	2	235	Room 218	No	No	FL	VFT	1	N/D	-	-	V/C:14152-46-06	-	-	-	-	-	-
77931	Bracebridge & Muskoka Lakes Secondary School	2	235	Room 218	No	No	BH	DJC	1	N/D	-	-	V/C:14152-46-01	-	-	-	-	-	-
77932	Bracebridge & Muskoka Lakes Secondary School	2	235	Room 218	No	No	CL	CT	1	N/D	-	-	V/C:14152-46-05	-	-	-	-	-	-
77933	Bracebridge & Muskoka Lakes Secondary School	2	236	Room 216	No	No	FL	VFT	1	N/D	-	-	V/C:14152-46-06	-	-	-	-	-	-
77934	Bracebridge & Muskoka Lakes Secondary School	2	236	Room 216	No	No	BH	DJC	1	N/D	-	-	V/C:14152-46-01	-	-	-	-	-	-
77935	Bracebridge & Muskoka Lakes Secondary School	2	236	Room 216	No	No	CL	CT	1	N/D	-	-	V/C:14152-46-05	-	-	-	-	-	-
77936	Bracebridge & Muskoka Lakes Secondary School	2	237	Room 214	No	No	FL	VFT	1	N/D	-	-	V/C:14152-46-06	-	-	-	-	-	-
77937	Bracebridge & Muskoka Lakes Secondary School	2	237	Room 214	No	No	BH	DJC	1	N/D	-	-	V/C:14152-46-01	-	-	-	-	-	-
77938	Bracebridge & Muskoka Lakes Secondary School	2	237	Room 214	No	No	CL	CT	1	N/D	-	-	V/C:14152-46-05	-	-	-	-	-	-
77939	Bracebridge & Muskoka Lakes Secondary School	2	238	Room 212	No	No	FL	VFT	1	N/D	-	-	V/C:14152-46-06	-	-	-	-	-	-
77940	Bracebridge & Muskoka Lakes Secondary School	2	238	Room 212	No	No	BH	DJC	1	N/D	-	-	14152-46-01E	-	-	-	-	-	-
77941	Bracebridge & Muskoka Lakes Secondary School	2	238	Room 212	No	No	CL	CT	1	N/D	-	-	V/C:14152-46-05	-	-	-	-	-	-
77942	Bracebridge & Muskoka Lakes Secondary School	2	239	Room 210	No	No	FL	VFT	1	N/D	-	-	V/C:14152-46-06	-	-	-	-	-	-
77943	Bracebridge & Muskoka Lakes Secondary School	2	239	Room 210	No	No	BH	DJC	1	N/D	-	-	14152-46-01G	-	-	-	-	-	-
77944	Bracebridge & Muskoka Lakes Secondary School	2	239	Room 210	No	No	CL	CT	1	N/D	-	-	V/C:14152-46-05	-	-	-	-	-	-
77945	Bracebridge & Muskoka Lakes Secondary School	2	240	Room 208	No	No	FL	VFT	1	N/D	-	-	V/C:14152-46-06	-	-	-	-	-	-
77946	Bracebridge & Muskoka Lakes Secondary School	2	240	Room 208	No	No	BH	DJC	1	N/D	-	-	14152-46-01F	-	-	-	-	-	-



STRUCTURAL ELEMENT

RF: Roof
WN: Window
FL: Floor
CL: Ceiling
WL: Wall
DK: Deck

B/J: Beams/Joists
CB: Chalkboard
PI: Pipe
DT: Duct
BL: Boiler
MC: Mechanical

ACCESSIBILITY

A: All occupants of the facility
B: Maintenance staff without a ladder
C: Maintenance staff with a ladder, exposed to view without moving building components
D: Maintenance staff with a ladder, concealed from view by building components

TERMINOLOGY

ACM: Asbestos Containing Material
CT: Ceiling Tile
DJ: Drywall Joint Compound
FTG: Fitting
LF: Linear Feet

N/A: Not Applicable
N/Anz: Not Analyzed
N/D: None Detected
PI-AC: Pipe Insulation - Aircell
PI-PC: Pipe Insulation-Parqing Cement
PI-CP: Pipe Insulation-Caposite

PL: Plaster
RM: Roofing Materials
SFP: Sprayed Fireproofing
SF: Square Feet
TF: Texture Finish

TB: Transit Board
TP: Transit Pipe
VI: Vermiculite Insulation
VFT: Vinyl Floor Tile

VSF: Vinyl Sheet Flooring
V/C: Visually Consistent w/ Other Sampled Material
WC: Window Caulking

E: No access without demolition or removal of fixed building components or systems

CONDITION G: Good F: Fair P: Poor

ID	Facility	Floor #	Room #	Room name	Has ACM	Friable	Struct. Elem.	Application	Material	Type	Qty	Condition	Sample #	Action	Ref #	Comments 1	Comments 2	Comments 3	Notes
77947	Bracebridge & Muskoka Lakes Secondary School	2	240	Room 208	No	No	CL	CT	1	N/D	-	-	V/C:14152-46-05	-	-	-	-	-	-
77948	Bracebridge & Muskoka Lakes Secondary School	2	241	Room 206	No	No	FL	VFT	1	N/D	-	-	V/C:14152-46-06	-	-	-	-	-	-
77949	Bracebridge & Muskoka Lakes Secondary School	2	241	Room 206	No	No	BH	DJC	1	N/D	-	-	V/C:14152-46-01	-	-	-	-	-	-
77950	Bracebridge & Muskoka Lakes Secondary School	2	241	Room 206	No	No	CL	CT	1	N/D	-	-	V/C:14152-46-05	-	-	-	-	-	-
77923	Bracebridge & Muskoka Lakes Secondary School	2	242	Stairwell 5	No	No	CL	CT	1	N/D	-	-	14152-46-04G	-	-	-	-	-	-
77961	Bracebridge & Muskoka Lakes Secondary School	2	243	Data 204	No	-	-	-	-	-	-	-	-	-	-	-	-	-	No ACM or presumed ACM material
77962	Bracebridge & Muskoka Lakes Secondary School	2	244	Room 202	No	No	FL	VFT	1	N/D	-	-	V/C:14152-46-06	-	-	-	-	-	-
77963	Bracebridge & Muskoka Lakes Secondary School	2	244	Room 202	No	No	CL	CT	1	N/D	-	-	V/C:14152-46-05	-	-	-	-	-	-
77964	Bracebridge & Muskoka Lakes Secondary School	2	245	Room 200	No	No	FL	VFT	1	N/D	-	-	V/C:14152-46-06	-	-	-	-	-	-
77965	Bracebridge & Muskoka Lakes Secondary School	2	245	Room 200	No	No	BH	DJC	1	N/D	-	-	V/C:14152-46-01	-	-	-	-	-	-
77966	Bracebridge & Muskoka Lakes Secondary School	2	245	Room 200	No	No	CL	CT	1	N/D	-	-	V/C:14152-46-05	-	-	-	-	-	-
77967	Bracebridge & Muskoka Lakes Secondary School	2	246	Stairwell 6	No	No	CL	DJC	4	N/D	-	-	V/C:14152-46-04	-	-	-	-	-	-
77968	Bracebridge & Muskoka Lakes Secondary School	2	247	Elevator "2A"	No	-	-	-	-	-	-	-	-	-	-	-	-	-	No ACM or presumed ACM material
77969	Bracebridge & Muskoka Lakes Secondary School	2	248	Student Parliament 270	No	No	FL	VFT	1	N/D	-	-	V/C:14152-46-06	-	-	-	-	-	-
77970	Bracebridge & Muskoka Lakes Secondary School	2	248	Student Parliament 270	No	No	WL	DJC	3	N/D	-	-	V/C:14152-46-03	-	-	-	-	-	-
77971	Bracebridge & Muskoka Lakes Secondary School	2	248	Student Parliament 270	No	No	CL	CT	1	N/D	-	-	V/C:14152-46-05	-	-	-	-	-	-
77972	Bracebridge & Muskoka Lakes Secondary School	2	249	Girls Washroom (6052)	No	No	CL	DJC	4	N/D	-	-	V/C:14152-46-04	-	-	-	-	-	-
77973	Bracebridge & Muskoka Lakes Secondary School	2	249	Girls Washroom (6052)	No	No	CL	CT	1	N/D	-	-	V/C:14152-46-05	-	-	-	-	-	-
77974	Bracebridge & Muskoka Lakes Secondary School	2	249	Girls Washroom (6052)	No	No	BH	DJC	1	N/D	-	-	V/C:14152-46-01	-	-	-	-	-	-
77975	Bracebridge & Muskoka Lakes Secondary School	2	250	Boys Washroom (6053)	No	No	CL	DJC	3	N/D	-	-	V/C:14152-46-04	-	-	-	-	-	-
77976	Bracebridge & Muskoka Lakes Secondary School	2	250	Boys Washroom (6053)	No	No	CL	CT	1	N/D	-	-	V/C:14152-46-05	-	-	-	-	-	-
77977	Bracebridge & Muskoka Lakes Secondary School	2	250	Boys Washroom (6053)	No	No	BH	DJC	1	N/D	-	-	V/C:14152-46-01	-	-	-	-	-	-
77978	Bracebridge & Muskoka Lakes Secondary School	2	251	Custodial 264	No	No	CL	DJC	4	N/D	-	-	V/C:14152-46-04	-	-	-	-	-	-
77979	Bracebridge & Muskoka Lakes Secondary School	2	252	Mechanical Room 262	No	-	-	-	-	-	-	-	-	-	-	-	-	-	No ACM or presumed ACM material
77980	Bracebridge & Muskoka Lakes Secondary School	2	253	Staff Room 260	No	No	FL	VFT	1	N/D	-	-	V/C:14152-46-06	-	-	-	-	-	-
77981	Bracebridge & Muskoka Lakes Secondary School	2	253	Staff Room 260	No	No	CL	CT	1	N/D	-	-	V/C:14152-46-05	-	-	-	-	-	-
77982	Bracebridge & Muskoka Lakes Secondary School	2	254	Male Staff Washroom 258	No	No	CL	CT	1	N/D	-	-	V/C:14152-46-05	-	-	-	-	-	-
77983	Bracebridge & Muskoka Lakes Secondary School	2	254	Male Staff Washroom 258	No	No	BH	DJC	1	N/D	-	-	V/C:14152-46-01	-	-	-	-	-	-
77984	Bracebridge & Muskoka Lakes Secondary School	2	255	Female Staff Washroom 256	No	No	CL	CT	1	N/D	-	-	V/C:14152-46-05	-	-	-	-	-	-
77985	Bracebridge & Muskoka Lakes Secondary School	2	255	Female Staff Washroom 256	No	No	BH	DJC	1	N/D	-	-	V/C:14152-46-01	-	-	-	-	-	-
77951	Bracebridge & Muskoka Lakes Secondary School	2	256	Room 205	No	No	FL	VFT	1	N/D	-	-	V/C:14152-46-06	-	-	-	-	-	-
77952	Bracebridge & Muskoka Lakes Secondary School	2	256	Room 205	No	No	BH	DJC	1	N/D	-	-	14152-46-01C	-	-	-	-	-	-
77953	Bracebridge & Muskoka Lakes Secondary School	2	256	Room 205	No	No	CL	CT	1	N/D	-	-	V/C:14152-46-05	-	-	-	-	-	-
77954	Bracebridge & Muskoka Lakes Secondary School	2	257	Room 203	No	No	FL	VFT	2	N/D	-	-	V/C:14152-46-07	-	-	-	-	-	-
77955	Bracebridge & Muskoka Lakes Secondary School	2	257	Room 203	No	No	BH	DJC	1	N/D	-	-	V/C:14152-46-01	-	-	-	-	-	-
77956	Bracebridge & Muskoka Lakes Secondary School	2	257	Room 203	No	No	CL	CT	1	N/D	-	-	V/C:14152-46-05	-	-	-	-	-	-
77957	Bracebridge & Muskoka Lakes Secondary School	2	258	Staff Room 201	No	No	FL	VFT	1	N/D	-	-	V/C:14152-46-06	-	-	-	-	-	-
77958	Bracebridge & Muskoka Lakes Secondary School	2	258	Staff Room 201	No	No	BH	DJC	1	N/D	-	-	V/C:14152-46-01	-	-	-	-	-	-
77959	Bracebridge & Muskoka Lakes Secondary School	2	258	Staff Room 201	No	No	CL	CT	1	N/D	-	-	V/C:14152-46-05	-	-	-	-	-	-
77987	Bracebridge & Muskoka Lakes Secondary School	2	259	(Including Stairwell)	No	No	CL	DJC	4	N/D	-	-	V/C:14152-46-04	-	-	-	-	-	-
77986	Bracebridge & Muskoka Lakes Secondary School	2	259	Auditorium Upper Lobby	No	No	WL	DJC	3	N/D	-	-	V/C:14152-46-03	-	-	-	-	-	-
77991	Bracebridge & Muskoka Lakes Secondary School	2	260	Upper Auditorium Corridor "B"	No	-	-	-	-	-	-	-	-	-	-	-	-	-	No ACM or presumed ACM material
77995	Bracebridge & Muskoka Lakes Secondary School	2	261	Gallery	No	No	WL	DJC	3	N/D	-	-	V/C:14152-46-03	-	-	-	-	-	-
77992	Bracebridge & Muskoka Lakes Secondary School	2	262	Upper Level Seating Area	No	No	WL	DJC	3	N/D	-	-	V/C:14152-46-03	-	-	-	-	-	-
77994	Bracebridge & Muskoka Lakes Secondary School	2	262A	Lighting Platform "A"	No	No	WL	DJC	3	N/D	-	-	V/C:14152-46-03	-	-	-	-	-	-
77993	Bracebridge & Muskoka Lakes Secondary School	2	262B	Lighting Platform "B"	No	No	WL	DJC	3	N/D	-	-	V/C:14152-46-03	-	-	-	-	-	-
77989	Bracebridge & Muskoka Lakes Secondary School	2	263	Catwalk Room 2021	No	No	FL	VFT	1	N/D	-	-	V/C:14152-46-06	-	-	-	-	-	-
77988	Bracebridge & Muskoka Lakes Secondary School	2	263	Control Room 2202	No	No	FL	VFT	1	N/D	-	-	V/C:14152-46-06	-	-	-	-	-	-
77990	Bracebridge & Muskoka Lakes Secondary School	2	264	Upper Auditorium Corridor "A"	No	-	-	-	-	-	-	-	-	-	-	-	-	-	No ACM or presumed ACM material
77996	Bracebridge & Muskoka Lakes Secondary School	2	266	Mechanical Room 2214	No	-	-	-	-	-	-	-	-	-	-	-	-	-	No ACM or presumed ACM material
77996	Bracebridge & Muskoka Lakes Secondary School	NA		Exterior	No	No	RF	RM	NA	ACM Assumed	1	G	NS						sample prior to renovation
77997	Bracebridge & Muskoka Lakes Secondary School	NA		Exterior	No	No	WN	WC	NA	ACM Assumed	1	G	NS						sample prior to renovation

APPENDIX II

DRAWINGS

LEGEND

- 01A Sample Location - 14152-46-xx
- # Ebase Number
- No Access into Room

****Note:** Transite Pipe (storm drain) presumed Asbestos-Containing, not sampled.

CONFIRMED ACM

SYMBOL	DESCRIPTION
	Friable Asbestos-Containing Material
	Non-Friable Asbestos-Containing Material
TP	Transite Pipe (Non-Friable Asbestos-Containing Material)

For Detailed Information as to Location, Type, Quantity, Condition and Access to ACM, Please Refer to the Room-by-Room Sheets Provided in the Report.

**Bracebridge and Muskoka Lakes
Secondary School**
100 Clearbrook Trail
Bracebridge, Ontario

First Floor Plan

Asbestos Materials Re-Assessment Survey

CLIENT: Trillium Lakelands District School Board

PROJECT NUMBER: 22300-50 DATE: September 2025 DRW BY: J. Prosser

SCALE: Not to Scale CHK BY: K. Prosser



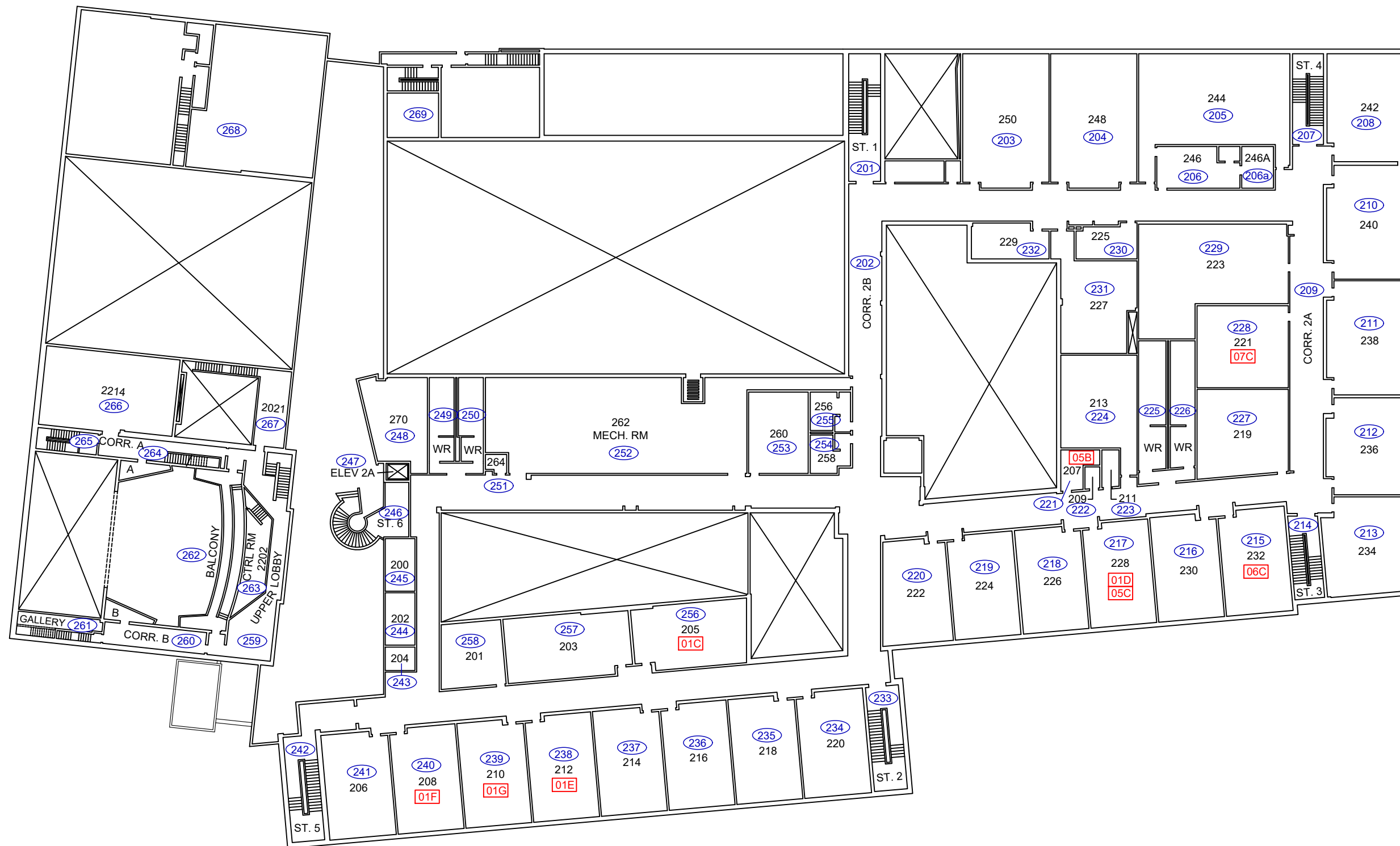

LEGEND

- 01A Sample Location - 14152-46-xx
- # Ebase Number
- No Access into Room

CONFIRMED ACM

SYMBOL	DESCRIPTION
	Friable Asbestos-Containing Material
	Non-Friable Asbestos-Containing Material

For Detailed Information as to Location, Type, Quantity, Condition and Access to ACM, Please Refer to the Room-by-Room Sheets Provided in the Report.

**Bracebridge and Muskoka Lakes
Secondary School**
100 Clearbrook Trail
Bracebridge, Ontario

Second Floor Plan
Asbestos Materials Re-Assessment Survey

CLIENT: Trillium Lakelands District School Board

PROJECT NUMBER: 22300-50	DATE: September 2025	DRW BY: J. Prosser
	SCALE: Not to Scale	CHK BY: K. Prosser



APPENDIX III
POTENTIAL ASBESTOS-CONTAINING MATERIAL
IDENTIFICATION SHEET

APPENDIX III - POTENTIAL ASBESTOS-CONTAINING MATERIALS INFORMATION SHEET

<i>MIN</i>	<i>Material</i>	<i>Material Description</i>	<i>Size</i>	<i>Sample Number</i>	<i>Sample Location</i>	<i>Asbestos Containing</i>
VFT-1	Vinyl Floor Tiles	Light Brown with White and Feint Brown Streaks	12" x 12"	14152-46-06A,B,C	Room 144E, Room 166, Room 232	No
VFT-2	Vinyl Floor Tiles	Grey with White Streaks	2' x 2'	14152-46-07A,B,C	Room 147, Room 149A, Room 221	No
CT-1	Ceiling Tile	Textured w/ Small Holes & Pin Holes	2' x 4'	14152-46-05A,B,C	Room 156, Room 207, Room 228	No
DJC-1	Drywall/Drywall Joint Compound	Horizontal Drywall Bulkhead	N/A	14152-46-01A-G	Room 149, Room 153, Room 205, Room 228, Room 212, Room 208, Room 210	No
DJC-2	Drywall/Drywall Joint Compound	Vertical Drywall Bulkhead	N/A	14152-46-02A,B,C	Room 121B	No
DJC-3	Drywall/Drywall Joint Compound	Wall Drywall/DJC	N/A	14152-46-03A-G	Room 104 (2) , Room 100, Room 100A (2), Atrium (2)	No
DJC-4	Drywall/Drywall Joint Compound	Ceiling Drywall/DJC	N/A	14152-46-04A-G	Stairwell 3, 4, 2, 1, 5, Handicap Washroom 126A, Library 131	No