

### Scope of Work:

1. Provide Plywood backing, power and Data – See details – in the drawing.
2. Refer to DM drawings for more detail specs and scope of work for GC.
3. Patch, repair, Paint walls – wall paint color to match existing.
4. Please carry AP/PA ( data installer) in your subtrade to install data for this project.

In scenarios where power and data cannot be recessed into the wall, slim surface mounted device boxes can be used. Surface mounted conduit can also be used but must be routed straight down to the specified power and data location. Legrand Wiremold 151.6" deep boxes with 500/700 series raceway is recommended in scenarios where power and data cannot be recessed.

**NOTE:**

1. **FOR CONCRETE BLOCK WALL** - 1-in.3/4" plywood will need to be installed over the finished concrete block wall surface. power and data, our strong preference is for these to be recessed. If that's not feasible, the DM package outlines an alternative solution: using Legrand Wirmold surface-mounted boxes attached directly to the concrete block. However, please note that the associated surface-mounted raceway will also be exposed, which may not be ideal from an aesthetic standpoint.
2. **REPAIR, PATCH, PAINT WALLS**
3. Please refer DM drawing for more specification.
4. Remove / relocate existing Board if present in the wall – Coordinate with Project cleanliness.
5. maintain cleanliness before and after work.

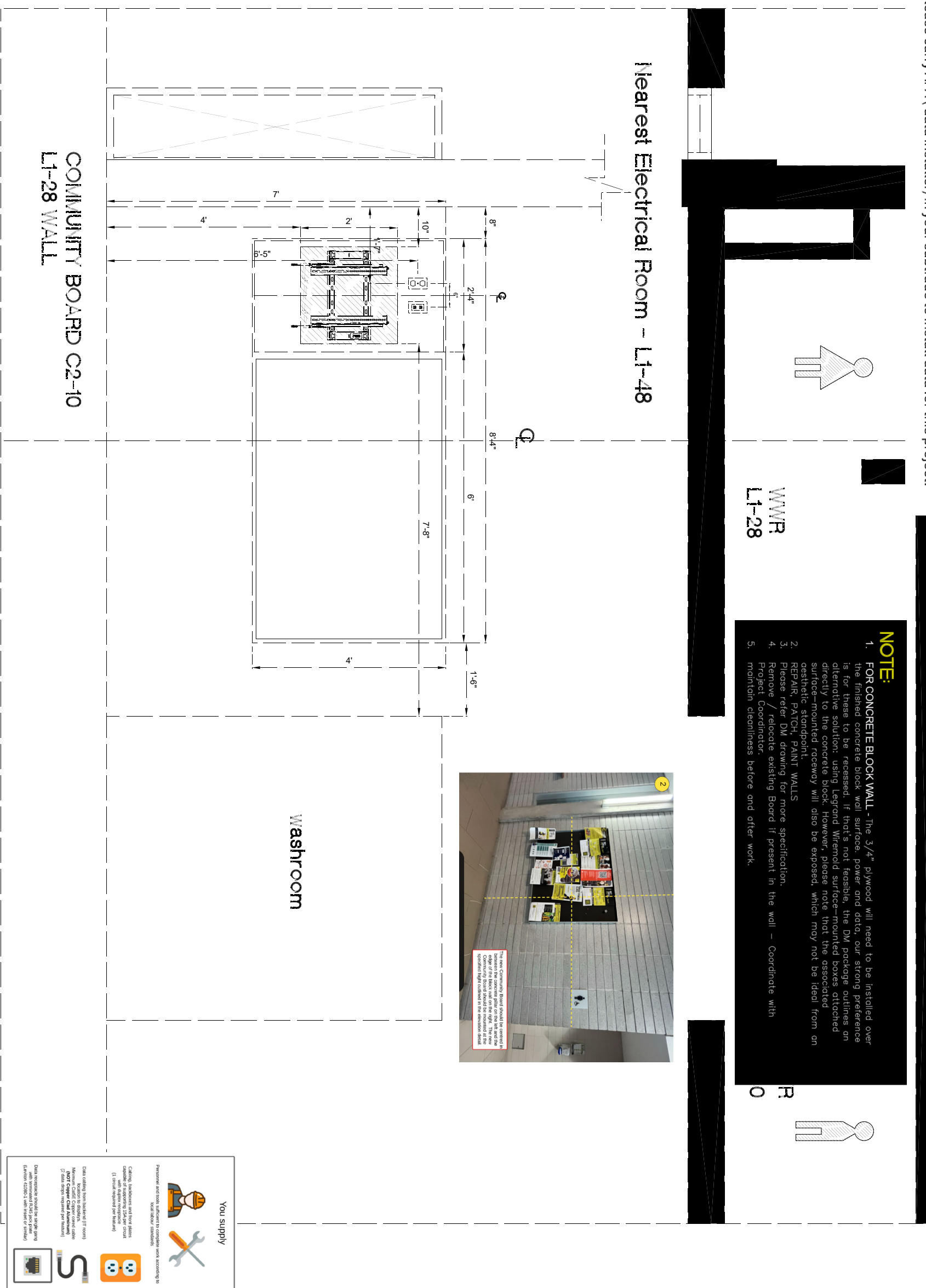
[illegible]

DIRECT	PROJECT NO.
890	
DATE: JULY 3, 2005	CHECKED BY:
SCALE:	
DESIGNED BY:	

