

ASBESTOS-CONTAINING BUILDING MATERIALS RE-ASSESSMENT REPORT

Haliburton Highlands Secondary School

5358 County Road #21
Haliburton, Ontario

Presented to:

Trillium Lakelands District School Board

Box 420, County Road 36
Lindsay, Ontario
K9V 4S4

Attention: Daniel Whalen

September 2024

Maple Project No. 21700-20

Executive Summary

2024 Asbestos-Containing Building Materials Re-Assessment Report

Maple Project	School Name	Address
21124-20	Haliburton Highlands Secondary School	5358 County Road #21, Haliburton, Ontario

Maple Environmental Inc. was retained by Trillium Lakelands District School Board to perform a re-assessment of known asbestos-containing building materials within the subject building.

The findings and recommendations of the current assessment are summarized below. Please refer to the main body of the report for details.

FINDINGS

Asbestos-containing materials (ACM) identified within the building at the time of the assessment are as follows:

ASBESTOS BUILDING MATERIALS SUMMARY							
MATERIAL	ASBESTOS			FRIABILITY			Remedial Work Required
	Yes	No	Suspect	Friable	Non-Friable	Potentially	
Sprayed Fireproofing		X		X			NO
Textured Finish		X		X			NO
Mechanical Insulations	Pipe Fittings	X	X	X			NO
	Pipe Straight		X	X			NO
	Ductwork		X	X			NO
	Mechanical Equip		X	X			NO
Ceiling Tiles		X				X	NO
Vinyl Sheet Flooring		X				X	NO
Vinyl Floor Tiles		X			X		NO
Asbestos Cement (Transite)	X				X		NO
Plaster			X			X	NO
Drywall Joint Compound	X				X		NO
Vermiculite		X		X			NO
Other (roofing, caulking, etc.)			X				NO

Please refer to Room by Room Inventory in Appendix I to view location, quantities, and condition of ACM observed within the building at the time of the assessment.

Executive Summary

2024 Asbestos-Containing Building Materials Re-Assessment Report

RECOMMENDATIONS

As asbestos-containing materials were found to be present within the building, Ontario Regulation 278/05 requires that the Trillium Lakelands District School Board's Asbestos Management Plan must apply to this building. In addition, an annual re-assessment of all ACM must be performed.

All asbestos-containing materials identified within the building were observed to be in GOOD condition and therefore no immediate recommendations are warranted.

General Statement

The Executive Summary must be read in conjunction with the main body of this report.

PREVIEW

YOU MUST BE A REGISTERED PLAN TAKER
TO DOWNLOAD AN UNMARKED VERSION OF THIS FILE
WWW.BIDSANDTENDERS.COM – ORIGINAL DOCUMENT SOURCE

TABLE OF CONTENTS

EXECUTIVE SUMMARY	<i>i</i>
1.0 INTRODUCTION	1
2.0 APPLICABLE ONTARIO REGULATIONS.....	1
2.1 ONTARIO REGULATION 278/05 (ASBESTOS)	1
2.2 ONTARIO REGULATION 347	2
3.0 SURVEY SCOPE AND METHODOLOGY.....	2
3.1 INVENTORY METHODOLOGY.....	3
3.2 ASBESTOS ASSESSMENT CRITERIA	3
3.3 LIMITATIONS AND OMISSIONS FROM SCOPE	4
3.4 SAMPLING STRATEGY AND ANALYTICAL METHODS	5
3.5 DRAWINGS.....	6
4.0 INVENTORY FINDINGS.....	6
4.1 SPRAYED FIREPROOFING (FRIABLE)	7
4.2 THERMAL MECHANICAL INSULATION (FRIABLE)	7
4.3 TEXTURE FINISH (FRIABLE)	8
4.4 ACOUSTIC CEILING TILES (POTENTIALLY FRIABLE).....	8
4.5 VINYL SHEET FLOORING (POTENTIALLY FRIABLE)	8
4.6 VINYL FLOOR TILE (NON-FRIABLE).....	8
4.7 ASBESTOS CEMENT PRODUCTS "TRANSITE" (NON-FRIABLE)	8
4.8 DRYWALL JOINT COMPOUND (DJC).....	8
4.9 PLASTER.....	8
4.10 VERMICULITE	8
5.0 RECOMMENDATIONS	9
5.1 GENERAL RECOMMENDATIONS	9
5.2 SPECIFIC RECOMMENDATIONS	9
6.0 LIMITATIONS.....	10
APPENDIX I	ROOM-BY-ROOM ASBESTOS INVENTORY
APPENDIX II	DRAWINGS
APPENDIX III	POTENTIAL ASBESTOS-CONTAINING MATERIAL IDENTIFICATION SHEET

1.0 INTRODUCTION

MAPLE Environmental Inc. ("MAPLE") was retained by the Trillium Lakelands District School Board (TLDSB) to perform a re-assessment of known asbestos-containing building materials within all TLDSB schools where asbestos was previously confirmed to be present (by others).

The assessment was completed in accordance with the requirement of Ontario Regulation 278/05 to complete a re-assessment on an annual basis.

The following report presents the findings and recommendations of the assessment for the specific building listed.

SUMMARY OF BUILDING INFORMATION	
School Name:	Haliburton Highlands Secondary School
Building Address:	5358 County Road #21, Haliburton, Ontario
Number of Floors:	2 (no basement)
Approximate Square Footage:	107,500
Assessed by:	Richards Reboks
Assessment Date:	August, 2024

2.0 APPLICABLE ONTARIO REGULATIONS

Applicable Ontario Regulations for each of the materials included in the investigation are briefly described below.

2.1 Ontario Regulation 278/05 (Asbestos)

The Ontario Ministry of Labour Regulation 278/05 requires a detailed asbestos inventory be performed in all buildings where friable and non-friable asbestos-containing materials (ACM) are present. The inventory must be available at the work place and must identify the type and location of asbestos-containing materials on a room-by-room basis, where necessary.

Each individual building report prepared by MAPLE meets or exceeds the requirements for an asbestos survey under Ontario Regulation 278/05.

Ontario Regulation 278/05 applies to buildings with regards to maintenance, renovation or demolition work where ACM is present and may be disturbed. The regulation requires all buildings where asbestos is known to be part of

the building materials to implement an Asbestos Management Program (AMP). TLDSB has prepared and maintains an AMP of which the current Re-Assessment report is part of.

2.2 Ontario Regulation 347

Ontario Regulation 347 applies to the transport of waste from the location of generation to a landfill site authorized to receive specific wastes. The regulation also prescribes procedures on how the specific wastes are to be handled at the landfill site.

The major requirements of the building owner and the person(s) removing the waste are to ensure that:

- The waste is appropriately packaged and labelled;
- The transport vehicle is appropriately placard; and
- The waste is to be transported as directly as possible to the landfill site once it leaves the site.

Some wastes require the Owner to register a Generator (of waste) number and many wastes require classification that can restrict or even prohibit their disposal in landfill.

It is important to note that the building owner can be held responsible for the waste until the waste disposal site accepts it.

3.0 SURVEY SCOPE AND METHODOLOGY

The surveys were performed on a Room-by-Room basis within each building included in the scope of the assessment where asbestos was previously identified (by others).

The scope of the surveys included all friable and major non-friable materials suspected to contain asbestos. The term friable is applied to a material that can be readily reduced to dust or powder by hand or moderate pressure. Asbestos materials that are friable have a much greater potential to release airborne asbestos fibres when disturbed.

Typical friable asbestos materials include; sprayed fireproofing or thermal insulation, textured (stippled) plaster, and thermal mechanical insulation. Typical non-friable materials include: asbestos cement (transite) products, caulking, vinyl floor tiles, asbestos textiles and gaskets. Additional materials such as ceiling tiles and drywall joint compounds are classified as non-friable, but because of their ability to release dust when disturbed they are considered as "potentially friable" for the purpose of this report.

3.1 Inventory Methodology

In order to determine the location of the materials included in the assessment, each room or area was entered where practical (i.e.: where access was possible without the demolition of walls, roof or ceilings or destruction of flooring) where asbestos materials were previously identified. An investigation of areas of the building where asbestos was not previously identified was not included in the scope of the current project.

Representative views were made above accessible suspended ceiling systems. Drywall or plaster ceilings were accessed via existing ceiling access panels only. The inventory did not include destructive testing of building systems or finishes to observe possible hidden conditions.

3.2 Asbestos Assessment Criteria

The recommendations and suggestions made as part of this report with respect to asbestos have taken into consideration the condition and accessibility of the asbestos-containing material as well as other factors such as water damage, vibration, air movement, and general activities in the area.

Where ACM is found to be in GOOD condition and not likely to deteriorate or fall, the general recommendation would be to re-evaluate the condition of the material on an annual basis (required by Regulation 278/05). This recommendation can be subject to change if the material is located in a manner that persons untrained in asbestos awareness could physically damage it.

Where the ACM is found to be damaged (i.e. FAIR or POOR condition), a recommendation to have the material cleaned-up, repaired, removed, enclosed, or encapsulated is offered. The recommendation will also indicate which asbestos procedure should be used to perform the remedial work (i.e. Type 1, Type 2, Type 3, or Glove Bag Removal Methods).

In each area or room inventoried, the quantity, condition (GOOD, FAIR, or POOR) and accessibility (A, B, C, D or E) of each suspect material was recorded.

The definitions for condition and accessibility items are as follows:

GOOD	Material is intact with no visible signs of damage.
FAIR	Material is visibly damaged but can be repaired.
POOR	Material is damaged beyond repair and likely needs to be removed.
Access A	Accessible to all occupants of the building.

- Access B** Accessible to Maintenance personnel without the use of a ladder (i.e. Mechanical Room, pipe chase etc.).
- Access C** Accessible to Maintenance personnel with the use of a ladder and is exposed to view without removing building components.
- Access D** Accessible to Maintenance personnel with the use of a ladder and is concealed from viewing due to a building component (i.e. above a removable ceiling).
- Access E** Not accessible without demolition of a building component (i.e. above a fixed ceiling system).

The asbestos related information collected during the previous assessments was confirmed and the room-by-room data updated to reflect the current information.

3.3 Limitations and Omissions from Scope

Due to the nature of building construction, some limitations exist in regards to the possible thoroughness of any building materials inventory. The field observations, measurements, and analysis are considered sufficient in detail and scope to form a reasonable basis for the findings presented in this report. MAPLE warrants that the findings and conclusions contained herein have been made in accordance with generally accepted evaluation methods in the industry and applicable regulations at the time of the performance of the inventory.

It is possible that conditions may exist which could not be reasonably identified within the scope of the inventory or which were not apparent during the site investigation. MAPLE believes that the information collected during the inventory period concerning the property is reliable. No other warranties are implied or expressed.

In addition, during a standard asbestos assessment, performed for the purposes of regulatory compliance, it is industry practice to exclude some non-friable materials in the inventory. Examples of such assumptions include; elevator brakes, roofing felts and mastics, high voltage wiring, mechanical packing and gaskets, underground services or piping, fire-doors, window caulking, levelling compound, and/or materials used in operating equipment. As such, these materials were not sampled at the time of this survey and where present are assumed to be asbestos containing until proven otherwise.

3.4 Sampling Strategy and Analytical Methods

As the majority of materials were previously sampled by others, the requirement for sampling during the current survey was limited. Where samples were collected, they conformed to the criteria outlined below and in compliance with O. Reg. 278/05.

A small volume of the material was removed either from a damaged section or cut out of intact material and then repaired by sealing with tape to prevent the release of fibres. The collected samples were placed in plastic bags, sealed and labelled and then sent to an independent laboratory for analysis. To ensure quality results, the independent laboratory chosen is NVLAP accredited and successfully participates in an "Asbestos Proficiency Analytical Testing Program" and as such, these laboratories are responsible for their findings.

The collection of samples was performed in accordance with regulatory sampling requirements and with sufficient frequency to obtain a general pattern of asbestos use within the building. Due to building renovations or modifications that have occurred, the consistency of the application of asbestos materials may not be uniform throughout the entire building. It is important to note that without sampling every wall, pipe section, ceiling tile etc. it is not possible to identify the possible asbestos content in every material present in the building. For this reason, materials similar in appearance to those sampled elsewhere in the building were visually identified as being homogeneous and thus are assumed to be composed of the same material, thus additional sampling is not required.

In accordance with Reg. 278/05, samples were collected at the following frequency.

Material Type	No. Samples
Sprayed Fireproofing	Up to 7
Texture Coat	Up to 7
Pipe Fitting Insulation	3
Pipe Straight Insulation	3
Ductwork Insulation	3
Ceiling Tiles	3
Vinyl Sheeting Flooring	3
Vinyl Floor Tile	3
Plaster Finishes	Up to 7
Drywall Compound	Up to 7

An independent NVLAP accredited laboratory, was used to analyse the collected samples. Analysis was performed following the Code of Practice for the identification of asbestos in bulk material, as detailed in Ontario Regulation 278/05. Bulk samples were analysed using the Polarized Light Microscopy ("PLM") Technique with Dispersion Staining. The identification of asbestos fibre in bulk material is based on a collective set of parameters

dependent on the unique shape and crystallographic properties of each fibre as viewed through the microscope. This method is useful for the qualitative identification of asbestos and the semi-quantitative determination of asbestos content in bulk materials expressed as a percent of projected area. The method identifies types of asbestos and also measures percent of asbestos as perceived by the analyst in comparison to standard area projections or trained experience.

Given the composition of some vinyl floor products, the PLM analysis method is often prone to yielding false negative analysis results. Therefore, it may be prudent that the Transmission Electron Microscopy (TEM) analysis method be used to determine the asbestos content in the vinyl floor products, if negative results are obtained from the laboratory analysis.

3.5 Drawings

Drawings provided for each building indicate the following (where present):

- ◇ Location Numbers (reference to Room-by-Room asbestos data)
- ◇ Asbestos-Containing Sprayed Fireproofing
- ◇ Asbestos-Containing Texture Finishes
- ◇ Asbestos-Containing Ceiling Tiles
- ◇ Asbestos-Containing Flooring Materials
- ◇ Presence of Asbestos-Containing Mechanical Insulations will not be specifically indicated on the drawings; however, a general statement regarding the presence of ACM mechanical insulations, where present, has been indicated on the drawings.
- ◇ Presence of asbestos-containing drywall joint compound and hard plaster will not be specifically identified on the drawings; however, a general statement regarding the presence of these ACM materials, where present, has been indicated on the drawings.

4.0 INVENTORY FINDINGS

The following is a brief discussion of the extent to which Asbestos-Containing Materials (ACM) was identified in the building. The discussion is organized under the headings of materials that are generally suspected of containing asbestos. Refer to the Room-by-Room Survey Inventory in Appendix I for a detailed description and location of all ACM.

Destructive testing was not conducted and as such some areas within the building were not accessible for an assessment (i.e. above solid ceilings, behind walls). Access for viewing within wall and ceiling cavities was not always possible. Suspect asbestos materials may be present within ceiling and wall cavities that were not identified in this report. This comment is particularly important for materials such as mechanical insulation. Caution should be taken when demolishing solid wall finishes within the building.

4.1 Sprayed Fireproofing (Friable)

No asbestos-containing sprayed fireproofing was identified to be present in the building.

4.2 Thermal Mechanical Insulation (Friable)

Asbestos and non-asbestos mechanical insulations were identified in the building. A brief description of the insulations is provided below categorized by mechanical system type. Further, it is important to note that mechanical systems may be present within walls and ceiling cavities or pipe chases that were not accessible during this assessment. The presence of ACM mechanical insulations in these locations should be suspected.

Pipe Systems:

Pipe Fittings, including elbows, valves, tees, hangers, etc. where insulated are insulated with parging cement previously confirmed to contain Chrysotile asbestos or are insulated with non-asbestos materials (i.e. Fibreglass). However, the pipe fitting insulation present within the Cafeteria (eBase #103) could not be accessed during the initial or subsequent reassessment surveys due to height restrictions. As such, the fitting insulation is suspected to be asbestos-containing until sampling proves otherwise. All pipe fitting insulation were found to be in GOOD condition.

Pipe Straights, within Hallway 3 (eBase #118) were observed to be insulated with corrugated paper insulation commonly referred by the trade name "Aircell." No samples were collected at the time of the discovery as the material was inaccessible due to height restrictions. Aircell pipe straight insulation should be considered as suspect asbestos until sampling proves otherwise. Additionally, pipe straight insulation present within the Cafeteria (eBase #103) could not be accessed during the initial or subsequent reassessment surveys due to height restrictions. As such, the pipe straight insulation is suspected to be asbestos-containing until sampling proves otherwise. The suspect pipe straight insulations were found to be in GOOD condition. All other pipe straight insulations where present are insulated with non-asbestos fibreglass and/or armaflex materials.

Ductwork:

Duct systems were either insulated with non-asbestos fibreglass or were un-insulated.

Mechanical Equipment:

Mechanical equipment was observed to be externally un-insulated.

4.3 Texture Finish (Friable)

No asbestos-containing texture finishes were identified to be present within the building.

4.4 Acoustic Ceiling Tiles (Potentially Friable)

No asbestos-containing acoustic ceiling tiles were identified to be present within the building.

4.5 Vinyl Sheet Flooring (Potentially Friable)

No asbestos-containing vinyl sheet flooring was identified to be present within the building.

4.6 Vinyl Floor Tile (Non-Friable)

No asbestos-containing vinyl floor tiles were identified to be present within the building.

4.7 Asbestos Cement Products "Transite" (Non-Friable)

Asbestos-containing Transite is present in the form of panels within the East Attic (eBase #215) and exterior soffit. All transite was found to be in GOOD condition. Refer to the Room-by-Room Inventory in Appendix I for details regarding location and quantity.

4.8 Drywall Joint Compound (DJC)

Previous sample results indicated drywall joint compound applied over smooth plaster within the Main Foyer (eBase 101) and Hallway 4 (eBase 174) contains asbestos. All drywall joint compound should be assumed to contain asbestos unless testing in specific areas indicates otherwise. The drywall was found to be in GOOD condition. Refer to the Room-by-Room Inventory in Appendix I for details regarding location and quantity.

4.9 Plaster

While previous sample results indicated all plaster finishes sampled at the Site does not contain asbestos, note that the concentration of asbestos within plaster is historically known to be potentially inconsistently distributed. Further, it is possible that various phases of construction and renovations have occurred at the Site. Therefore, the number of samples previously collected may not be representative of all plaster finishes in the building.

4.10 Vermiculite

Vermiculite insulation was previously sampled by Maple from the wall cavity in the Girl's Washroom (eBase 112), and found not to contain asbestos.

Caution should be taken when disturbing any wall cavities or if vermiculite insulation is observed. As a precautionary measure, all vermiculite insulation should be assumed to contain asbestos until future sampling confirms otherwise.

5.0 RECOMMENDATIONS

5.1 General Recommendations

Due to the presence of ACM within the building, TLDSB must maintain their existing Asbestos Management Program for this property.

A re-assessment of known ACM is to be conducted at least once annually.

It is important to note that due to the presence of solid walls and ceiling systems, ACM may be present in concealed locations not identified in this report.

The assessment confirmed the presence of ACM mechanical insulations within the building (Refer to room-by-room Inventory for condition and quantities). Should any proposed renovations likely cause disturbance of the mechanical insulations, the materials would require removal using Type 2, Type 3 or Glove Bag Asbestos procedures as appropriate for the work being performed.

If asbestos-containing acoustic tiles are likely to be disturbed, the tiles should be removed using Type 1 Asbestos procedures for less than 7.5 m² of tiles removed or Type 2 Asbestos procedures for the removal of greater than 7.5 m².

Removal or disturbance of transite cement products requires the use of Type 1 Asbestos procedures (provided no power tools are used and the material is wetted). If power tools are required Type 3 Asbestos procedures need be applied.

Removal or disturbance of ACM drywall less than 1m² will require the use of Type 1 Asbestos procedures, greater than 1m² Type 2 Asbestos procedures.

Materials suspected of containing asbestos should be sampled prior to disturbance. Suspect materials include; drywall joint compound, plaster, vermiculite, roofing materials, caulking, etc. unless previously confirmed to contain asbestos.

5.2 Specific Recommendations

All asbestos-containing materials identified within the building were observed to be in GOOD condition and therefore no immediate recommendations are warranted.

6.0 LIMITATIONS

Due to the nature of building construction some limitations exist as to the possible thoroughness of the subject investigation. The field observations are considered sufficient in detail and scope to form a reasonable basis for the findings presented in this report. MAPLE warrants that the findings and conclusions contained herein have been made in accordance with generally accepted evaluation methods in the industry and applicable regulations at the time of the performance of the assessment.

It is possible that conditions may exist which could not be reasonably identified within the scope of the investigation or which were not apparent during the site investigation. MAPLE believes that the information collected during the investigation period concerning the property is reliable. No other warranties are implied or expressed.

Information provided by Maple is intended for Client use only. Any use by a third party, of reports or documents authored by Maple, or any reliance by a third party on or decisions made by a third party based on the findings described in said documents, is the sole responsibility of such third parties. Maple accepts no responsibility for damages suffered by any third party as a result of decisions made or actions conducted.

The liability of Maple or its staff will be limited to the lesser of the fees paid or actual damages incurred by the Client. Maple will not be responsible for any consequential or indirect damages. Maple will only be liable for damages resulting from negligence of Maple; all claims by the Client shall be deemed relinquished if not made within two years after last date of services provided.

Please contact Maple Environmental Inc. at (905) 257-4408 for inquiries regarding this project.

Sincerely,

MAPLE ENVIRONMENTAL INC.
Environment, Health and Safety Consultants

Prepared By:



Richards Reboks
Senior Project Technologist

PREVIEW

APPENDIX I

ROOM-BY-ROOM ASBESTOS INVENTORY

YOU MUST BE A REGISTERED PLAN TAKER
TO DOWNLOAD AN UNMARKED VERSION OF THIS FILE
WWW.BIDSANDTENDERS.COM – ORIGINAL DOCUMENT SOURCE



STRUCTURAL ELEMENT				ACCESSIBILITY				TERMINOLOGY							
RF: Roof	B/L: Beams/Joints	CB: Chalkboard		A: All occupants of the facility				ACM: Asbestos Containing Material	N/A: Not Applicable	PL: Plaster		TB: Transite Board		VSF: Vinyl Sheet Flooring	
WN: Window				B: Maintenance staff without a ladder				CT: Ceiling Tile	N/A/N: Not Analyzed	RM: Roofing Materials		TP: Transite Pipe		VC: Visually Consistent w/ Other Sampled Material	
FL: Floor	Pl: Pipe			C: Maintenance staff with a ladder, exposed to view without moving building components				DJC: Drywall Joint Compound	N/D: None Detected	SFP: Sprayed Fireproofing		VI: Vermiculite Insulation		WC: Window Caulking	
CL: Ceiling	DT: Duct			D: Maintenance staff with a ladder, concealed from view by building components				FTG: Filing	PI-AC: Pipe Insulation - Ancell	SF: Square Feet		VFT: Vinyl Floor Tile			
WL: Wall	BL: Boiler			E: No access without demolition or removal of fixed building components or systems				LF: Linear Feet	PI-PC: Pipe Insulation-Parging Cement	TF: Texture Finish					
DK: Deck	MC: Mechanical							MA: Mastic	PI-CP: Pipe Insulation-Capacite						
								CONDITION G: Good F: Fair P: Poor							

ID	Facility	Floor #	Room #	Room name	Has ACM	Friable	Struct. Elem.	Application	Material	Type	Total Qty	Condition	Sample #	Action	Ref #	Comments 1	Comments 2	Comments 3	Notes
86709	Haliburton Highlands Secondary School	1		EXTERIOR	Yes	No	CL	TRANSITE		VISUALLY ACM	-	G	-			C			LOCATED ON MAIN ENTRANCE SOFFIT
86710	Haliburton Highlands Secondary School	1		EXTERIOR	Yes	No	NA	RM		ASSUMED ACM	1	G	-			C			
86711	Haliburton Highlands Secondary School	1		EXTERIOR	Yes	No	NA	WC		ASSUMED ACM	1	G	-			A, C			
86737	Haliburton Highlands Secondary School	1	101	MAIN FOYER	No	No	CL	CT	2	N/D	-	-	V/C 21-BS-09			-			
86738	Haliburton Highlands Secondary School	1	101	MAIN FOYER	No	No	CL	PL		N/D	-	-	21-BS-06A-B			-			
86739	Haliburton Highlands Secondary School	1	101	MAIN FOYER	No	No	CL	DJC		N/D	-	-	V/C 21-BS-07			-			
86740	Haliburton Highlands Secondary School	1	101	MAIN FOYER	No	No	WL	PL		N/D	-	-	18805E-S02A,C			-			
87045	Haliburton Highlands Secondary School	1	101	Main Foyer	No	No	PI	PI	Cellulose	N/D	-	-	14973-20-01A			D			Cellulose on Domestic Water Lines
87047	Haliburton Highlands Secondary School	1	101	MAIN FOYER	Yes	No	WL	DJC		1% CHRYSOTILE	-	G	-			A			Applied over smooth plaster
86735	Haliburton Highlands Secondary School	1	102A	LUNCHROOM STORAGE	No	No	CL	PL		N/D	-	-	V/C 21-BS-06			-			
86736	Haliburton Highlands Secondary School	1	102A	LUNCHROOM STORAGE	No	No	WL	PL		N/D	-	-	V/C 21-BS-06			-			
86729	Haliburton Highlands Secondary School	1	103	CAFETERIA	No	No	WL	PL		N/D	-	-	V/C 21-BS-06			-			
86730	Haliburton Highlands Secondary School	1	103	CAFETERIA	Yes	Yes	PI	PI		ASSUMED ACM	500 LF	G	-			C			TOO HIGH TO SAMPLE
86731	Haliburton Highlands Secondary School	1	103	CAFETERIA	Yes	Yes	FTG	PI		ASSUMED ACM	30 FT FTIN	G	-			C			TOO HIGH TO SAMPLE
86732	Haliburton Highlands Secondary School	1	103A	KITCHEN	No	No	FL	VSE	1	N/D	-	-	21-BS-15A-C			-			
86733	Haliburton Highlands Secondary School	1	103A	KITCHEN	No	No	CL	PL		N/D	-	-	V/C 21-BS-06			-			
86734	Haliburton Highlands Secondary School	1	103A	KITCHEN	No	No	WL	DJC		N/D	-	-	21-BS-07E			-			
86741	Haliburton Highlands Secondary School	1	104	THEATRE	No	No	WL	DJC		N/D	-	-	21-BS-07F			-			
86742	Haliburton Highlands Secondary School	1	105	HALLWAY 1	No	No	CL	PL		N/D	-	-	V/C 21-BS-06			-			
86743	Haliburton Highlands Secondary School	1	105	HALLWAY 1	No	No	CL	CT	1	N/D	-	-	21-BS-08C			-			
86744	Haliburton Highlands Secondary School	1	105A	DRESSING ROOM HALLWAY	No	No	FL	VFT	10	N/D	-	-	V/C 21-BS-25			-			
86745	Haliburton Highlands Secondary School	1	105A	DRESSING ROOM HALLWAY	No	No	CL	CT	1	N/D	-	-	V/C 21-BS-08			-			
86746	Haliburton Highlands Secondary School	1	105A	DRESSING ROOM HALLWAY	No	No	CL	PL		N/D	-	-	V/C 21-BS-06			-			
86747	Haliburton Highlands Secondary School	1	105A	DRESSING ROOM HALLWAY	No	No	WL	DJC		N/D	-	-	V/C 21-BS-07			-			
86754	Haliburton Highlands Secondary School	1	106	GREEN ROOM	No	No	FL	VFT	10	N/D	-	-	V/C 21-BS-25			-			
86755	Haliburton Highlands Secondary School	1	106	GREEN ROOM	No	No	CL	DJC		N/D	-	-	V/C 21-BS-07			-			
86756	Haliburton Highlands Secondary School	1	106	GREEN ROOM	No	No	WL	DJC		N/D	-	-	V/C 21-BS-07			-			
86757	Haliburton Highlands Secondary School	1	107	CUSTODIAN STORAGE	No	No	FL	VFT	10	N/D	-	-	V/C 21-BS-25			-			
86758	Haliburton Highlands Secondary School	1	107	CUSTODIAN STORAGE	No	No	CL	DJC		N/D	-	-	V/C 21-BS-07			-			
86759	Haliburton Highlands Secondary School	1	107	CUSTODIAN STORAGE	No	No	WL	DJC		N/D	-	-	V/C 21-BS-07			-			
86760	Haliburton Highlands Secondary School	1	107A	CUSTODIAN KITCHEN	No	No	FL	VFT	11	N/D	-	-	V/C 21-BS-26			-			
86761	Haliburton Highlands Secondary School	1	107A	CUSTODIAN KITCHEN	No	No	CL	DJC		N/D	-	-	V/C 21-BS-07			-			
86762	Haliburton Highlands Secondary School	1	107A	CUSTODIAN KITCHEN	No	No	WL	DJC		N/D	-	-	V/C 21-BS-07			-			
86751	Haliburton Highlands Secondary School	1	108	LADIES' DRESSING ROOM	No	No	FL	VFT	13	N/D	-	-	V/C 21-BS-28			-			
86752	Haliburton Highlands Secondary School	1	108	LADIES' DRESSING ROOM	No	No	CL	DJC		N/D	-	-	V/C 21-BS-07			-			
86753	Haliburton Highlands Secondary School	1	108	LADIES' DRESSING ROOM	No	No	WL	DJC		N/D	-	-	V/C 21-BS-07			-			
86748	Haliburton Highlands Secondary School	1	109	MEN'S DRESSING ROOM	No	No	FL	VFT	14	N/D	-	-	21-BS-29C			-			
86749	Haliburton Highlands Secondary School	1	109	MEN'S DRESSING ROOM	No	No	CL	DJC		N/D	-	-	V/C 21-BS-07			-			
86750	Haliburton Highlands Secondary School	1	109	MEN'S DRESSING ROOM	No	No	WL	DJC		N/D	-	-	V/C 21-BS-07			-			
86763	Haliburton Highlands Secondary School	1	110	25	No	No	CL	CT	2	N/D	-	-	V/C 21-BS-09			-			
86764	Haliburton Highlands Secondary School	1	110	25	No	No	WL	PL		N/D	-	-	V/C 21-BS-06			-			
86765	Haliburton Highlands Secondary School	1	110A	MUSIC STORAGE	No	No	FL	VFT	11	N/D	-	-	V/C 21-BS-26			-			
86766	Haliburton Highlands Secondary School	1	110A	MUSIC STORAGE	No	No	CL	CT	1	N/D	-	-	V/C 21-BS-08			-			
86767	Haliburton Highlands Secondary School	1	110A	MUSIC STORAGE	No	No	WL	DJC		N/D	-	-	V/C 21-BS-07			-			
86768	Haliburton Highlands Secondary School	1	111	BOYS WASHROOM	No	No	CL	CT	5	N/D	-	-	21-BS-12B-C			-			
86769	Haliburton Highlands Secondary School	1	111	BOYS WASHROOM	No	No	CL	CT	6	2% AMOSITE	-	-	21-BS-13A			-			150 SF removed 2014 (Maple Report 14419)
86770	Haliburton Highlands Secondary School	1	111	BOYS WASHROOM	No	No	CL	MASTIC		N/D	-	-	21-BS-14B			-			
86771	Haliburton Highlands Secondary School	1	111	BOYS WASHROOM	No	Yes	CL	TF	1	0.75% CHRYSOTILE	-	-	21-BS-04E			-			300 SF removed 2014 (Maple Report 14419)
86772	Haliburton Highlands Secondary School	1	112	GIRLS WASHROOM	No	No	CL	CT	5	N/D	-	-	21-BS-12A			-			
86773	Haliburton Highlands Secondary School	1	112	GIRLS WASHROOM	No	No	CL	CT	6	2% AMOSITE	-	-	V/C 21-BS-13			-			60 SF removed 2014 (Maple Report 14419)
86774	Haliburton Highlands Secondary School	1	112	GIRLS WASHROOM	No	No	CL	MASTIC		N/D	-	-	21-BS-14A			-			
86775	Haliburton Highlands Secondary School	1	112	GIRLS WASHROOM	No	Yes	CL	TF	1	0.75% CHRYSOTILE	-	-	V/C 21-BS-04			-			300 SF removed 2014 (Maple Report 14419)
87049	Haliburton Highlands Secondary School	1	112	GIRLS WASHROOM	No	No	WL			VERMICULITE	N/D	-	-	18962-S01A-C			-		
86786	Haliburton Highlands Secondary School	1	113	GUIDANCE OFFICE 1	No	No	CL	DJC		N/D	-	-	V/C 21-BS-07			-			
86787	Haliburton Highlands Secondary School	1	113	GUIDANCE OFFICE 1	No	No	WL	DJC		N/D	-	-	V/C 21-BS-07			-			
86788	Haliburton Highlands Secondary School	1	113A	GUIDANCE OFFICE 2	No	No	CL	DJC		N/D	-	-	V/C 21-BS-07			-			
86789	Haliburton Highlands Secondary School	1	113A	GUIDANCE OFFICE 2	No	No	WL	DJC		N/D	-	-	V/C 21-BS-07			-			
86790	Haliburton Highlands Secondary School	1	113B	GUIDANCE OFFICE 3	No	No	CL	DJC		N/D	-	-	V/C 21-BS-07			-			
86791	Haliburton Highlands Secondary School	1	113B	GUIDANCE OFFICE 3	No	No	WL	DJC		N/D	-	-	V/C 21-BS-07			-			
86792	Haliburton Highlands Secondary School	1	113C	GUIDANCE OFFICE 4	No	No	CL	DJC		N/D	-	-	18805E-S01C			-			
86793	Haliburton Highlands Secondary School	1	113C	GUIDANCE OFFICE 4	No	No	WL	DJC		N/D	-	-	18805E-S01A,B			-			
86794	Haliburton Highlands Secondary School	1	113D	GUIDANCE OFFICE 5	No	No	CL	DJC		N/D	-	-	V/C 21-BS-07			-			
86795	Haliburton Highlands Secondary School	1	113D	GUIDANCE OFFICE 5	No	No	WL	DJC		N/D	-	-	V/C 21-BS-07			-			
86796	Haliburton Highlands Secondary School	1	113E	GUIDANCE OFFICE 6	No	No	CL	DJC		N/D	-	-	V/C 21-BS-07			-			
86797	Haliburton Highlands Secondary School	1	113E	GUIDANCE OFFICE 6	No	No	WL	DJC		N/D	-	-	V/C 21-BS-07			-			
86825	Haliburton Highlands Secondary School	1	114	WASHROOM BY GUIDANCE	No	No	FL	VFT	12	N/D	-	-	21-BS-27A			-			
86826	Haliburton Highlands Secondary School	1	114	WASHROOM BY GUIDANCE	No	No	CL	CT	4	N/D	-	-	V/C 21-BS-11			-			
86827	Haliburton Highlands Secondary School	1	114	WASHROOM BY GUIDANCE	No	No	CL	PL		N/D	-	-	V/C 21-BS-06			-			
86828	Haliburton Highlands Secondary School	1	114	WASHROOM BY GUIDANCE	No	No	WL	DJC		N/D	-	-	V/C 21-BS-07			-			
86809	Haliburton Highlands Secondary School	1	115	CUSTODIAN CLOSET	No	No	FL	VFT	8	N/D	-	-	21-BS-23C			-			
86810	Haliburton Highlands Secondary School	1	115	CUSTODIAN CLOSET	No	No	CL	PL		N/D	-	-	V/C 21-BS-06			-			
86811	Haliburton Highlands Secondary School	1	115	CUSTODIAN CLOSET	No	No	CL	PL		N/D	-	-	V/C 21-BS-06			-			
86812	Haliburton Highlands Secondary School	1	116	RESOURCE ROOM 1	No	No	CL	CT	4	N/D	-	-	21-BS-11B-C			-			
86813	Haliburton Highlands Secondary School	1	116	RESOURCE ROOM 1	No	No	CL	PL		N/D	-	-	V/C 21-BS-06			-			
86814	Haliburton Highlands Secondary School	1	116	RESOURCE ROOM 1	No	No	WL	DJC		N/D	-	-	V/C 21-BS-07			-			
86815	Haliburton Highlands Secondary School	1	116A	RESOURCE ROOM 2	No	No	CL	CT	4	N/D	-	-	V/C 21-BS-11			-			



STRUCTURAL ELEMENT		ACCESSIBILITY		TERMINOLOGY					
RF: Roof	B/L: Beams/Joints	A: All occupants of the facility		ACM: Asbestos Containing Material	N/A: Not Applicable	PL: Plaster	TB: Transite Board	VSF: Vinyl Sheet Flooring	
WB: Window	CB: Chalkboard	B: Maintenance staff without a ladder		CT: Ceiling Tile	N/A/N: Not Analyzed	RM: Roofing Materials	TP: Transite Pipe	VC: Visually Consistent w/ Other Sampled Material	
FL: Floor	PL: Pipe	C: Maintenance staff with a ladder, exposed to view without moving building components		DJC: Drywall Joint Compound	N/D: None Detected	SFP: Sprayed Fireproofing	VI: Vermiculite Insulation	WC: Window Caulking	
CL: Ceiling	DT: Duct	D: Maintenance staff with a ladder, concealed from view by building components		FTG: Fitting	PI-AC: Pipe Insulation - Aircel	SF: Square Feet	VFT: Vinyl Floor Tile		
WL: Wall	BL: Boiler	E: No access without demolition or removal of fixed building components or systems		L/F: Linear Feet	PI-PC: Pipe Insulation-Parging Cement	TF: Texture Finish			
DK: Deck	MC: Mechanical			M/A: Mastic	PI-CP: Pipe Insulation-Capsote				
				CONDITION G: Good F: Fair P: Poor					

ID	Facility	Floor #	Room #	Room name	Has ACM	Friable	Struct. Elem.	Application	Material	Type	Total Qty	Condition	Sample #	Action	Ref #	Comments 1	Comments 2	Comments 3	Notes
96816	Haliburton Highlands Secondary School	1	116A	RESOURCE ROOM 2	No	No	CL	PL		N/D	-	-	V/C 21-BS-06	-	-	-	-	-	
96817	Haliburton Highlands Secondary School	1	116A	RESOURCE ROOM 2	No	No	WL	DJC		N/D	-	-	V/C 21-BS-07	-	-	-	-	-	
96818	Haliburton Highlands Secondary School	1	116B	RESOURCE ROOM 3	No	No	CL	CT	4	N/D	-	-	V/C 21-BS-11	-	-	-	-	-	
96819	Haliburton Highlands Secondary School	1	116B	RESOURCE ROOM 3	No	No	CL	PL		N/D	-	-	V/C 21-BS-06	-	-	-	-	-	
96820	Haliburton Highlands Secondary School	1	116B	RESOURCE ROOM 3	No	No	WL	DJC		N/D	-	-	V/C 21-BS-07	-	-	-	-	-	
96821	Haliburton Highlands Secondary School	1	116C	RESOURCE ROOM 4	No	No	FL	VFT	10	N/D	-	-	21-BS-25A	-	-	-	-	-	
96822	Haliburton Highlands Secondary School	1	116C	RESOURCE ROOM 4	No	No	CL	CT	4	N/D	-	-	V/C 21-BS-11	-	-	-	-	-	
96823	Haliburton Highlands Secondary School	1	116C	RESOURCE ROOM 4	No	No	CL	PL		N/D	-	-	V/C 21-BS-06	-	-	-	-	-	
96824	Haliburton Highlands Secondary School	1	116C	RESOURCE ROOM 4	No	No	WL	DJC		N/D	-	-	V/C 21-BS-07	-	-	-	-	-	
96829	Haliburton Highlands Secondary School	1	117	ROOM 1	No	No	FL	VFT	8	N/D	-	-	21-BS-23B	-	-	-	-	-	
96830	Haliburton Highlands Secondary School	1	117	ROOM 1	No	No	CL	CT	2	N/D	-	-	V/C 21-BS-09	-	-	-	-	-	
96831	Haliburton Highlands Secondary School	1	117	ROOM 1	No	No	WL	PL		N/D	-	-	V/C 21-BS-06	-	-	-	-	-	
96832	Haliburton Highlands Secondary School	1	117	ROOM 1	No	No	WL	CT	8	N/D	-	-	V/C 21-BS-13	-	-	-	-	-	250 SF removed 2014 (Maple Report 14419)
96855	Haliburton Highlands Secondary School	1	118	HALLWAY 3	No	No	CL	CT	2	N/D	-	-	V/C 21-BS-09	-	-	-	-	-	
96856	Haliburton Highlands Secondary School	1	118	HALLWAY 3	No	No	WL	PL		N/D	-	-	V/C 21-BS-06	-	-	-	-	-	
97050	Haliburton Highlands Secondary School	1	118	HALLWAY 3	Yes	Yes	FTG	PI-PC		35% CHRYSOTILE	50	-		-	-	-	-	-	19662
97051	Haliburton Highlands Secondary School	1	118	HALLWAY 3	Yes	Yes	PI	PI-AC		35% CHRYSOTILE	300	-		-	-	-	-	-	19662
96853	Haliburton Highlands Secondary School	1	119	ENGLISH OFFICE	No	No	CL	PL		N/D	-	-	V/C 21-BS-06	-	-	-	-	-	
96854	Haliburton Highlands Secondary School	1	119	ENGLISH OFFICE	No	No	WL	PL		N/D	-	-	V/C 21-BS-06	-	-	-	-	-	
96837	Haliburton Highlands Secondary School	1	120	ROOM 3	No	No	FL	VFT	7	N/D	-	-	21-BS-22B	-	-	-	-	-	
96838	Haliburton Highlands Secondary School	1	120	ROOM 3	No	No	CL	CT	2	N/D	-	-	V/C 21-BS-09	-	-	-	-	-	
96839	Haliburton Highlands Secondary School	1	120	ROOM 3	No	No	WL	PL		N/D	-	-	V/C 21-BS-06	-	-	-	-	-	
96840	Haliburton Highlands Secondary School	1	120	ROOM 3	No	No	WL	CT	6	2% AMOSITE	-	-	V/C 21-BS-13	-	-	-	-	-	250 SF removed 2014 (Maple Report 14419)
96845	Haliburton Highlands Secondary School	1	121	ROOM 5	No	No	FL	VFT	7	N/D	-	-	21-BS-22A	-	-	-	-	-	
96846	Haliburton Highlands Secondary School	1	121	ROOM 5	No	No	CL	CT	2	N/D	-	-	V/C 21-BS-09	-	-	-	-	-	
96847	Haliburton Highlands Secondary School	1	121	ROOM 5	No	No	WL	PL		N/D	-	-	V/C 21-BS-06	-	-	-	-	-	
96848	Haliburton Highlands Secondary School	1	121	ROOM 5	No	No	WL	CT	6	2% AMOSITE	-	-	V/C 21-BS-13	-	-	-	-	-	250 SF removed 2014 (Maple Report 14419)
96990	Haliburton Highlands Secondary School	1	123	7	No	No	FL	VFT	12	N/D	-	-	21-BS-27C	-	-	-	-	-	
96991	Haliburton Highlands Secondary School	1	123	7	No	No	CL	CT	1	N/D	-	-	21-BS-08B	-	-	-	-	-	
96986	Haliburton Highlands Secondary School	1	124	8	No	No	CL	CT	2	N/D	-	-	21-BS-08A	-	-	-	-	-	
96987	Haliburton Highlands Secondary School	1	124	8	No	No	CL	CT	6	2% AMOSITE	-	-	V/C 21-BS-13	-	-	-	-	-	960 SF removed 2014 (Maple Report 14419)
96988	Haliburton Highlands Secondary School	1	124	8	No	No	WL	PL		N/D	-	-	21-BS-06F	-	-	-	-	-	
96989	Haliburton Highlands Secondary School	1	124	8	No	No	WL	CT	6	2% AMOSITE	-	-	V/C 21-BS-13	-	-	-	-	-	960 SF removed 2014 (Maple Report 14419)
96982	Haliburton Highlands Secondary School	1	125	9	No	No	CL	CT	2	N/D	-	-	V/C 21-BS-09	-	-	-	-	-	
96983	Haliburton Highlands Secondary School	1	125	9	No	No	WL	PL		N/D	-	-	V/C 21-BS-06	-	-	-	-	-	
96984	Haliburton Highlands Secondary School	1	125	9	No	No	WL	CT	6	2% AMOSITE	-	-	V/C 21-BS-13	-	-	-	-	-	960 SF removed 2014 (Maple Report 14419)
96985	Haliburton Highlands Secondary School	1	125	9	No	No	CL	CT	6	2% AMOSITE	-	-	V/C 21-BS-13	-	-	-	-	-	960 SF removed 2014 (Maple Report 14419)
97046	Haliburton Highlands Secondary School	1	126	Corridor H2	No	No	PI	PI	Cellulose	N/D	-	-	14973-20-01B & C	-	-	D	-	-	Cellulose in Ceiling Space
96978	Haliburton Highlands Secondary School	1	126	HALLWAY 2	No	No	CL	CT	2	N/D	-	-	V/C 21-BS-09	-	-	-	-	-	
96979	Haliburton Highlands Secondary School	1	126	HALLWAY 2	No	No	CL	CT	6	-	-	-	21-BS-13C	-	-	-	-	-	Abated material
96980	Haliburton Highlands Secondary School	1	126	HALLWAY 2	No	No	WL	PL		N/D	-	-	V/C 21-BS-06	-	-	-	-	-	
96981	Haliburton Highlands Secondary School	1	126	HALLWAY 2	No	No	WL	DJC		N/D	-	-	21-BS-07D	-	-	-	-	-	
96977	Haliburton Highlands Secondary School	1	127	BOILER ROOM 2	-	-	-	-	-	-	-	-	-	-	-	-	-	-	
96974	Haliburton Highlands Secondary School	1	128	GIRLS WASHROOM 2	No	No	CL	CT	2	N/D	-	-	V/C 21-BS-09	-	-	-	-	-	
96975	Haliburton Highlands Secondary School	1	128	GIRLS WASHROOM 2	No	No	WL	PL		N/D	-	-	V/C 21-BS-06	-	-	-	-	-	
96976	Haliburton Highlands Secondary School	1	128	GIRLS WASHROOM 2	Yes	Yes	FTG	PI-PC		35% CHRYSOTILE	8	G	V/C 21-BS-02	-	-	D	-	-	
96972	Haliburton Highlands Secondary School	1	129	CUSTODIAL ROOM	Yes	No	CL	TRANSITE		VISUALLY ACM	60 SF	G	-	-	-	C	-	-	
96973	Haliburton Highlands Secondary School	1	129	CUSTODIAL ROOM	No	No	WL	PL		N/D	-	-	V/C 21-BS-06	-	-	-	-	-	
96971	Haliburton Highlands Secondary School	1	130	STAFF WASHROOM	No	No	CL	PL		N/D	-	-	V/C 21-BS-06	-	-	-	-	-	
96968	Haliburton Highlands Secondary School	1	131	HALLWAY 8	No	No	CL	CT	2	N/D	-	-	V/C 21-BS-09	-	-	-	-	-	
96969	Haliburton Highlands Secondary School	1	131	HALLWAY 8	No	No	WL	PL		N/D	-	-	V/C 21-BS-06	-	-	-	-	-	
96966	Haliburton Highlands Secondary School	1	132	CO-OP OFFICE	No	No	CL	CT	2	N/D	-	-	V/C 21-BS-09	-	-	-	-	-	
96967	Haliburton Highlands Secondary School	1	132	CO-OP OFFICE	No	No	WL	PL		N/D	-	-	V/C 21-BS-06	-	-	-	-	-	
96992	Haliburton Highlands Secondary School	1	133	10	No	No	FL	VFT	14	N/D	-	-	21-BS-20B	-	-	-	-	-	
96993	Haliburton Highlands Secondary School	1	133	10	No	No	CL	CT	2	N/D	-	-	V/C 21-BS-09	-	-	-	-	-	
96994	Haliburton Highlands Secondary School	1	133	10	No	No	CL	DJC		N/D	-	-	21-BS-07B	-	-	-	-	-	
96995	Haliburton Highlands Secondary School	1	133	10	No	No	WL	PL		N/D	-	-	V/C 21-BS-06	-	-	-	-	-	
96996	Haliburton Highlands Secondary School	1	134	HALLWAY 9	No	No	FL	VFT	6	N/D	-	-	21-BS-21C	-	-	-	-	-	
96997	Haliburton Highlands Secondary School	1	134	HALLWAY 9	No	No	CL	CT	2	N/D	-	-	V/C 21-BS-09	-	-	-	-	-	
96998	Haliburton Highlands Secondary School	1	134	HALLWAY 9	No	No	WL	PL		N/D	-	-	V/C 21-BS-06	-	-	-	-	-	
97040	Haliburton Highlands Secondary School	1	134A	CUSTODIAN CLOSET 4	Suspect	-	-	-	-	-	-	-	-	-	-	-	-	-	NOT SURVEYED - NO ACCESS W/ MASTER KEY
97009	Haliburton Highlands Secondary School	1	135	BOYS CHANGEROOM 1	No	No	FL	VFT	6	N/D	-	-	V/C 21-BS-21	-	-	-	-	-	
97010	Haliburton Highlands Secondary School	1	135	BOYS CHANGEROOM 1	No	No	CL	CT	2	N/D	-	-	V/C 21-BS-09	-	-	-	-	-	
97011	Haliburton Highlands Secondary School	1	135	BOYS CHANGEROOM 1	No	No	WL	PL		N/D	-	-	V/C 21-BS-06	-	-	-	-	-	
97012	Haliburton Highlands Secondary School	1	136	BOYS CHANGEROOM 2	No	No	FL	VFT	6	N/D	-	-	V/C 21-BS-21	-	-	-	-	-	
97013	Haliburton Highlands Secondary School	1	136	BOYS CHANGEROOM 2	No	No	CL	CT	2	N/D	-	-	V/C 21-BS-09	-	-	-	-	-	
97014	Haliburton Highlands Secondary School	1	136	BOYS CHANGEROOM 2	No	No	WL	PL		N/D	-	-	V/C 21-BS-06	-	-	-	-	-	
97005	Haliburton Highlands Secondary School	1	137	GYM LOBBY	No	No	FL	VFT	6	N/D	-	-	V/C 21-BS-21	-	-	-	-	-	
97006	Haliburton Highlands Secondary School	1	137	GYM LOBBY	No	Yes	CL	TF	2	N/D	-	-	21-BS-05C-E	-	-	-	-	-	
97007	Haliburton Highlands Secondary School	1	137	GYM LOBBY	No	No	CL	CT	2	N/D	-	-	V/C 21-BS-09	-	-	-	-	-	
97008	Haliburton Highlands Secondary School	1	137	GYM LOBBY	No	No	WL	PL		N/D	-	-	V/C 21-BS-06	-	-	-	-	-	
97032	Haliburton Highlands Secondary School	1	137A	STAIRWELL EAST	No	No	FL	VFT	5	N/D	-	-	21-BS-20A-C	-	-	-	-	-	
97033	Haliburton Highlands Secondary School	1	137A	STAIRWELL EAST	No	Yes	CL	TF	2	N/D	-	-	21-BS-05A,B	-	-	-	-	-	
97015	Haliburton Highlands Secondary School	1	138	GYM	No	Yes	CL	TF	2	N/D	-	-	V/C 21-BS-05	-	-	-	-	-	
97039	Haliburton Highlands Secondary School	1	138A	GYM STORAGE 5	Suspect	-	-	-	-	-	-	-	-	-	-	-	-	-	NOT SURVEYED - NO ACCESS W/ MASTER KEY
97038	Haliburton Highlands Secondary School	1	138C	GYM STORAGE 4	Suspect	-	-	-	-	-	-	-	-	-	-	-	-	-	NOT SURVEYED - NO ACCESS W/ MASTER KEY



STRUCTURAL ELEMENT				ACCESSIBILITY				TERMINOLOGY							
RF: Roof	BL: Beams/Joints	CB: Chalkboard		A: All occupants of the facility				ACM: Asbestos Containing Material	N/A: Not Applicable	PL: Plaster	TB: Transite Board	VSF: Vinyl Sheet Flooring			
WN: Window	CL: Ceiling	PL: Pipe		B: Maintenance staff without a ladder				CT: Ceiling Tile	N/Anc: Not Analyzed	RM: Roofing Materials	TP: Transite Pipe	VC: Visually Consistent w/ Other Sampled Material			
FL: Floor	OT: Duct	BL: Boiler		C: Maintenance staff with a ladder, exposed to view without moving building components				DUC: Drywall Joint Compound	N/D: None Detected	SFP: Sprayed Fireproofing	VI: Vermiculite Insulation	WC: Window Caulking			
WL: Wall	MC: Mechanical			D: Maintenance staff with a ladder, concealed from view by building components				FTG: Fitting	PI-AC: Pipe Insulation - Ancel	SF: Square Feet	VFT: Vinyl Floor Tile				
DK: Deck				E: No access without demolition or removal of fixed building components or systems				LP: Linear Feet	PI-PC: Pipe Insulation-Parging Cement	TF: Texture Finish					
								MA: Mastic	PI-CP: Pipe Insulation-Capsite						
								CONDITION G: Good F: Fair P: Poor							

ID	Facility	Floor #	Room #	Room name	Has ACM	Friable	Struct. Elem.	Application	Material	Type	Total Qty	Condition	Sample #	Action	Ref #	Comments 1	Comments 2	Comments 3	Notes
87037	Haliburton Highlands Secondary School	1	138E	GYM STORAGE 3	Suspect	-	-	-	-	-	-	-	-	-	-	-	-	-	NOT SURVEYED - NO ACCESS W/ MASTER KEY
87036	Haliburton Highlands Secondary School	1	138F	GYM STORAGE 2	Suspect	-	-	-	-	-	-	-	-	-	-	-	-	-	NOT SURVEYED - NO ACCESS W/ MASTER KEY
87035	Haliburton Highlands Secondary School	1	138G	FEMALE STAFF CHANGEROOM	Suspect	-	-	-	-	-	-	-	-	-	-	-	-	-	NOT SURVEYED - NO ACCESS W/ MASTER KEY
87016	Haliburton Highlands Secondary School	1	138H	GYM STORAGE 1	No	No	FL	VFT	6	N/D	-	-	V/C 21-BS-21	-	-	-	-	-	
87017	Haliburton Highlands Secondary School	1	138H	GYM STORAGE 1	No	Yes	DBJ	SFP	6	N/D	-	-	V/C 21-BS-03	-	-	-	-	-	
87034	Haliburton Highlands Secondary School	1	139	STAIRWELL WEST	No	No	FL	VFT	6	N/D	-	-	21-BS-21B	-	-	-	-	-	
86999	Haliburton Highlands Secondary School	1	140	GIRLS CHANGEROOM 1	No	No	FL	VFT	6	N/D	-	-	V/C 21-BS-21	-	-	-	-	-	
87000	Haliburton Highlands Secondary School	1	140	GIRLS CHANGEROOM 1	No	No	CL	CT	2	N/D	-	-	V/C 21-BS-09	-	-	-	-	-	
87001	Haliburton Highlands Secondary School	1	140	GIRLS CHANGEROOM 1	No	No	WL	PL	2	N/D	-	-	V/C 21-BS-06	-	-	-	-	-	
87002	Haliburton Highlands Secondary School	1	141	GIRLS CHANGEROOM 2	No	No	FL	VFT	6	N/D	-	-	V/C 21-BS-21	-	-	-	-	-	
87003	Haliburton Highlands Secondary School	1	141	GIRLS CHANGEROOM 2	No	No	CL	CT	2	N/D	-	-	V/C 21-BS-09	-	-	-	-	-	
87004	Haliburton Highlands Secondary School	1	141	GIRLS CHANGEROOM 2	No	No	WL	PL	2	N/D	-	-	V/C 21-BS-06	-	-	-	-	-	
86964	Haliburton Highlands Secondary School	1	142	11	No	Yes	PI	PI-PC	1	15% CHRYSOTILE	-	-	14398-20-PR2-02A-C	-	-	-	-	-	Removed
86965	Haliburton Highlands Secondary School	1	142	11	No	Yes	FTG	PI-PC	1	35% CHRYSOTILE	-	-	21-BS-02A	-	-	-	-	-	~90 Parging Cement Fittings Removed Summer 2013
86961	Haliburton Highlands Secondary School	1	143	12	No	Yes	FTG	PI-PC	1	35% CHRYSOTILE	-	-	21-BS-02B	-	-	-	-	-	Removed
86962	Haliburton Highlands Secondary School	1	143	12	No	Yes	PI	PI-PC	1	15% CHRYSOTILE	-	-	14398-20-PR2-02A-C	-	-	-	-	-	Removed
86963	Haliburton Highlands Secondary School	1	143	12	No	Yes	PI	PI-PC	1	15% CHRYSOTILE	-	-	V/C 14398-20-PR2-02A	-	-	-	-	-	Removed
86932	Haliburton Highlands Secondary School	1	144	13	No	Yes	FTG	PI-PC	1	35% CHRYSOTILE	-	-	V/C 21-BS-02	-	-	-	-	-	Abated 2016.
86933	Haliburton Highlands Secondary School	1	145	15	No	No	EL	VFT	4	N/D	-	-	21-BS-19A-C	-	-	-	-	-	
86934	Haliburton Highlands Secondary School	1	145	15	No	No	CL	CT	2	N/D	-	-	V/C 21-BS-09	-	-	-	-	-	
86935	Haliburton Highlands Secondary School	1	145	15	No	No	WL	DUC	2	N/D	-	-	V/C 21-BS-07	-	-	-	-	-	
86936	Haliburton Highlands Secondary School	1	145	15	No	Yes	PI	PI-PC	1	15% CHRYSOTILE	-	-	V/C 14398-20-PR2-02A	-	-	-	-	-	Removed
86937	Haliburton Highlands Secondary School	1	145	15	No	Yes	FTG	PI-PC	1	35% CHRYSOTILE	-	-	V/C 21-BS-02	-	-	-	-	-	REMOVED
86944	Haliburton Highlands Secondary School	1	146	HALLWAY 6	No	No	CL	CT	2	N/D	-	-	21-BS-09C	-	-	-	-	-	
86945	Haliburton Highlands Secondary School	1	146	HALLWAY 7	No	No	CL	CT	6	2% AMOSITE	-	-	21-BS-13B	-	-	-	-	-	2200SF removed 2014 (Maple Report 14419)
86946	Haliburton Highlands Secondary School	1	146	HALLWAY 7	No	No	WL	PL	2	N/D	-	-	V/C 21-BS-06	-	-	-	-	-	
86917	Haliburton Highlands Secondary School	1	148	18	No	No	EL	VFT	13	N/D	-	-	21-BS-28A	-	-	-	-	-	
86918	Haliburton Highlands Secondary School	1	148	18	No	No	CL	CT	2	N/D	-	-	V/C 21-BS-09	-	-	-	-	-	
86919	Haliburton Highlands Secondary School	1	148	18	No	No	CL	CT	6	2% AMOSITE	-	-	V/C 21-BS-13	-	-	-	-	-	200 SF removed 2014 (Maple Report 14419)
86920	Haliburton Highlands Secondary School	1	148	18	No	No	WL	DUC	2	N/D	-	-	V/C 21-BS-07	-	-	-	-	-	
86921	Haliburton Highlands Secondary School	1	148	18	No	No	WL	CT	6	2% AMOSITE	-	-	V/C 21-BS-13	-	-	-	-	-	80 SF removed 2014 (Maple Report 14419)
86912	Haliburton Highlands Secondary School	1	149	19	No	No	FL	VFT	13	N/D	-	-	21-BS-28B	-	-	-	-	-	
86913	Haliburton Highlands Secondary School	1	149	19	No	No	CL	CT	2	N/D	-	-	V/C 21-BS-09	-	-	-	-	-	
86914	Haliburton Highlands Secondary School	1	149	19	No	No	CL	CT	6	2% AMOSITE	-	-	V/C 21-BS-13	-	-	-	-	-	900 SF removed 2014 (Maple Report 14419)
86915	Haliburton Highlands Secondary School	1	149	19	No	No	WL	DUC	2	N/D	-	-	V/C 21-BS-07	-	-	-	-	-	
86916	Haliburton Highlands Secondary School	1	149	19	No	No	WL	CT	6	2% AMOSITE	-	-	V/C 21-BS-13	-	-	-	-	-	80 SF removed 2014 (Maple Report 14419)
86897	Haliburton Highlands Secondary School	1	150	HALLWAY 5	No	No	CL	CT	2	N/D	-	-	V/C 21-BS-09	-	-	-	-	-	
86898	Haliburton Highlands Secondary School	1	150	HALLWAY 5	No	No	CL	CT	6	2% AMOSITE	-	-	V/C 21-BS-13	-	-	-	-	-	1400SF removed 2014 (Maple Report 14419)
86899	Haliburton Highlands Secondary School	1	150	HALLWAY 5	No	No	WL	DUC	2	N/D	-	-	V/C 21-BS-07	-	-	-	-	-	
87052	Haliburton Highlands Secondary School	1	150	HALLWAY 5	Yes	Yes	FTG	PI-PC	6	35% CHRYSOTILE	10	-	-	-	-	-	-	-	19662
87053	Haliburton Highlands Secondary School	1	150	HALLWAY 5	Yes	Yes	PI	PI-PC	6	15% CHRYSOTILE	300	-	-	-	-	-	-	-	19662
86907	Haliburton Highlands Secondary School	1	151	20	No	No	FL	VFT	13	N/D	-	-	21-BS-28C	-	-	-	-	-	
86908	Haliburton Highlands Secondary School	1	151	20	No	No	CL	CT	2	N/D	-	-	V/C 21-BS-09	-	-	-	-	-	
86909	Haliburton Highlands Secondary School	1	151	20	No	No	CL	CT	6	2% AMOSITE	-	-	V/C 21-BS-13	-	-	-	-	-	900 SF removed 2014 (Maple Report 14419)
86910	Haliburton Highlands Secondary School	1	151	20	No	No	WL	PL	2	N/D	-	-	21-BS-06G	-	-	-	-	-	
86911	Haliburton Highlands Secondary School	1	151	20	No	No	WL	CT	6	2% AMOSITE	-	-	V/C 21-BS-13	-	-	-	-	-	80 SF removed 2014 (Maple Report 14419)
86888	Haliburton Highlands Secondary School	1	152	HALLWAY 6	No	No	CL	CT	1	N/D	-	-	V/C 21-BS-08	-	-	-	-	-	
86889	Haliburton Highlands Secondary School	1	152	HALLWAY 6	No	No	CL	DUC	2	N/D	-	-	V/C 21-BS-07	-	-	-	-	-	
86890	Haliburton Highlands Secondary School	1	152	HALLWAY 6	No	No	WL	DUC	2	N/D	-	-	V/C 21-BS-07	-	-	-	-	-	
86895	Haliburton Highlands Secondary School	1	154	OFFICE 21	No	No	CL	CT	1	N/D	-	-	V/C 21-BS-08	-	-	-	-	-	
86896	Haliburton Highlands Secondary School	1	154	OFFICE 21	No	No	WL	DUC	2	N/D	-	-	21-BS-07A	-	-	-	-	-	
86893	Haliburton Highlands Secondary School	1	155	LIBRARY	No	No	CL	CT	1	N/D	-	-	V/C 21-BS-08	-	-	-	-	-	
86894	Haliburton Highlands Secondary School	1	155	LIBRARY	No	No	WL	DUC	2	N/D	-	-	V/C 21-BS-07	-	-	-	-	-	
86891	Haliburton Highlands Secondary School	1	156	LIBRARY OFFICE 1	No	No	CL	CT	1	N/D	-	-	21-BS-08A	-	-	-	-	-	
86892	Haliburton Highlands Secondary School	1	156	LIBRARY OFFICE 1	No	No	WL	DUC	2	N/D	-	-	V/C 21-BS-07	-	-	-	-	-	
86900	Haliburton Highlands Secondary School	1	157	26	No	No	FL	VFT	12	N/D	-	-	V/C 21-BS-27	-	-	-	-	-	
86901	Haliburton Highlands Secondary School	1	157	26	No	No	CL	CT	2	N/D	-	-	V/C 21-BS-09	-	-	-	-	-	
86902	Haliburton Highlands Secondary School	1	157	26	No	No	CL	PL	2	N/D	-	-	V/C 21-BS-06	-	-	-	-	-	
86903	Haliburton Highlands Secondary School	1	157	26	No	No	WL	DUC	2	N/D	-	-	V/C 21-BS-07	-	-	-	-	-	
86904	Haliburton Highlands Secondary School	1	158	MATH OFFICE	No	No	FL	VFT	3	N/D	-	-	21-BS-18A-C	-	-	-	-	-	
86905	Haliburton Highlands Secondary School	1	158	MATH OFFICE	No	No	CL	DUC	2	N/D	-	-	V/C 21-BS-07	-	-	-	-	-	
86906	Haliburton Highlands Secondary School	1	158	MATH OFFICE	No	No	WL	DUC	2	N/D	-	-	V/C 21-BS-07	-	-	-	-	-	
86929	Haliburton Highlands Secondary School	1	159	BOYS WASHROOM 3	No	No	CL	PL	2	N/D	-	-	V/C 21-BS-06	-	-	-	-	-	
86930	Haliburton Highlands Secondary School	1	159	BOYS WASHROOM 3	No	No	WL	PL	2	N/D	-	-	V/C 21-BS-06	-	-	-	-	-	
86927	Haliburton Highlands Secondary School	1	160	GIRLS WASHROOM 3	No	No	CL	PL	2	N/D	-	-	V/C 21-BS-06	-	-	-	-	-	
86928	Haliburton Highlands Secondary School	1	160	GIRLS WASHROOM 3	No	No	WL	PL	2	N/D	-	-	V/C 21-BS-06	-	-	-	-	-	
86922	Haliburton Highlands Secondary School	1	161	17	No	No	FL	VFT	14	N/D	-	-	21-BS-29A	-	-	-	-	-	
86923	Haliburton Highlands Secondary School	1	161	17	No	No	CL	CT	2	N/D	-	-	V/C 21-BS-09	-	-	-	-	-	
86924	Haliburton Highlands Secondary School	1	161	17	No	No	CL	CT	6	2% AMOSITE	-	-	V/C 21-BS-13	-	-	-	-	-	900 SF removed 2014 (Maple Report 14419)
86925	Haliburton Highlands Secondary School	1	161	17	No	No	WL	DUC	2	N/D	-	-	V/C 21-BS-07	-	-	-	-	-	
86926	Haliburton Highlands Secondary School	1	161	17	No	No	WL	CT	6	2% AMOSITE	-	-	V/C 21-BS-13	-	-	-	-	-	100 SF removed 2014 (Maple Report 14419)
86866	Haliburton Highlands Secondary School	1	161	SCIENCE ROOM 3	No	No	FL	VFT	12	N/D	-	-	V/C 21-BS-27	-	-	-	-	-	
86867	Haliburton Highlands Secondary School	1	161	SCIENCE ROOM 3	No	No	CL	PL	2	N/D	-	-	V/C 21-BS-06	-	-	-	-	-	
86868	Haliburton Highlands Secondary School	1	161	SCIENCE ROOM 3	No	No	CL	CT	8	N/D	-	-	-	-	-	-	-	-	VERBALLY NON-ACM - BUILDING DATE OF WING
86861	Haliburton Highlands Secondary School	1	162	SCIENCE OFFICE 1	No	No	FL	VFT	12	N/D	-	-	V/C 21-BS-27	-	-	-	-	-	



STRUCTURAL ELEMENT		ACCESSIBILITY		TERMINOLOGY					
RF: Roof	B/L: Beams/Joints	A: All occupants of the facility	B/L: Beams/Joints	ACM: Asbestos Containing Material	N/A: Not Applicable	PL: Plaster	TB: Transite Board	VSF: Vinyl Sheet Flooring	
WN: Window	CB: Chalkboard	B: Maintenance staff without a ladder	CB: Chalkboard	CT: Ceiling Tile	N/Az: Not Analyzed	RM: Roofing Materials	TP: Transite Pipe	V/C: Visually Consistent w/ Other Sampled Material	
FL: Floor	Pl: Pipe	C: Maintenance staff with a ladder, exposed to view without moving building components	Pl: Pipe	DJC: Drywall Joint Compound	N/D: None Detected	SFP: Sprayed Fireproofing	VI: Vermiculite Insulation	WC: Window Caulking	
CL: Ceiling	DT: Duct	D: Maintenance staff with a ladder, concealed from view by building components	DT: Duct	FTG: Filling	PI-AC: Pipe Insulation - Ancel	SP: Square Feet	VFT: Vinyl Floor Tile		
WL: Wall	BL: Boiler	E: No access without demolition or removal of fixed building components or systems	BL: Boiler	LP: Linear Feet	PI-PC: Pipe Insulation-Parging Cement	TF: Texture Finish			
DK: Deck	MC: Mechanical		MC: Mechanical	MA: Mastic	PI-CP: Pipe Insulation-Capsote				
				CONDITION					
				G: Good F: Fair P: Poor					

ID	Facility	Floor #	Room #	Room name	Has ACM	Friable	Struct. Elem.	Application	Material	Type	Total Qty	Condition	Sample #	Action	Ref #	Comments 1	Comments 2	Comments 3	Notes
96882	Haliburton Highlands Secondary School	1	162	SCIENCE OFFICE 1	No	No	CL	CT	4	N/D	-	-	V/C 21-B5-11	-	-	-	-	-	
96883	Haliburton Highlands Secondary School	1	162	SCIENCE OFFICE 1	No	No	CL	DJC		N/D	-	-	V/C 21-B5-07	-	-	-	-	-	
96947	Haliburton Highlands Secondary School	1	163	16	No	No	FL	VFT	14	N/D	-	-	V/C 21-B5-29	-	-	-	-	-	
96948	Haliburton Highlands Secondary School	1	163	16	No	No	CL	CT	2	N/D	-	-	V/C 21-B5-09	-	-	-	-	-	
96949	Haliburton Highlands Secondary School	1	163	16	No	No	WL	PL		N/D	-	-	V/C 21-B5-06	-	-	-	-	-	
96869	Haliburton Highlands Secondary School	1	163	SCIENCE ROOM 4	No	No	FL	VFT	12	N/D	-	-	V/C 21-B5-27	-	-	-	-	-	
96870	Haliburton Highlands Secondary School	1	163	SCIENCE ROOM 4	No	No	CL	PL		N/D	-	-	V/C 21-B5-06	-	-	-	-	-	
96871	Haliburton Highlands Secondary School	1	163	SCIENCE ROOM 4	No	No	CL	CT	8	N/D	-	-		-	-	-	-	-	
96950	Haliburton Highlands Secondary School	1	164	16 STORAGE	No	No	FL	VFT	2	2% CHRYSOTILE	-	-	21-B5-17B,C	-	-	-	-	-	VERBALLY NON-ACM - BUILDING DATE OF WING July 2017 - removed
96951	Haliburton Highlands Secondary School	1	164	16 STORAGE	No	No	CL	PL		N/D	-	-	V/C 21-B5-06	-	-	-	-	-	
96872	Haliburton Highlands Secondary School	1	164	SCIENCE ROOM 5	No	No	FL	VFT	12	N/D	-	-	V/C 21-B5-27	-	-	-	-	-	
96873	Haliburton Highlands Secondary School	1	164	SCIENCE ROOM 5	No	No	CL	PL		N/D	-	-	V/C 21-B5-06	-	-	-	-	-	
96874	Haliburton Highlands Secondary School	1	164	SCIENCE ROOM 5	No	No	CL	CT	8	N/D	-	-		-	-	-	-	-	VERBALLY NON-ACM - BUILDING DATE OF WING
96952	Haliburton Highlands Secondary School	1	165	14	No	No	FL	VFT	15	N/D	-	-	21-B5-30A-C	-	-	-	-	-	
96953	Haliburton Highlands Secondary School	1	165	14	No	No	CL	CT	2	N/D	-	-	V/C 21-B5-09	-	-	-	-	-	
96954	Haliburton Highlands Secondary School	1	165	14	No	No	CL	CT	6	2% AMOSITE	-	-	V/C 21-B5-13	-	-	-	-	-	1000SF removed 2014 (Maple Report 14419)
96955	Haliburton Highlands Secondary School	1	165	14	No	No	WL	PL		N/D	-	-	V/C 21-B5-06	-	-	-	-	-	
96956	Haliburton Highlands Secondary School	1	165	14	No	No	WL	CT	6	2% AMOSITE	-	-	V/C 21-B5-13	-	-	-	-	-	1000SF removed 2014 (Maple Report 14419)
96938	Haliburton Highlands Secondary School	1	166	SHOP OFFICE	No	No	FL	VFT	2	2% CHRYSOTILE	-	-	21-B5-17A	-	-	-	-	-	July 2017 - removed
96939	Haliburton Highlands Secondary School	1	166	SHOP OFFICE	No	No	CL	PL		N/D	-	-	V/C 21-B5-06	-	-	-	-	-	
96940	Haliburton Highlands Secondary School	1	166	SHOP OFFICE	No	No	WL	PL		N/D	-	-	V/C 21-B5-06	-	-	-	-	-	
96941	Haliburton Highlands Secondary School	1	166A	SHOP OFFICE HALL	No	No	FL	VFT	1	2% CHRYSOTILE	-	-	V/C 21-B5-16	-	-	-	-	-	July 2017 - removed
96942	Haliburton Highlands Secondary School	1	166A	SHOP OFFICE HALL	No	No	CL	CT	8	2% AMOSITE	-	G	V/C 21-B5-13	-	D	-	-	-	July 2018-removed in 2018. Suspected to be concealed above drywall ceiling.
96943	Haliburton Highlands Secondary School	1	166A	SHOP OFFICE HALL	No	No	WL	PL		N/D	-	-	V/C 21-B5-06	-	-	-	-	-	
96959	Haliburton Highlands Secondary School	1	167	BUSINESS OFFICE	No	No	FL	VFT	1	2% CHRYSOTILE	-	-	21-B5-16A/C	-	-	-	-	-	Removed
96960	Haliburton Highlands Secondary School	1	167	BUSINESS OFFICE	No	No	CL	CT	3	N/D	-	-	21-B5-10A-C	-	-	-	-	-	
96878	Haliburton Highlands Secondary School	1	167	CUSTODIAN CLOSET 5	No	No	FL	VFT	8	N/D	-	-	V/C 21-B5-23	-	-	-	-	-	
96879	Haliburton Highlands Secondary School	1	167	CUSTODIAN CLOSET 5	No	No	CL	CT	4	N/D	-	-	V/C 21-B5-11	-	-	-	-	-	
96880	Haliburton Highlands Secondary School	1	167	CUSTODIAN CLOSET 5	No	No	CL	PL		N/D	-	-	V/C 21-B5-06	-	-	-	-	-	
96957	Haliburton Highlands Secondary School	1	167A	CUSTODIAN CLOSET 3	No	No	FL	VFT	1	2% CHRYSOTILE	-	-	21-B5-16B	-	-	-	-	-	Removed
96958	Haliburton Highlands Secondary School	1	167A	CUSTODIAN CLOSET 3	No	No	WL	PL		N/D	-	-	V/C 21-B5-06	-	-	-	-	-	
96970	Haliburton Highlands Secondary School	1	168	BOYS WASHROOM 2	No	No	CL	PL		N/D	-	-	V/C 21-B5-06	-	-	-	-	-	
96849	Haliburton Highlands Secondary School	1	169	ROOM 6	No	No	CL	VFT	8	N/D	-	-	V/C 21-B5-23	-	-	-	-	-	
96850	Haliburton Highlands Secondary School	1	169	ROOM 6	No	No	CL	CT	2	N/D	-	-	V/C 21-B5-09	-	-	-	-	-	
96851	Haliburton Highlands Secondary School	1	169	ROOM 6	No	No	WL	PL		N/D	-	-	V/C 21-B5-06	-	-	-	-	-	
96852	Haliburton Highlands Secondary School	1	169	ROOM 6	No	No	WL	CT	6	2% AMOSITE	-	-	V/C 21-B5-13	-	-	-	-	-	250 SF removed 2014 (Maple Report 14419)
96841	Haliburton Highlands Secondary School	1	170	ROOM 4	No	No	FL	VFT	7	N/D	-	-	21-B5-22C	-	-	-	-	-	
96842	Haliburton Highlands Secondary School	1	170	ROOM 4	No	No	CL	CT	2	N/D	-	-	V/C 21-B5-09	-	-	-	-	-	
96843	Haliburton Highlands Secondary School	1	170	ROOM 4	No	No	WL	PL		N/D	-	-	V/C 21-B5-06	-	-	-	-	-	
96844	Haliburton Highlands Secondary School	1	170	ROOM 4	No	No	WL	CT	6	2% AMOSITE	-	-	V/C 21-B5-13	-	-	-	-	-	250 SF removed 2014 (Maple Report 14419)
96833	Haliburton Highlands Secondary School	1	171	ROOM 2	No	No	FL	VFT	8	N/D	-	-	21-B5-23A	-	-	-	-	-	
96834	Haliburton Highlands Secondary School	1	171	ROOM 2	No	No	CL	CT	2	N/D	-	-	V/C 21-B5-09	-	-	-	-	-	
96835	Haliburton Highlands Secondary School	1	171	ROOM 2	No	No	WL	PL		N/D	-	-	21-B5-06D	-	-	-	-	-	
96836	Haliburton Highlands Secondary School	1	171	ROOM 2	No	No	WL	CT	6	2% AMOSITE	-	-	V/C 21-B5-13	-	-	-	-	-	250 SF removed 2014 (Maple Report 14419)
96857	Haliburton Highlands Secondary School	1	172	STAFF ROOM	No	No	FL	VFT	11	N/D	-	-	21-B5-26B-C	-	-	-	-	-	
96858	Haliburton Highlands Secondary School	1	172	STAFF ROOM	No	No	CL	CT	2	N/D	-	-	V/C 21-B5-09	-	-	-	-	-	
96859	Haliburton Highlands Secondary School	1	172	STAFF ROOM	No	No	WL	PL		N/D	-	-	V/C 21-B5-06	-	-	-	-	-	
97028	Haliburton Highlands Secondary School	1	174	HALLWAY 4	No	No	FL	VFT	6	N/D	-	-	V/C 21-B5-21	-	-	-	-	-	
97029	Haliburton Highlands Secondary School	1	174	HALLWAY 4	No	Yes	CL	TF	2	N/D	-	-	V/C 21-B505	-	-	-	-	-	
97030	Haliburton Highlands Secondary School	1	174	HALLWAY 4	No	No	CL	CT	2	N/D	-	-	V/C 21-B5-09	-	-	-	-	-	
97031	Haliburton Highlands Secondary School	1	174	HALLWAY 4	No	No	WL	PL		N/D	-	-	21-B5-06E	-	-	-	-	-	
97048	Haliburton Highlands Secondary School	1	174	HALLWAY 4	Yes	No	WL	DJC		1% CHRYSOTILE	-	G	18805E-S02B	-	A	-	-	-	Applied over smooth plaster
96798	Haliburton Highlands Secondary School	1	175	24	No	No	FL	VFT	12	N/D	-	-	V/C 21-B5-27	-	-	-	-	-	
96799	Haliburton Highlands Secondary School	1	175	24	No	No	CL	CT	2	N/D	-	-	V/C 21-B5-09	-	-	-	-	-	
96800	Haliburton Highlands Secondary School	1	175	24	No	No	WL	PL		N/D	-	-	V/C 21-B5-06	-	-	-	-	-	
96801	Haliburton Highlands Secondary School	1	175	24	No	No	WL	CT	6	2% AMOSITE	-	-	V/C 21-B5-13	-	-	-	-	-	Removed 2013
96802	Haliburton Highlands Secondary School	1	176	22	No	No	CL	CT	2	N/D	-	-	V/C 21-B5-09	-	-	-	-	-	
96803	Haliburton Highlands Secondary School	1	176	22	No	No	WL	PL		N/D	-	-	V/C 21-B5-06	-	-	-	-	-	
96931	Haliburton Highlands Secondary School	1	177	CUSTODIAN CLOSET 2	No	No	CL	PL		N/D	-	-	V/C 21-B5-06	-	-	-	-	-	
96804	Haliburton Highlands Secondary School	1	178	23	No	No	CL	CT	2	N/D	-	-	21-B5-09B	-	-	-	-	-	
96805	Haliburton Highlands Secondary School	1	178	23	No	No	CL	CT	6	2% AMOSITE	-	-	V/C 21-B5-13	-	-	-	-	-	960 SF removed 2014 (Maple Report 14419)
96806	Haliburton Highlands Secondary School	1	178	23	No	No	WL	PL		N/D	-	-	V/C 21-B5-06	-	-	-	-	-	
96807	Haliburton Highlands Secondary School	1	178	23	No	No	WL	CT	6	2% AMOSITE	-	-	V/C 21-B5-13	-	-	-	-	-	275 SF removed 2014 (Maple Report 14419)
96808	Haliburton Highlands Secondary School	1	178	23	No	No	CL	MASTIC		N/D	-	-	21-B5-14C	-	-	-	-	-	
96717	Haliburton Highlands Secondary School	1	179	MAIN OFFICE 2	No	No	CL	CT	4	N/D	-	-	V/C 21-B5-11	-	-	-	-	-	
96718	Haliburton Highlands Secondary School	1	179	MAIN OFFICE 2	No	No	CL	CT	2	N/D	-	-	V/C 21-B5-09	-	-	-	-	-	
96719	Haliburton Highlands Secondary School	1	179	MAIN OFFICE 2	No	No	CL	PL		N/D	-	-	V/C 21-B5-06	-	-	-	-	-	
96720	Haliburton Highlands Secondary School	1	179	MAIN OFFICE 2	No	No	WL	DJC		N/D	-	-	V/C 21-B5-07	-	-	-	-	-	
96721	Haliburton Highlands Secondary School	1	179A	BARRIER FREE WASHROOM	No	No	FL	VFT	5	N/D	-	-	V/C 21-B5-20	-	-	-	-	-	
96722	Haliburton Highlands Secondary School	1	179A	BARRIER FREE WASHROOM	No	No	CL	CT	4	N/D	-	-	V/C 21-B5-11	-	-	-	-	-	
96723	Haliburton Highlands Secondary School	1	179A	BARRIER FREE WASHROOM	No	No	CL	PL		N/D	-	-	V/C 21-B5-06	-	-	-	-	-	
96724	Haliburton Highlands Secondary School	1	179A	BARRIER FREE WASHROOM	No	No	WL	DJC		N/D	-	-	V/C 21-B5-07	-	-	-	-	-	
96725	Haliburton Highlands Secondary School	1	179B	OFFICE KITCHEN	No	No	FL	VFT	5	N/D	-	-	V/C 21-B5-20	-	-	-	-	-	
96726	Haliburton Highlands Secondary School	1	179B	OFFICE KITCHEN	No	No	CL	CT	4	N/D	-	-	V/C 21-B5-11	-	-	-	-	-	
96727	Haliburton Highlands Secondary School	1	179B	OFFICE KITCHEN	No	No	CL	PL		N/D	-	-	V/C 21-B5-06	-	-	-	-	-	



STRUCTURAL ELEMENT			ACCESSIBILITY			TERMINOLOGY														
RF: Roof	BL: Beams/Joints		A: All occupants of the facility			ACM: Asbestos Containing Material		N/A: Not Applicable		PL: Plaster		TB: Transite Board		VSF: Vinyl Sheet Flooring						
WN: Window	CB: Chalkboard		B: Maintenance staff without a ladder			CT: Ceiling Tile		N/A/Nz: Not Analyzed		RM: Roofing Materials		TP: Transite Pipe		V/C: Visually Consistent w/ Other Sampled Material						
FL: Floor	CP: Pipe		C: Maintenance staff with a ladder, exposed to view without moving building components			DJC: Drywall Joint Compound		N/D: None Detected		SFP: Sprayed Fireproofing		VI: Vermiculite Insulation		WC: Window Caulking						
CL: Ceiling	DT: Duct		D: Maintenance staff with a ladder, concealed from view by building components			FTG: Fitting		PI-AC: Pipe Insulation - Ancell		SF: Square Feet		VFT: Vinyl Floor Tile								
WL: Wall	BL: Boiler		E: No access without demolition or removal of fixed building components or systems			LF: Linear Feet		PI-PC: Pipe Insulation-Parging Cement		TF: Texture Finish										
DK: Deck	MC: Mechanical					MA: Mastic		PI-CP: Pipe Insulation-Capsote												
CONDITION G: Good F: Fair P: Poor																				
Floor #	Room #	Room name	Has ACM	Friable	Struct. Elem.	Application	Material	Type	Total Qty	Condition	Sample #	Action	Ref #	Comments 1	Comments 2	Comments 3	Notes			
1	179B	OFFICE KITCHEN	No	No	WL	DJC		N/D	-	-	V/C 21-BS-07			-						
1	180	MAIN OFFICE 1	No	No	CL	CT	4	N/D	-	-	21-BS-11A			-						
1	180	MAIN OFFICE 1	No	No	CL	CT	2	N/D	-	-	V/C 21-BS-09			-						
1	180	MAIN OFFICE 1	No	No	CL	PL		N/D	-	-	V/C 21-BS-06			-						
1	180	MAIN OFFICE 1	No	No	WL	DJC		N/D	-	-	21-BS-07G			-						
1	181	BOILER ROOM 1	No	No	CL	PL		N/D	-	-	21-BS-06C			-						
1	182	OPP 5	No	No	CL	CT	4	N/D	-	-	V/C 21-BS-11			-						
1	182	OPP 5	No	No	WL	DJC		N/D	-	-	V/C 21-BS-07			-						
1	183	OPP 2	No	No	CL	CT		N/D	-	-	V/C 21-BS-11			-						
1	183	OPP 2	No	No	WL	DJC		N/D	-	-	V/C 21-BS-07			-						
1	183A	OPP 4	No	No	CL	CT	4	N/D	-	-	V/C 21-BS-11			-						
1	183A	OPP 4	No	No	WL	DJC		N/D	-	-	V/C 21-BS-07			-						
1	183B	OPP 3	No	No	CL	CT	3	N/D	-	-	V/C 21-BS-11			-						
1	183B	OPP 3	No	No	WL	DJC		N/D	-	-	V/C 21-BS-07			-						
1	184	OPP 1	No	No	CL	PL		N/D	-	-	V/C 21-BS-06			-						
1	184	OPP 1	No	No	WL	DJC		N/D	-	-	V/C 21-BS-07			-						
1	185	GREEN HOUSE	-	-	-	-	-	-	-	-	-			-						
1	186	HALLWAY 10	No	No	FL	VFT	12	N/D	-	-	V/C 21-BS-27			-						
1	186	HALLWAY 10	No	No	CL	CT	4	N/D	-	-	V/C 21-BS-11			-						
1	186	HALLWAY 10	No	No	CL	PL		N/D	-	-	V/C 21-BS-06			-						
1	187	SCIENCE ROOM 1	No	No	FL	VFT	12	N/D	-	-	V/C 21-BS-27			-						
1	187	SCIENCE ROOM 1	No	No	CL	PL		N/D	-	-	V/C 21-BS-06			-						
1	187	SCIENCE ROOM 1	No	No	CL	CT	3	N/D	-	-	-			-				VERBALLY NON-ACM - BUILDING DATE OF WING		
1	188	SCIENCE OFFICE 2	No	No	FL	VFT	12	N/D	-	-	V/C 21-BS-27			-						
1	188	SCIENCE OFFICE 2	No	No	CL	CT	4	N/D	-	-	V/C 21-BS-11			-						
1	188	SCIENCE OFFICE 2	No	No	CL	DJC		N/D	-	-	V/C 21-BS-07			-						
1	188	SCIENCE ROOM 2	No	No	FL	VFT	12	N/D	-	-	V/C 21-BS-27			-						
1	189	SCIENCE ROOM 2	No	No	CL	PL		N/D	-	-	V/C 21-BS-06			-						
1	189	SCIENCE ROOM 2	No	No	CL	CT	8	N/D	-	-	-			-				VERBALLY NON-ACM - BUILDING DATE OF WING		
1	207	GYM-CUSTODIAN	No	No	FL	VFT	6	N/D	-	-	V/C 21-BS-21			-						
1	207	GYM-CUSTODIAN	No	Yes	DBJ	SFP		N/D	-	-	V/C 21-BS-03			-						
1	209	CLASS G23	No	No	FL	VFT	14	N/D	-	-	V/C 21-BS-29			-						
1	209	CLASS G23	No	No	CL	CT	2	N/D	-	-	V/C 21-BS-09			-						
2	202	WEIGHT ROOM	No	No	FL	VFT	6	N/D	-	-	21-BS-21A			-						
2	202	WEIGHT ROOM	No	Yes	DBJ	SFP		N/D	-	-	21-BS-03A-G			-						
2	203	AEROBICS	No	No	CL	CT	2	N/D	-	-	V/C 21-BS-09			-						
2	204	GYM MECHANICAL 2	No	No	WL	DJC		N/D	-	-	V/C 21-BS-07			-						
2	204	GYM MECHANICAL 2	No	Yes	DBJ	SFP		N/D	-	-	21-BS-03D			-						
2	205	CLASS G21	No	No	CL	CT	2	N/D	-	-	V/C 21-BS-09			-						
2	211	SCIENCE ATTIC	Suspect	-	-	-	-	-	-	-	-			-				NOT SURVEYED - ACCESS POINT NOT FOUND		
2	212	NORTH ATTIC	Suspect	-	-	-	-	-	-	-	-			-				NOT SURVEYED - ACCESS POINT NOT FOUND		
2	213	EAST ATTIC	Yes	No	WL	TB		VISUALLY ACM	400 SF	-	-			-						
2	213	EAST ATTIC	Yes	No	CL	TB		VISUALLY ACM	300 SF	-	-			-						

PREVIEW

APPENDIX II

DRAWINGS

YOU MUST BE A REGISTERED PLAN TAKER
TO DOWNLOAD AN UNMARKED VERSION OF THIS FILE
WWW.BIDSANDTENDERS.COM – ORIGINAL DOCUMENT SOURCE

Please Note:
Drywall Joint Compound (DJC) applied to smooth
plaster has been identified as ASBESTOS
CONTAINING throughout the building.

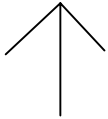

Main Building

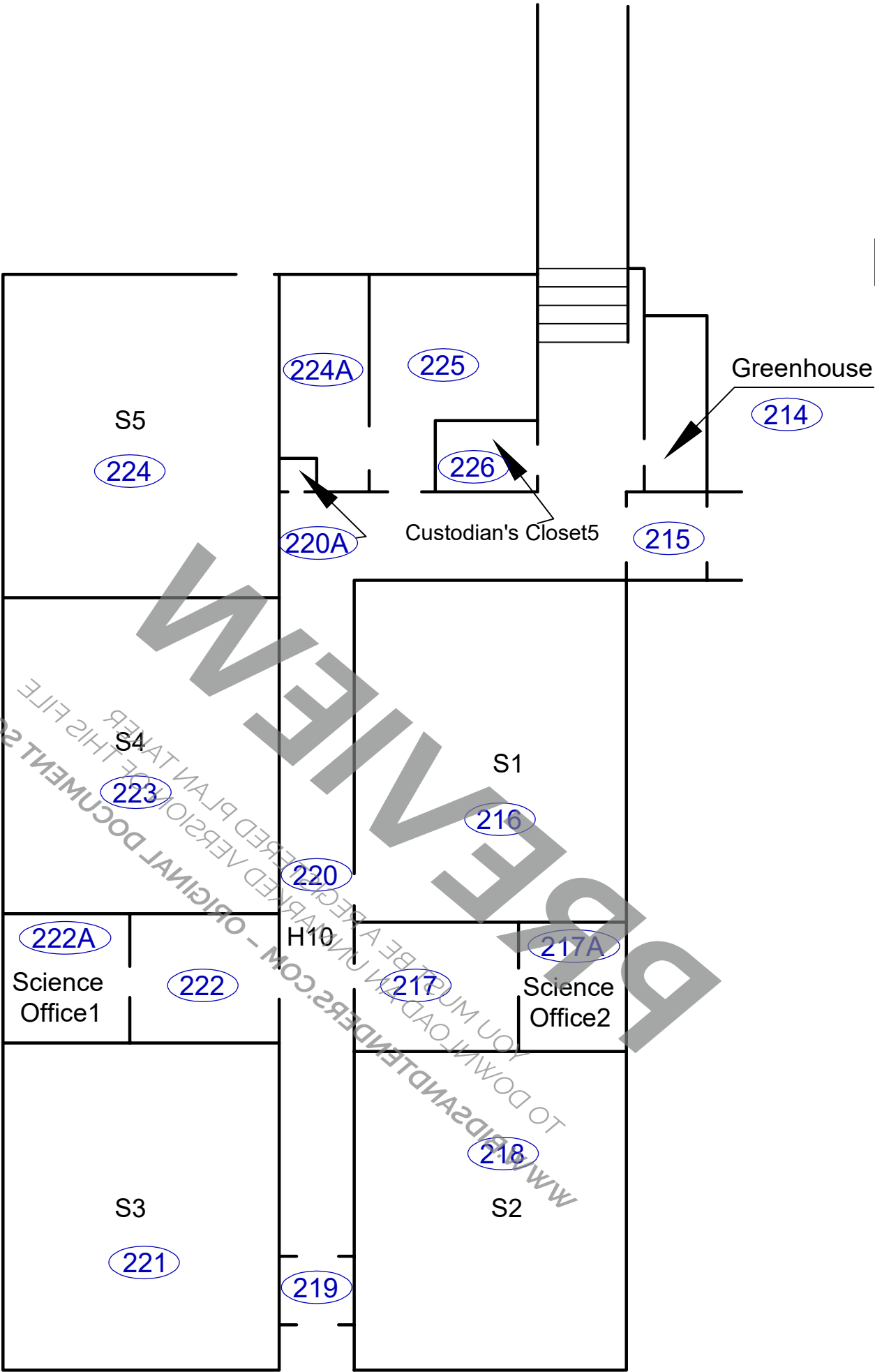

LEGEND

01-BS-01A

Jacques Whitford Sample Locations



Ebase Number



No Access

CONFIRMED ACM

SYMBOL

DESCRIPTION

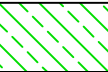

Friable Asbestos-Containing Material

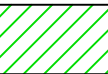

Non-Friable
Asbestos-Containing Material

PI

Pipe Insulation (Friable
Asbestos-Containing Material)

CT

Ceiling Tile (Friable
Asbestos-Containing Material)

TP/TB

Transite Pipe / Board (Non-Friable
Asbestos-Containing Material)

NOTE

Drywall Joint Compound

For Detailed Information as to Location, Type, Quantity,
Condition and Access to ACM, Please Refer to the
Room-by-Room Sheets Provided in the Report.

Haliburton Highlands Secondary
School

HWY 121 at CTY Road 1
Haliburton, Ontario

First Floor Plan (Science Wing)

Asbestos Materials Re-Assessment Survey

CLIENT: Trillium Lakelands District School Board

PROJECT NUMBER:
21700-20

DATE:
September 2024

DRW BY:
J. Prosser

SCALE:
Not to Scale

CHK BY:
K. Prosser



MAPLE ENVIRONMENTAL INC.

ENVIRONMENT, HEALTH & SAFETY CONSULTANTS

Please Note:
Drywall Joint Compound (DJC) applied to smooth
plaster has been identified as ASBESTOS
CONTAINING throughout the building.

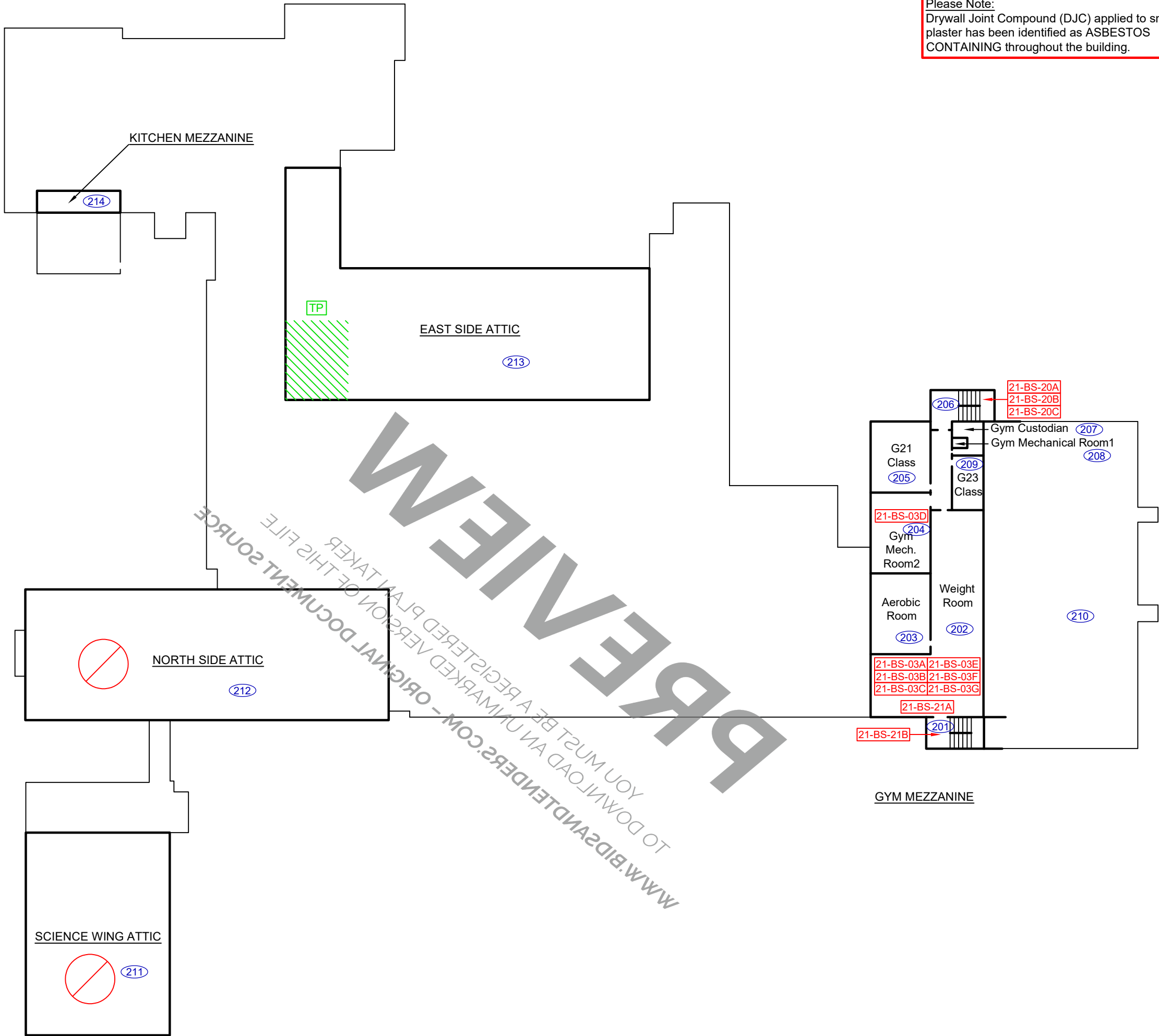

LEGEND

- 01-BS-01A Jacques Whitford Sample Locations
- # Ebase Number
- ⊘ No Access

CONFIRMED ACM

SYMBOL	DESCRIPTION
	Friable Asbestos-Containing Material
	Non-Friable Asbestos-Containing Material
PI	Pipe Insulation (Friable Asbestos-Containing Material)
CT	Ceiling Tile (Friable Asbestos-Containing Material)
TP/TB	Transite Pipe / Board (Non-Friable Asbestos-Containing Material)
NOTE	Drywall Joint Compound

For Detailed Information as to Location, Type, Quantity, Condition and Access to ACM, Please Refer to the Room-by-Room Sheets Provided in the Report.

Haliburton Highlands Secondary School
HWY 121 at CTY Road 1
Haliburton, Ontario

Mezzanine and Attic Floor Plan
Asbestos Materials Re-Assessment Survey

CLIENT: Trillium Lakelands District School Board

PROJECT NUMBER: 21700-20	DATE: September 2024	DRW BY: J. Prosser
	SCALE: Not to Scale	CHK BY: K. Prosser

APPENDIX III
POTENTIAL ASBESTOS-CONTAINING MATERIAL
IDENTIFICATION SHEET

PREVIEW

YOU MUST BE A REGISTERED PLAN TAKER
TO DOWNLOAD AN UNMARKED VERSION OF THIS FILE
WWW.BIDSANDTENDERS.COM - ORIGINAL DOCUMENT SOURCE

APPENDIX III - POTENTIAL ASBESTOS-CONTAINING MATERIALS INFORMATION SHEET

<i>MIN</i>	<i>Material</i>	<i>Material Description</i>	<i>Size</i>	<i>Sample Number</i>	<i>Sample Location</i>	<i>Asbestos Containing</i>
VFT 1	Vinyl Floor Tiles	Light beige with red smears	9 x 9	16A-C	Custodian Closet 3	2% Chrysotile
VFT 2	Vinyl Floor Tiles	Beige with red and white streaks	9 x 9	17A-C	Shop Office, Room 16	2% Chrysotile
VFT 3	Vinyl Floor Tiles	Black and beige streaks	9 x 9	18A-C	Math Office	None
VFT 4	Vinyl Floor Tiles	Grey with light and dark smears	12 x 12	19A-C	Room 15	None
VFT 5	Vinyl Floor Tiles	White with grey specks	12 x 12	20A-C	East Stairwell	None
VFT 6	Vinyl Floor Tiles	White with black specks	12 x 12	21A-C	Weight Room, West Stairwell, H9	None
VFT 7	Vinyl Floor Tiles	Grey with light and dark specks	12 x 12	22A-C	Room 5, 3 & 4	None
VFT 8	Vinyl Floor Tiles	White with black streaks	12 x 12	23A-C	Room 2, 1, Custodian Closet 1	None
VFT 9	Vinyl Floor Tiles	White with red specks	12 x 12	24A-C	Ladies Dressing Room, Room 25	None
VFT 10	Vinyl Floor Tiles	Pink with light and dark smears	12 x 12	25A-C	Resource Room, H1	None
VFT 11	Vinyl Floor Tiles	White with beige smears	12 x 12	26A-C	S3, Staff Room	None
VFT 12	Vinyl Floor Tiles	Beige with light and dark smears	12 x 12	27A-C	Resource Room, Office 1, Room 7	None
VFT 13	Vinyl Floor Tiles	White with grey smears	12 x 12	28A-C	Room 18, 19, 20	None
VFT 14	Vinyl Floor Tiles	White with blue specks	12 x 12	29A-C	Room 17, Rm 10, Men's Dressing Room	None
VFT 15	Vinyl Floor Tiles	White with red streaks	12 x 12	30A-C	Room 14	None
CT-1	Ceiling Tile	Small fissure pinhole pattern	2 x 4	08A-C	L1, 7, H1	None
CT-2	Ceiling Tile	Pinhole pattern	2 x 4	09A-C	Room 8, 27, H7	None
CT-3	Ceiling Tile	Dot pattern	2 x 4	10A-C	Business Office	None
CT-4	Ceiling Tile	Textured fissure pinhole pattern	2 x 4	11A-C	Main Office, Resource Room	None
CT-5	Ceiling Tile	Long fissure pinhole pattern	2 x 4	12A-C	Girls W/C1, Boy's W/C 1	None
CT-6	Ceiling Tile	Hole pattern	1 x 1	13A-C	Boy's W/C 1, H7, H2	2% Amosite
CT-7	Ceiling Tile	Fissure Pinhole	2 x 4	12578-01A-C	Portable One	None
CT-8	Ceiling Tile	squared pattern	2 x 2	-	-	None
TF-1	Texture Finish	Off white	N/A	04A-C	Multiple	0.5% Chrysotile
TF-2	Texture Finish	Stucco (white)	N/A	05A-C	Multiple	None
VSF-1	Vinyl Sheet Flooring	Green	N/A	15A-C	Kitchen	None