

ASBESTOS-CONTAINING BUILDING MATERIALS RE-ASSESSMENT REPORT

Fenelon Township Public School

50 Cameron Road
Cameron, Ontario

Presented to:

Trillium Lakelands District School Board

Box 420, County Road 36
Lindsay, Ontario
K9V 4S4

Attention: Daniel Whalen

September 2024

Maple Project No. 21700-32

Executive Summary

2024 Asbestos-Containing Building Materials Re-Assessment Report

Maple Project	School Name	Address
21124-32	Fenelon Township Public School	50 Cameron Road, Cameron, Ontario

Maple Environmental Inc. was retained by Trillium Lakelands District School Board to perform a re-assessment of known asbestos-containing building materials within the subject building.

The findings and recommendations of the current assessment are summarized below. Please refer to the main body of the report for details.

FINDINGS

Asbestos-containing materials (ACM) identified within the building at the time of the assessment are as follows:

ASBESTOS BUILDING MATERIALS SUMMARY								
MATERIAL		ASBESTOS			FRIABILITY		Remedial Work Required	
		Yes	No	Suspect	Friable	Non-Friable		Potentially
Sprayed Fireproofing			X		X			NO
Textured Finish			X		X			NO
Mechanical Insulations	Pipe Fittings	X			X			NO
	Pipe Straight		X		X			NO
	Ductwork		X		X			NO
	Mechanical Equip.		X		X			NO
Ceiling Tiles			X				X	NO
Vinyl Sheet Flooring			X				X	NO
Vinyl Floor Tiles		X				X		NO
Asbestos Cement (Transite)		X				X		NO
Plaster				X			X	NO
Drywall Joint Compound				X		X		NO
Other (roofing, caulking, etc.)		X		X		X		NO

Please refer to Room by Room Inventory in Appendix I to view location, quantities, and condition of ACM observed within the building at the time of the assessment.

Executive Summary

2024 Asbestos-Containing Building Materials Re-Assessment Report

RECOMMENDATIONS

As asbestos-containing materials were found to be present within the building, Ontario Regulation 278/05 requires that the Trillium Lakelands District School Board's Asbestos Management Plan must apply to this building. In addition, an annual re-assessment of all ACM must be performed.

All asbestos-containing materials identified within the building were observed to be in GOOD condition and no immediate recommendations are warranted.

General Statement

The Executive Summary must be read in conjunction with the main body of this report.

TABLE OF CONTENTS

EXECUTIVE SUMMARY	<i>i</i>
1.0 INTRODUCTION	1
2.0 APPLICABLE ONTARIO REGULATIONS.....	1
2.1 ONTARIO REGULATION 278/05 (ASBESTOS)	1
2.2 ONTARIO REGULATION 347	2
3.0 SURVEY SCOPE AND METHODOLOGY.....	2
3.1 INVENTORY METHODOLOGY.....	3
3.2 ASBESTOS ASSESSMENT CRITERIA	3
3.3 LIMITATIONS AND OMISSIONS FROM SCOPE	4
3.4 SAMPLING STRATEGY AND ANALYTICAL METHODS	5
3.5 DRAWINGS.....	6
4.0 INVENTORY FINDINGS.....	6
4.1 SPRAYED FIREPROOFING (FRIABLE)	7
4.2 THERMAL MECHANICAL INSULATION (FRIABLE)	7
4.3 TEXTURE FINISH (FRIABLE)	7
4.4 ACOUSTIC CEILING TILES (POTENTIALLY FRIABLE).....	7
4.5 VINYL SHEET FLOORING (POTENTIALLY FRIABLE)	8
4.6 VINYL FLOOR TILE (NON-FRIABLE).....	8
4.7 ASBESTOS CEMENT PRODUCTS "TRANSITE" (NON-FRIABLE)	8
4.8 DRYWALL JOINT COMPOUND (DJC)	8
4.9 PLASTER.....	8
4.10 CORRUGATED PAPER.....	8
5.0 RECOMMENDATIONS	9
5.1 GENERAL RECOMMENDATIONS	9
5.2 SPECIFIC RECOMMENDATIONS	9
6.0 LIMITATIONS.....	9
 APPENDIX I	 ROOM-BY-ROOM ASBESTOS INVENTORY
APPENDIX II	DRAWINGS
APPENDIX III	POTENTIAL ASBESTOS-CONTAINING MATERIAL IDENTIFICATION SHEET

1.0 INTRODUCTION

MAPLE Environmental Inc. ("MAPLE") was retained by the Trillium Lakelands District School Board (TLDSB) to perform a re-assessment of known asbestos-containing building materials within all TLDSB schools where asbestos was previously confirmed to be present (by others).

The assessment was completed in accordance with the requirement of Ontario Regulation 278/05 to complete a re-assessment on an annual basis.

The following report presents the findings and recommendations of the assessment for the specific building listed.

SUMMARY OF BUILDING INFORMATION	
School Name:	Fenelon Township Public School
Building Address:	50 Cameron Road, Cameron, Ontario
Number of Floors:	1 (no basement)
Approximate Square Footage:	24,500
Assessed by:	Richards Reboks
Assessment Date:	July 26, 2024

2.0 APPLICABLE ONTARIO REGULATIONS

Applicable Ontario Regulations for each of the materials included in the investigation are briefly described below.

2.1 Ontario Regulation 278/05 (Asbestos)

The Ontario Ministry of Labour Regulation 278/05 requires a detailed asbestos inventory be performed in all buildings where friable and non-friable asbestos-containing materials (ACM) are present. The inventory must be available at the work place and must identify the type and location of asbestos-containing materials on a room-by-room basis, where necessary.

Each individual building report prepared by MAPLE meets or exceeds the requirements for an asbestos survey under Ontario Regulation 278/05.

Ontario Regulation 278/05 applies to buildings with regards to maintenance, renovation or demolition work where ACM is present and may be disturbed. The regulation requires all buildings where asbestos is known to be part of the building materials to implement an Asbestos Management Program

(AMP). TLDSB has prepared and maintains an AMP of which the current Re-Assessment report is part of.

2.2 Ontario Regulation 347

Ontario Regulation 347 applies to the transport of waste from the location of generation to a landfill site authorized to receive specific wastes. The regulation also prescribes procedures on how the specific wastes are to be handled at the landfill site.

The major requirements of the building owner and the person(s) removing the waste are to ensure that:

- The waste is appropriately packaged and labelled;
- The transport vehicle is appropriately placard; and
- The waste is to be transported as directly as possible to the landfill site once it leaves the site.

Some wastes require the Owner to register a Generator (of waste) number and many wastes require classification that can restrict or even prohibit their disposal in landfill.

It is important to note that the building owner can be held responsible for the waste until the waste disposal site accepts it.

3.0 SURVEY SCOPE AND METHODOLOGY

The surveys were performed on a Room-by-Room basis within each building included in the scope of the assessment where asbestos was previously identified (by others).

The scope of the surveys included all friable and major non-friable materials suspected to contain asbestos. The term friable is applied to a material that can be readily reduced to dust or powder by hand or moderate pressure. Asbestos materials that are friable have a much greater potential to release airborne asbestos fibres when disturbed.

Typical friable asbestos materials include; sprayed fireproofing or thermal insulation, textured (stippled) plaster, and thermal mechanical insulation. Typical non-friable materials include: asbestos cement (transite) products, caulking, vinyl floor tiles, asbestos textiles and gaskets. Additional materials such as ceiling tiles and drywall joint compounds are classified as non-friable, but because of their ability to release dust when disturbed they are considered as "potentially friable" for the purpose of this report.

3.1 Inventory Methodology

In order to determine the location of the materials included in the assessment, each room or area was entered where practical (i.e.: where access was possible without the demolition of walls, roof or ceilings or destruction of flooring) where asbestos materials were previously identified. An investigation of areas of the building where asbestos was not previously identified was not included in the scope of the current project.

Representative views were made above accessible suspended ceiling systems. Drywall or plaster ceilings were accessed via existing ceiling access panels only. The inventory did not include destructive testing of building systems or finishes to observe possible hidden conditions.

3.2 Asbestos Assessment Criteria

The recommendations and suggestions made as part of this report with respect to asbestos have taken into consideration the condition and accessibility of the asbestos-containing material as well as other factors such as water damage, vibration, air movement, and general activities in the area.

Where ACM is found to be in GOOD condition and not likely to deteriorate or fall, the general recommendation would be to re-evaluate the condition of the material on an annual basis (required by Regulation 278/05). This recommendation can be subject to change if the material is located in a manner that persons untrained in asbestos awareness could physically damage it.

Where the ACM is found to be damaged (i.e. FAIR or POOR condition), a recommendation to have the material cleaned-up, repaired, removed, enclosed, or encapsulated is offered. The recommendation will also indicate which asbestos procedure should be used to perform the remedial work (i.e. Type 1, Type 2, Type 3, or Glove Bag Removal Methods).

In each area or room inventoried, the quantity, condition (GOOD, FAIR, or POOR) and accessibility (A, B, C, D or E) of each suspect material was recorded.

The definitions for condition and accessibility items are as follows:

GOOD Material is intact with no visible signs of damage.

FAIR Material is visibly damaged but can be repaired.

POOR Material is damaged beyond repair and likely needs to be removed.

Access A Accessible to all occupants of the building.

- | | |
|-----------------|--|
| Access B | Accessible to Maintenance personnel without the use of a ladder (i.e. Mechanical Room, pipe chase etc.). |
| Access C | Accessible to Maintenance personnel with the use of a ladder and is exposed to view without removing building components. |
| Access D | Accessible to Maintenance personnel with the use of a ladder and is concealed from viewing due to a building component (i.e. above a removable ceiling). |
| Access E | Not accessible without demolition of a building component (i.e. above a fixed ceiling system). |

The asbestos related information collected during the previous assessments was confirmed and the room-by-room data updated to reflect the current information.

3.3 Limitations and Omissions from Scope

Due to the nature of building construction, some limitations exist in regards to the possible thoroughness of any building materials inventory. The field observations, measurements, and analysis are considered sufficient in detail and scope to form a reasonable basis for the findings presented in this report. MAPLE warrants that the findings and conclusions contained herein have been made in accordance with generally accepted evaluation methods in the industry and applicable regulations at the time of the performance of the inventory.

It is possible that conditions may exist which could not be reasonably identified within the scope of the inventory or which were not apparent during the site investigation. MAPLE believes that the information collected during the inventory period concerning the property is reliable. No other warranties are implied or expressed.

In addition, during a standard asbestos assessment, performed for the purposes of regulatory compliance, it is industry practice to exclude some non-friable materials in the inventory. Examples of such assumptions include; elevator brakes, roofing felts and mastics, high voltage wiring, mechanical packing and gaskets, underground services or piping, fire-doors, window caulking, levelling compound, and/or materials used in operating equipment. As such, these materials were not sampled at the time of this survey and where present are assumed to be asbestos containing until proven otherwise.

3.4 Sampling Strategy and Analytical Methods

As the majority of materials were previously sampled by others, the requirement for sampling during the current survey was limited. Where samples were collected, they conformed to the criteria outlined below and in compliance with O. Reg. 278/05.

A small volume of the material was removed either from a damaged section or cut out of intact material and then repaired by sealing with tape to prevent the release of fibres. The collected samples were placed in plastic bags, sealed and labelled and then sent to an independent laboratory for analysis. To ensure quality results, the independent laboratory chosen is NVLAP accredited and successfully participates in an "Asbestos Proficiency Analytical Testing Program" and as such, these laboratories are responsible for their findings.

The collection of samples was performed in accordance with regulatory sampling requirements and with sufficient frequency to obtain a general pattern of asbestos use within the building. Due to building renovations or modifications that have occurred, the consistency of the application of asbestos materials may not be uniform throughout the entire building. It is important to note that without sampling every wall, pipe section, ceiling tile etc. it is not possible to identify the possible asbestos content in every material present in the building. For this reason, materials similar in appearance to those sampled elsewhere in the building were visually identified as being homogeneous and thus are assumed to be composed of the same material, thus additional sampling is not required.

In accordance with Reg. 278/05, samples were collected at the following frequency.

Material Type	No. Samples
Sprayed Fireproofing	Up to 7
Texture Coat	Up to 7
Pipe Fitting Insulation	3
Pipe Straight Insulation	3
Ductwork Insulation	3
Ceiling Tiles	3
Vinyl Sheeting Flooring	3
Vinyl Floor Tile	3
Plaster Finishes	Up to 7
Drywall Compound	Up to 7

An independent NVLAP accredited laboratory, was used to analyse the collected samples. Analysis was performed following the Code of Practice for the identification of asbestos in bulk material, as detailed in Ontario Regulation 278/05. Bulk samples were analysed using the Polarized Light Microscopy ("PLM") Technique with Dispersion Staining. The identification of asbestos fibre in bulk material is based on a collective set of parameters dependent on the unique shape and crystallographic properties of each fibre as viewed through the microscope. This method is useful for the qualitative identification of asbestos and the semi-quantitative determination of asbestos content in bulk materials expressed as a percent of projected area. The method identifies types of asbestos and also measures percent of asbestos as perceived by the analyst in comparison to standard area projections or trained experience.

Given the composition of some vinyl floor products, the PLM analysis method is often prone to yielding false negative analysis results. Therefore, it may be prudent that the Transmission Electron Microscopy (TEM) analysis method be used to determine the asbestos content in the vinyl floor products, if negative results are obtained from the laboratory analysis.

3.5 Drawings

Drawings provided for each building indicate the following (where present):

- ◇ Location Numbers (reference to Room-by-Room asbestos data)
- ◇ Asbestos-Containing Sprayed Fireproofing
- ◇ Asbestos-Containing Texture Finishes
- ◇ Asbestos Containing Ceiling Tiles
- ◇ Asbestos-Containing Flooring Materials
- ◇ Presence of Asbestos-Containing Mechanical Insulations will not be specifically indicated on the drawings; however, a general statement regarding the presence of ACM mechanical insulations, where present, has been indicated on the drawings.
- ◇ Presence of asbestos-containing drywall joint compound and hard plaster will not be specifically identified on the drawings; however, a general statement regarding the presence of these ACM materials, where present, has been indicated on the drawings.

4.0 INVENTORY FINDINGS

The following is a brief discussion of the extent to which Asbestos-Containing Materials (ACM) was identified in the building. The discussion is organized under the headings of materials that are generally suspected of containing asbestos. Refer to the Room-by-Room Survey Inventory in Appendix I for a detailed description and location of all ACM.

Destructive testing was not conducted and as such some areas within the building were not accessible for an assessment (i.e. above solid ceilings, behind walls). Access for viewing within wall and ceiling cavities was not always possible. Suspect asbestos materials may be present within ceiling and wall cavities that were not identified in this report. This comment is particularly important for materials such as mechanical insulation. Caution should be taken when demolishing solid wall finishes within the building.

4.1 Sprayed Fireproofing (Friable)

No sprayed fireproofing was observed in the building.

4.2 Thermal Mechanical Insulation (Friable)

Asbestos and non-asbestos mechanical insulations were identified in the building. A brief description of the insulations is provided below categorized by mechanical system type. Further, it is important to note that mechanical systems may be present within walls and ceiling cavities or pipe chases that were not accessible during this assessment. The presence of ACM mechanical insulations in these locations should be suspected.

Pipe Systems:

Pipe Fittings, including elbows, valves, tees, hangers, etc. where insulated are insulated with parging cement previously confirmed to contain Chrysotile asbestos or are insulated with non-asbestos materials (i.e. Fibreglass). All pipe fittings were found to be in GOOD condition.

Pipe Straights, where insulated are insulated with non-asbestos fibreglass and/or armaflex materials.

Ductwork:

Duct systems were either insulated with non-asbestos fibreglass or were un-insulated.

Mechanical Equipment:

Mechanical equipment was observed to be externally un-insulated.

4.3 Texture Finish (Friable)

No asbestos-containing texture finishes were identified to be present within the building.

4.4 Acoustic Ceiling Tiles (Potentially Friable)

No asbestos-containing ceiling tiles were identified to be present within the building.

4.5 Vinyl Sheet Flooring (Potentially Friable)

No asbestos-containing vinyl sheet flooring was identified to be present within the building.

4.6 Vinyl Floor Tile (Non-Friable)

Asbestos and non-asbestos vinyl floor tile systems were identified within the surveyed area at the time of the assessment.

As noted during the current re-assessment survey, 9"x9" vinyl floor tiles are present throughout the building. Historically, 9"x9" vinyl floor tiles have been found to contain asbestos. Although these vinyl floor tiles have been previously sampled and found not to contain asbestos; due to limitations in the analytical method for analysis of asbestos in vinyl tiles (susceptible of false negative results), it is recommended that all vinyl floor tiles be sampled prior to major renovations or demolition.

4.7 Asbestos Cement Products "Transite" (Non-Friable)

Asbestos-containing cement boards, commonly referred to as "Transite" is present along the exterior walls behind the radiator units.

Associated on the inner aspect between the board and the masonry wall on the building exterior, asbestos-containing corrugated paper insulation is present. See Section 4.10 for details.

4.8 Drywall Joint Compound (DJC)

While previous sample results indicated drywall joint compound sampled at the Site does not contain asbestos, it should be noted that the concentration of asbestos within drywall joint compound is historically known to be potentially inconsistently distributed. Further, it is possible that various phases of construction and renovations have occurred at the Site. Therefore, the number of samples previously collected may not be representative of all drywall joint compound finishes in the building.

4.9 Plaster

No plaster finishes were identified in the building.

4.10 Corrugated Paper

Asbestos-containing corrugated paper insulation associated with transite wall panels was identified within the building. All corrugated paper insulation was observed to be encapsulated with canvas and lagging. Refer to Room-by-Room Asbestos Inventory in Appendix I for locations and quantities.

5.0 RECOMMENDATIONS

5.1 General Recommendations

Due to the presence of ACM within the building, TLDSB must maintain their existing Asbestos Management Program for this property.

A re-assessment of known ACM is to be conducted at least once annually.

It is important to note that due to the presence of solid walls and ceiling systems, ACM may be present in concealed locations not identified in this report.

The assessment confirmed the presence of ACM mechanical insulations within the building (Refer to room-by-room Inventory for condition and quantities). Should any proposed renovations likely cause disturbance of the mechanical insulations, the materials would require removal using Type 2, Type 3 or Glove Bag Asbestos Abatement Procedures as appropriate for the work being performed.

Removal or disturbance of Transite cement and associated asbestos paper insulation requires the use of Type 2 Asbestos procedures (provided no power tools are used and the material is wetted). If power tools are required Type 3 Asbestos Abatement Procedures need be applied.

Prior to any major renovations or demolition, sample and analyze all vinyl floor tiles present throughout the building and Transite board on the building exterior for asbestos content.

Materials suspected of containing asbestos should be sampled prior to disturbance. Suspect materials include; drywall joint compound, plaster, roofing materials, caulking, etc. unless previously confirmed to contain asbestos.

5.2 Specific Recommendations

All asbestos-containing materials identified within the building were observed to be in GOOD condition and no recommendations are warranted.

6.0 LIMITATIONS

Due to the nature of building construction some limitations exist as to the possible thoroughness of the subject investigation. The field observations are considered sufficient in detail and scope to form a reasonable basis for the findings presented in this report. MAPLE warrants that the findings and conclusions contained herein have been made in accordance with generally accepted evaluation methods in the industry and applicable regulations at the time of the performance of the assessment.

It is possible that conditions may exist which could not be reasonably identified within the scope of the investigation or which were not apparent during the site investigation. MAPLE believes that the information collected during the investigation period concerning the property is reliable. No other warranties are implied or expressed.

Information provided by Maple is intended for Client use only. Any use by a third party, of reports or documents authored by Maple, or any reliance by a third party on or decisions made by a third party based on the findings described in said documents, is the sole responsibility of such third parties. Maple accepts no responsibility for damages suffered by any third party as a result of decisions made or actions conducted.

The liability of Maple or its staff will be limited to the lesser of the fees paid or actual damages incurred by the Client. Maple will not be responsible for any consequential or indirect damages. Maple will only be liable for damages resulting from negligence of Maple; all claims by the Client shall be deemed relinquished if not made within two years after last date of services provided.

Please contact Maple Environmental Inc. at (905) 257-4408 for inquiries regarding this project.

Sincerely,

MAPLE ENVIRONMENTAL INC.
Environment, Health and Safety Consultants

Prepared By:



Richards Reboks
Senior Project Technologist

Reviewed By:



Kyle Prosser
Senior Project Manager

APPENDIX I
ROOM-BY-ROOM ASBESTOS INVENTORY

 MAPLE ENVIRONMENTAL INC. ENVIRONMENTAL HEALTH & SAFETY CONSULTANTS		STRUCTURAL ELEMENT RJ: Roof WN: Window FL: Floor CL: Ceiling WL: Wall DK: Deck		BU: Beams/Joints CB: Chalkboard PI: Pipe DT: Duct BL: Block MC: Mechanical		ACCESSIBILITY A: All occupants of the facility B: Maintenance staff without a ladder C: Maintenance staff with a ladder, exposed to view without moving building components D: Maintenance staff with a ladder, concealed from view by building components E: No access without demolition or removal of fixed building components or systems		TERMINOLOGY ACM: Asbestos Containing Material CT: Ceiling Tile DJC: Drywall Joint Compound FTG: Filling LF: Linear Feet MA: Mastic PI-CP: Pipe Insulation-Capstone		N/A: Not Applicable N/Anc: Not Analyzed ND: None Detected PI-AC: Pipe Insulation - Aircell PI-PC: Pipe Insulation-Parging Cement PI-CP: Pipe Insulation-Capstone		PL: Plaster RM: Roofing Materials SFP: Sprayed Fireproofing SF: Square Feet TF: Texture Finish		TB: Transite Board TP: Transite Pipe Vt: Vermiculite Insulation VFT: Vinyl Floor Tile		VSF: Vinyl Sheet Flooring VIC: Visually Consistent w/ Other Sampled Material WC: Window Caulking			
CONDITION G: Good F: Fair P: Poor																			
ID	Facility	Floor #	Room #	Room name	Has ACM	Frtable	Struct. Elem.	Application	Material	Type	Total Qty	Condition	Sample #	Action	Ref #	Comments 1	Comments 2	Comments 3	Notes
88008	Fenelon Township Public School	1	102	Room-101	No	Yes	CL	CT	3	N/D			V/C 28-BS-05						
88009	Fenelon Township Public School	1	102	Room-101	No	Yes	PI	PI-PC		40% CHRYSOTILE			V/C 28-BS-02						Abated 2016.
88004	Fenelon Township Public School	1	103	Room-100	No	No	FL	VFT	4	N/D			28-BS-10A						
88005	Fenelon Township Public School	1	103	Room-100	No	Yes	CL	CT	1	N/D			V/C 28-BS-03						
88006	Fenelon Township Public School	1	103	Room-100	No	Yes	CL	CT	3	N/D			V/C 28-BS-05						
88007	Fenelon Township Public School	1	103	Room-100	Yes	Yes	PI	PI-PC		40% CHRYSOTILE	2 Fittings	G	V/C 28-BS-02			D			
88040	Fenelon Township Public School	1	104	Halway-H1	No	Yes	CL	CT	3	N/D			V/C 28-BS-05						
88041	Fenelon Township Public School	1	104	Halway-H1	No	Yes	CL	CT	1	N/D			28-BS-03C						
88042	Fenelon Township Public School	1	104	Halway-H1	No	-	PI	PI-PC		40% CHRYSOTILE	25Fittings	G	28-BS-02B			D			Abated in 2021 (19727)
88002	Fenelon Township Public School	1	105	Room-102	No	No	FL	VFT	1	N/D			V/C 28-BS-07						
88003	Fenelon Township Public School	1	105	Room-102	No	Yes	CL	CT	1	N/D			V/C 28-BS-03						
87996	Fenelon Township Public School	1	106	Room-104	No	No	FL	VFT	1	N/D			V/C 28-BS-07						
87997	Fenelon Township Public School	1	106	Room-104	No	Yes	CL	CT	1	N/D			V/C 28-BS-03						
87998	Fenelon Township Public School	1	106	Room-104	Yes	Yes	PI	PI-PC		40% CHRYSOTILE	4 Fittings	G	V/C 28-BS-02			D			
88087	Fenelon Township Public School	1	106	Room-104	Yes	No	WL	TB		ACM Assumed	200 SF	G	NS						
87988	Fenelon Township Public School	1	107	Room-106	No	No	FL	VFT	1	N/D			28-BS-07A						
87989	Fenelon Township Public School	1	107	Room-106	No	Yes	CL	CT	1	N/D			28-BS-03B						
87990	Fenelon Township Public School	1	107	Room-106	Yes	Yes	PI	PI-PC		40% CHRYSOTILE	4 Fittings	G	28-BS-02C			D			
88088	Fenelon Township Public School	1	107	Room-106	Yes	No	WL	TB		ACM Assumed	200 SF	G	NS						
87991	Fenelon Township Public School	1	108	Room-107	No	No	FL	VFT	1	N/D			V/C 28-BS-07						
87992	Fenelon Township Public School	1	108	Room-107	No	Yes	CL	CT	1	N/D			V/C 28-BS-03						
87993	Fenelon Township Public School	1	108	Room-107	Yes	Yes	PI	PI-PC		40% CHRYSOTILE	4 Fittings	G	V/C 28-BS-02			D			
88089	Fenelon Township Public School	1	108	Room-107	Yes	No	WL	TB		ACM Assumed	200 SF	G	NS						
87994	Fenelon Township Public School	1	109	Room-105	No	No	FL	VFT	1	N/D			V/C 28-BS-07						
87995	Fenelon Township Public School	1	109	Room-105	No	Yes	CL	CT	1	N/D			28-BS-03A						
88090	Fenelon Township Public School	1	109	Room-105	Yes	No	WL	TB		ACM Assumed	200 SF	G	NS						
87999	Fenelon Township Public School	1	110	Room-103	No	No	FL	VFT	1	N/D			28-BS-07B						
88000	Fenelon Township Public School	1	110	Room-103	No	Yes	CL	CT	1	N/D			V/C 28-BS-03						
88001	Fenelon Township Public School	1	110	Room-103	Yes	Yes	PI	PI-PC		40% CHRYSOTILE	4 Fittings	G	V/C 28-BS-02			D			
88091	Fenelon Township Public School	1	110	Room-103	Yes	No	WL	TB		ACM Assumed	200 SF	G	NS						
88010	Fenelon Township Public School	1	111	Girl's Bathroom-135	No	No	CL	DJC		N/D			V/C 28-BS-01						No access above drywall ceiling
88046	Fenelon Township Public School	1	112	Washrooms and 135 & 13	No	No	CL	DJC		N/D			V/C 28-BS-01						No access above drywall ceiling
88047	Fenelon Township Public School	1	113	Washrooms and 135 & 13	No	No	CL	DJC		N/D			V/C 28-BS-01						No access above drywall ceiling
88048	Fenelon Township Public School	1	114	Custodian Room-140	No	No	CL	DJC		N/D			V/C 28-BS-01						No access above drywall ceiling
88049	Fenelon Township Public School	1	114	Custodian Room-140	Yes	Yes	PI	PI-PC		40% CHRYSOTILE	2 Fittings	G	V/C 28-BS-02			D			No access above drywall ceiling
88055	Fenelon Township Public School	1	115	Room-114	No	No	FL	VFT	1	N/D			V/C 28-BS-07						
88056	Fenelon Township Public School	1	115	Room-114	No	Yes	CL	CT	1	N/D			V/C 28-BS-03						
88057	Fenelon Township Public School	1	115	Room-114	Yes	Yes	PI	PI-PC		40% CHRYSOTILE	4 Fittings	G	V/C 28-BS-02			D			
88092	Fenelon Township Public School	1	115	Room-114	Yes	No	WL	TB		ACM Assumed	200 SF	G	NS						
88077	Fenelon Township Public School	1	116	Room-116	Yes	No	FL	VFT	1	1% CHRYSOTILE			18777-S02A-C			E			Removed summer 2020, tiles remain below millwork. Black mastic is non-asbestos.
88078	Fenelon Township Public School	1	116	Room-116	No	Yes	CL	CT	1	N/D			V/C 28-BS-03						
88093	Fenelon Township Public School	1	116	Room-116	Yes	No	WL	TB		ACM Assumed	200 SF	G	NS						
88079	Fenelon Township Public School	1	117	Room-118	No	No	FL	VFT	3	N/D			V/C 28-BS-09						
88080	Fenelon Township Public School	1	117	Room-118	No	Yes	CL	CT	2	N/D			V/C 28-BS-04						
88081	Fenelon Township Public School	1	118	Room-120	No	No	FL	VFT	2	N/D			28-BS-08A						
88082	Fenelon Township Public School	1	118	Room-120	No	Yes	CL	CT	2	N/D			V/C 28-BS-04						
88043	Fenelon Township Public School	1	119	Halway-H2	No	Yes	CL	CT	3	N/D			V/C 28-BS-05						
88044	Fenelon Township Public School	1	119	Halway-H2	No	Yes	CL	CT	2	N/D			28-BS-04C						
88045	Fenelon Township Public School	1	119	Halway-H2	Yes	Yes	PI	PI-PC		40% CHRYSOTILE	40Fittings	G	V/C 28-BS-02			D			Abated 2022
88075	Fenelon Township Public School	1	120	Room-127	No	No	FL	VFT	4	N/D			V/C 28-BS-10						
88076	Fenelon Township Public School	1	120	Room-127	No	Yes	CL	CT	2	N/D			V/C 28-BS-04						
88063	Fenelon Township Public School	1	120	Storage Room 127	No	No	FL	VSF		N/D			28-BS-06A-C						
88067	Fenelon Township Public School	1	120	Storage Room 127	No	No	FL	VFT	3	N/D			28-BS-09A						
88071	Fenelon Township Public School	1	120	Storage Room 127	No	Yes	CL	CT	2	N/D			V/C 28-BS-04						
88064	Fenelon Township Public School	1	120A	East Storage	No	No	FL	VSF		N/D			28-BS-06A-C						
88068	Fenelon Township Public School	1	120A	East Storage	No	No	FL	VFT	3	N/D			28-BS-09A						
88072	Fenelon Township Public School	1	120A	East Storage	No	Yes	CL	CT	2	N/D			V/C 28-BS-04						
88065	Fenelon Township Public School	1	120B	West Storage	No	No	FL	VSF		N/D			28-BS-06A-C						
88069	Fenelon Township Public School	1	120B	West Storage	No	No	FL	VFT	3	N/D			28-BS-09A						
88073	Fenelon Township Public School	1	120B	West Storage	No	Yes	CL	CT	2	N/D			V/C 28-BS-04						
88066	Fenelon Township Public School	1	120C	Storage within Room 127	No	No	FL	VSF		N/D			28-BS-06A-C						
88070	Fenelon Township Public School	1	120C	Storage within Room 127	No	No	FL	VFT	3	1% CHRYSOTILE			18777-S01A-C			E			Removed summer 2020, tiles may remain below millwork. Black mastic is non-asbestos.
88074	Fenelon Township Public School	1	120C	Storage within Room 127	No	Yes	CL	CT	2	N/D			V/C 28-BS-04						
88060	Fenelon Township Public School	1	121	Room-121	No	No	FL	VFT	4	N/D			28-BS-10C						
88061	Fenelon Township Public School	1	121	Room-121	No	Yes	CL	CT	1	N/D			V/C 28-BS-03						
88062	Fenelon Township Public School	1	121	Room-121	Yes	Yes	PI	PI-PC		40% CHRYSOTILE	4 Fittings	G	V/C 28-BS-02			D			
88094	Fenelon Township Public School	1	121	Room-121	Yes	No	WL	TB		ACM Assumed	200 SF	G	NS						
88085	Fenelon Township Public School	1	121	Room-125	No	No	FL	VFT	3	N/D			28-BS-09B						

 <div>ENVIRONMENTAL INC. ENVIRONMENTAL HEALTH & SAFETY CONSULTANTS</div>		STRUCTURAL ELEMENT		B/J: Beams/Joints		ACCESSIBILITY				TERMINOLOGY															
		RF: Roof WN: Window FL: Floor CL: Ceiling WL: Wall DK: Deck	CB: Chalkboard PI: Pipe DT: Duct BL: Boiler MC: Mechanical	A: All occupants of the facility B: Maintenance staff without a ladder C: Maintenance staff with a ladder, exposed to view without moving building components D: Maintenance staff with a ladder, concealed from view by building components E: No access without demolition or removal of fixed building components or systems	ACM: Asbestos Containing Material CT: Ceiling Tile DJC: Drywall Joint Compound FTG: Filling LF: Linear Feet MA: Mastic CONDITION G: Good F: Fair P: Poor	N/A: Not Applicable N/Axz: Not Analyzed N/D: None Detected PI/AC: Pipe Insulation - Aircell PI-PC: Pipe Insulation-Parging Cement PI-CP: Pipe Insulation-Capstone	PL: Plaster RM: Roofing Materials SPF: Sprayed Fireproofing SF: Square Feet TF: Texture Finish	TB: Transite Board TP: Transite Pipe Vt: Vermiculite Insulation VFT: Vinyl Floor Tile	VSF: Vinyl Sheet Flooring VIC: Visually Consistent w/ Other Sampled Material WC: Window Caulking																
ID	Facility	Floor #	Room #	Room name	Has ACM	Frtable	Struct. Elem.	Application	Material	Type	Total Qty	Condition	Sample #	Action	Ref #	Comments 1	Comments 2	Comments 3	Notes						
88086	Fenelon Township Public School	1	121	Room-125	No	Yes	CL	CT	2	N/D			V/C 28-BS-04												
88083	Fenelon Township Public School	1	122	Room-123	No	No	FL	VFT	2	N/D			28-BS-08B												
88084	Fenelon Township Public School	1	122	Room-123	No	Yes	CL	CT	2	N/D			V/C 28-BS-04												
88058	Fenelon Township Public School	1	123	Resources Room-119	No	No	FL	VFT	4	N/D			V/C 28-BS-10												
88059	Fenelon Township Public School	1	123	Resources Room-119	No	Yes	CL	CT	1	N/D			V/C 28-BS-03												
88095	Fenelon Township Public School	1	123	Resources Room-119	Yes	No	WL	TB		ACM Assumed	200 SF	G	NS												
88054	Fenelon Township Public School	1	124	Boiler Room-133	No	No	CL	DJC		N/D			28-BS-01C-E						No access above drywall ceiling						
88053	Fenelon Township Public School	1	125	Boy's Washroom-131	No	No	CL	DJC		N/D			V/C 28-BS-01						No access above drywall ceiling						
88050	Fenelon Township Public School	1	126	Staff Room-117	No	No	FL	VFT	1	1% CHRYSOTILE			18777-S03A-C			E			Removed summer 2020, tiles remain below millwork. Black mastic is non-asbestos.						
88051	Fenelon Township Public School	1	126	Staff Room-117	No	Yes	CL	CT	2	N/D			28-BS-04B												
88052	Fenelon Township Public School	1	126	Staff Room-117	Yes	Yes	PI	PI-PC		40% CHRYSOTILE	6 Fittings	G	28-BS-02A			D									
88015	Fenelon Township Public School	1	127	Gym Room-115	No	No	FL	VFT	5	N/D			28-BS-11A-C												
88016	Fenelon Township Public School	1	127	Gym Room-115	Yes	Yes	PI	PI-PC		40% CHRYSOTILE	12 Fittings	G	V/C 28-BS-02			C									
88023	Fenelon Township Public School	1	127A	Gym Equipment Room	No	No	FL	VFT	2	N/D			V/C 28-BS-08												
88024	Fenelon Township Public School	1	127A	Gym Equipment Room	No	No	FL	VFT	3	N/D			28-BS-09C												
88025	Fenelon Township Public School	1	127A	Gym Equipment Room	No	Yes	CL	CT	2	N/D			V/C 28-BS-04												
88026	Fenelon Township Public School	1	127A	Gym Equipment Room	No	No	CL	DJC		N/D			V/C 28-BS-01						No access above drywall ceiling						
88027	Fenelon Township Public School	1	127A	Gym Equipment Room	Yes	Yes	PI	PI-PC		40% CHRYSOTILE	3 Fittings	G	V/C 28-BS-02			D									
88019	Fenelon Township Public School	1	128	Room-111	No	No	FL	VFT	2	N/D			V/C 28-BS-08												
88020	Fenelon Township Public School	1	128	Room-111	No	Yes	CL	CT	2	N/D			V/C 28-BS-04												
88017	Fenelon Township Public School	1	129	Girl's Changroom by Gym	No	No	FL	VFT	2	N/D			V/C 28-BS-08												
88018	Fenelon Township Public School	1	129	Girl's Changroom by Gym	No	Yes	CL	CT	2	N/D			V/C 28-BS-04												
88021	Fenelon Township Public School	1	130	Boy's Changroom by Gym	No	No	FL	VFT	2	N/D			28-BS-08C												
88022	Fenelon Township Public School	1	130	Boy's Changroom by Gym	No	Yes	CL	CT	2	N/D			V/C 28-BS-04												
88028	Fenelon Township Public School	1	131	Library 113	No	No	FL	VFT	6	N/D			28-BS-12A-C												
88031	Fenelon Township Public School	1	131	Library 113	No	No	FL	VFT	4	N/D			28-BS-10B												
88034	Fenelon Township Public School	1	131	Library 113	No	Yes	CL	CT	2	N/D			28-BS-04A												
88037	Fenelon Township Public School	1	131	Library 113	Yes	Yes	PI	PI-PC		40% CHRYSOTILE	3 Fittings	G	V/C 28-BS-02			D									
88029	Fenelon Township Public School	1	132	AV Room	No	No	FL	VFT	6	N/D			28-BS-12A-C												
88032	Fenelon Township Public School	1	132	AV Room	No	No	FL	VFT	4	N/D			28-BS-10B												
88035	Fenelon Township Public School	1	132	AV Room	No	Yes	CL	CT	2	N/D			28-BS-04A												
88038	Fenelon Township Public School	1	132	AV Room	No	Yes	PI	PI-PC		40% CHRYSOTILE			V/C 28-BS-02												
88030	Fenelon Township Public School	1	133	Book Room	No	No	FL	VFT	6	N/D			28-BS-12A-C												
88033	Fenelon Township Public School	1	133	Book Room	No	No	FL	VFT	4	N/D			28-BS-10B												
88036	Fenelon Township Public School	1	133	Book Room	No	Yes	CL	CT	2	N/D			28-BS-04A												
88039	Fenelon Township Public School	1	133	Book Room	No	Yes	PI	PI-PC		40% CHRYSOTILE			V/C 28-BS-02						Removed						
88012	Fenelon Township Public School	1	134	Room-112	No	Yes	CL	CT	3	N/D			28-BS-05A-C												
88014	Fenelon Township Public School	1	134	Room-112	No	No	WL	DJC		N/D			28-BS-01A & B												
88011	Fenelon Township Public School	1	135	Room-110	No	Yes	CL	CT	3	N/D			28-BS-05A-C												
88013	Fenelon Township Public School	1	135	Room-110	No	No	WL	DJC		N/D			28-BS-01A & B												
87984	Fenelon Township Public School	NA		EXTERIOR	No	No	RF	RM	NA	ACM ASSUMED	1	G	NS			C			sample prior to renovation						
87985	Fenelon Township Public School	NA		EXTERIOR	No	No	WN	WC	NA	ACM ASSUMED	1	G	NS			A, C			sample prior to renovation						
87986	Fenelon Township Public School	NA		EXTERIOR	No	No	WN	TB	NA	ACM ASSUMED	1	G	NS			A, C			sample prior to renovation						
87987	Fenelon Township Public School	NA		Exterior Canopy East Exit	No	Yes	CL	TF	NA	N/D			28-BS-13A-C												

APPENDIX II

DRAWINGS

Please Note:
Prior to disturbing 9"x9" vinyl floor tiles, have the material analyzed for asbestos content. Asbestos-containing transite board (TB) is suspected to be present on the building exterior.

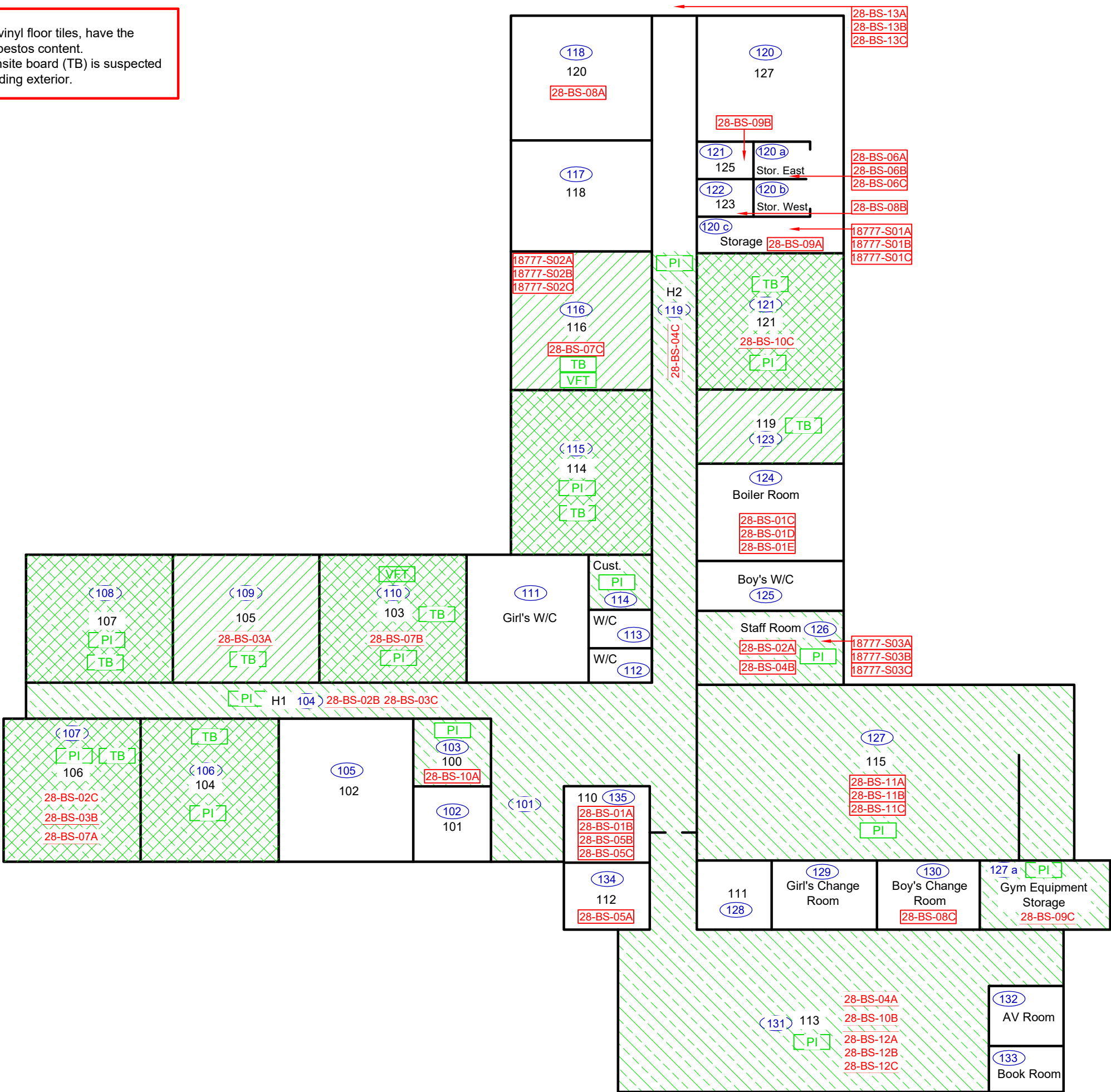

LEGEND

01-BS-01A

Jacques Whitford Sample Locations

#

Ebase Number

CONFIRMED ACM

SYMI

DESCRIPTION

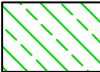

Friable Asbestos-Containing Material

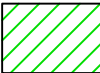

Non-Friable
Asbestos-Containing Material



Pipe Insulation (Friable
Asbestos-Containing Material)

Transite Board (Non-Friable
Asbestos-Containing Material)

Vinyl Floor Tiles (Non-Friable Asbestos-Containing Material)

NC

9"x9" Vinyl Floor Tiles

NO

Transite Board

For Detailed Information as to Location, Type, Quantity, Condition and Access to ACM, Please Refer to the Room-by-Room Sheets Provided in the Report

Fenelon Township Public School

50 Cameron Road,
Cameron, Ontario

First Floor Plan

Asbestos Materials Re-Assessment Survey

CLIENT: Trillium Lakelands District School Board

PROJECT NUMBER:
21700-31

DATE: September 2024

SCALE:	CHK BY:
Not to Scale	K. Prosser



MAPLE ENVIRONMENTAL INC.

ENVIRONMENT HEALTH & SAFETY CONSULTANTS

APPENDIX III
POTENTIAL ASBESTOS-CONTAINING MATERIAL
IDENTIFICATION SHEET

APPENDIX III - POTENTIAL ASBESTOS-CONTAINING MATERIALS INFORMATION SHEET

<i>MIN</i>	<i>Material</i>	<i>Material Description</i>	<i>Size</i>	<i>Sample Number</i>	<i>Sample Location</i>	<i>Asbestos Containing</i>
VFT-1	Vinyl Floor Tiles	Beige with red smears	9 x 9	28-BS-07A-C	Room 106, 103 & 116	None
VFT-2	Vinyl Floor Tiles	Beige with black smears	12x 12	28-BS-08A-C	Room 120, 123 & boy's changeroom	None
VFT-3	Vinyl Floor Tiles	Beige with beige smears	12x 12	28-BS-09A-C	Storage s/wing, Rm 125 & Gym equipment	None
VFT-4	Vinyl Floor Tiles	White with blue specks	12 x 12	28-BS-10A-C	Rm 100, Library Entrance & Rm 1221	None
VFT-5	Vinyl Floor Tiles	Beige with black and white smears	12 x 12	28-BS-11A-C	Gym	None
VFT-6	Vinyl Floor Tiles	Blue with smears	12 x 12	28-BS-12A-C	Library	None
CT-1	Ceiling Tiles	Plainhole pattern	2 x 4	28-BS-03A-C	Room 105, 106 & H1	None
CT-2	Ceiling Tiles	Large fissure pimhole pattern	2 x 4	28-BS-04A-C	Library, Staff Rm & H2	None
CT-3	Ceiling Tiles	Small fissure pimhole pattern	2 x 4	28-BS-05A-C	Room 112 & 110	None
VSF-1	Vinyl Sheet Flooring			28-BS-06A-C	Storage east wing	None