REQUEST FOR TENDER RFT #B24-02

Washroom Upgrades

ADDENDUM NO. 6

The following additional instructions and amendments shall apply and govern the contract accordingly:

See attached Architect Addendum- 3 pages

END OF ADDENDUM NO. 6

1.0 INTENT

- 1.1 This Addendum is issued prior to receipt of Bid to provide clarifications and revisions to the Drawings and Specifications. The following additional instructions shall apply to and govern the Bid Documents.
- 1.2 Indicate receipt of this Addendum on the Tender Form.
- 1.3 This Addendum consists of **1 page** plus the listed attachments.
- 1.4 Attachments:
 - 1.4.1 Sketch **ADD 6.1**.

2.0 INTRODUCTORY INFORMATION

- 2.1 This addendum applies to the **Gravenhurst High School** project only.

3.0 CLARIFICATIONS

- 3.1 **ADD:** Typical at all WF-1 wash fountains installed on existing concrete block walls provide vertical trenching detail 2/DSK 04.1 for new water supply, venting and power supplies to new WF-1.
- 3.2 **ADD:** Unit price: Storefront privacy screen.

Bidders are to include a unit price for a storefront privacy screen as indicated on the attached sketch **ADD 6.1** as a separate line item in their schedule of values. The privacy screen is to be installed on top of the existing terrazzo wing wall at the entrance to each washroom. For the purposes of bidding only one privacy screen is to be included in the bid price as a unit price to be used at the Owner's discretion to include in the project at one or up to four of the washroom locations in the project.

Unit price to include supply and installation of:

- Clear anodized storefront framing system
- Tempered laminated glazing (10mm)
- Above ceiling steel stud bracing assembly.
- Two additional F1 light fixtures that will be required to accommodate the new privacy screen.

Carry the price for one washroom (Rm 120) in the bid price that could be applied to one or up to four washrooms using a similar design.

- 3.3 **REVISE:** Door D212 and D213 heights from 2134 to 2032 to match existing opening heights. Contractor to confirm exact door dimensions on site prior to shop drawing submission.

Note: Doors D120 and D122 are intentionally standard 2134/7'-0" heights as they are in new framing and recessed back from the corridor.

END OF ADDENDUM #6

STOREFRONT PRIVACY SCREEN

ALUMICOR FLUSHGLAZE TL1800 OR SIMILAR
 44.5mm x 114.3mm FRAME PROFILE
 CLEAR ANODIZED
 10mm TEMPERED LAMINATED GLAZING C/W FROSTED
 INTERLAYER (80% OPACITY)

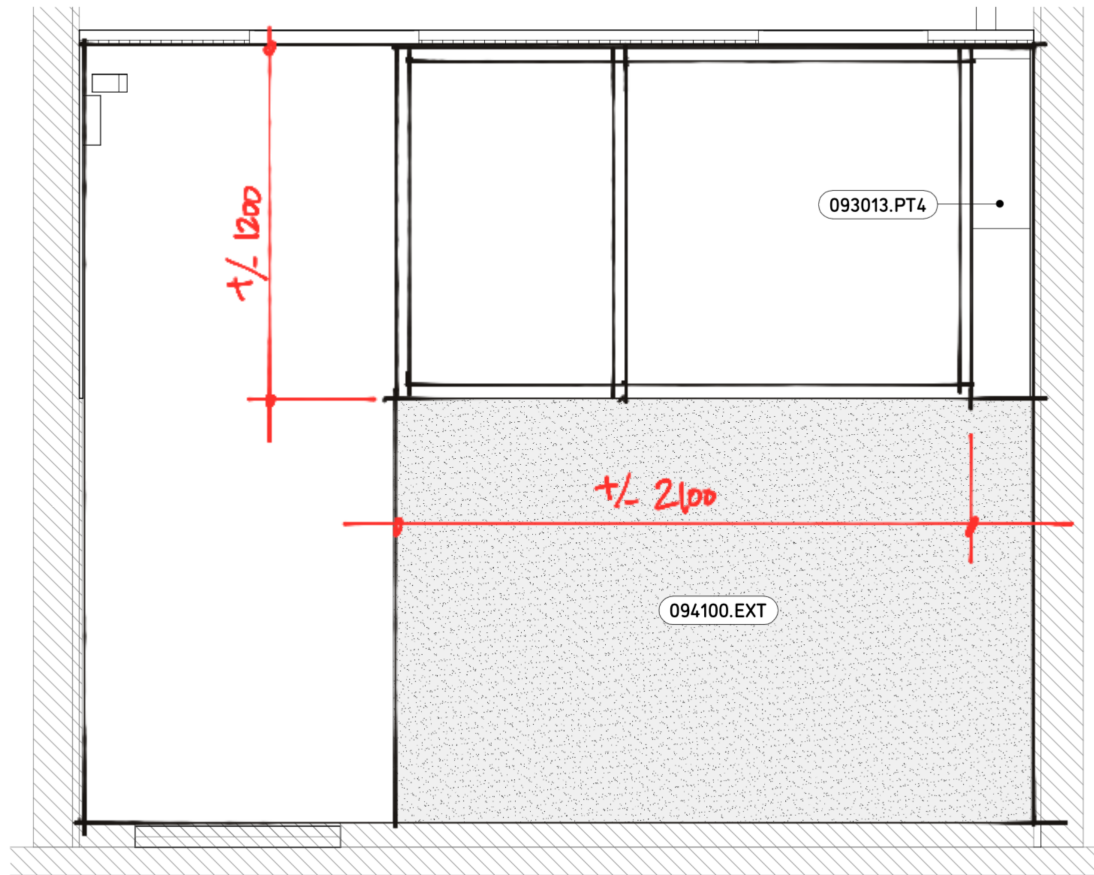

7 Rm 120 Vest North
 1:25

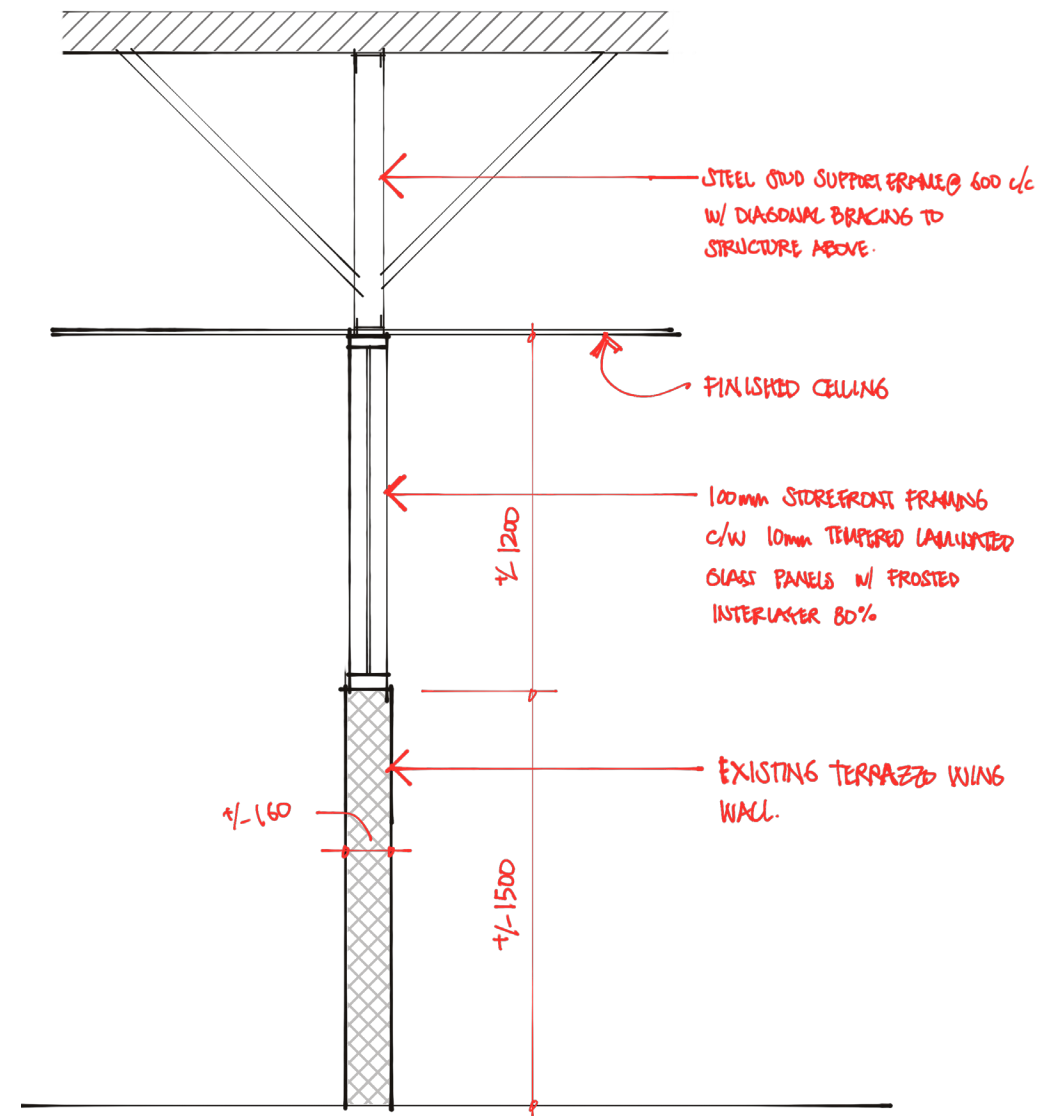

SECTION

ADD 6.1 PRIVACY SCREEN