

LEGEND:

-  MANUAL PULL STATION
-  EXIT SIGN
-  FIRE EXTINGUISHER
-  EMERGENCY LIGHTING BATTERY UNIT W/ SPOTLIGHTS
-  FIRE HOSE CABINET W/ FIRE EXTINGUISHER
-  SPRINKLER CONTROL VALVE (MUT)
-  ELECTROMAGNETIC LOCKING DEVICE
-  AUTOMATIC EXTERNAL DEFIBRILLATOR (AED)
-  EXIT STAIRWELL

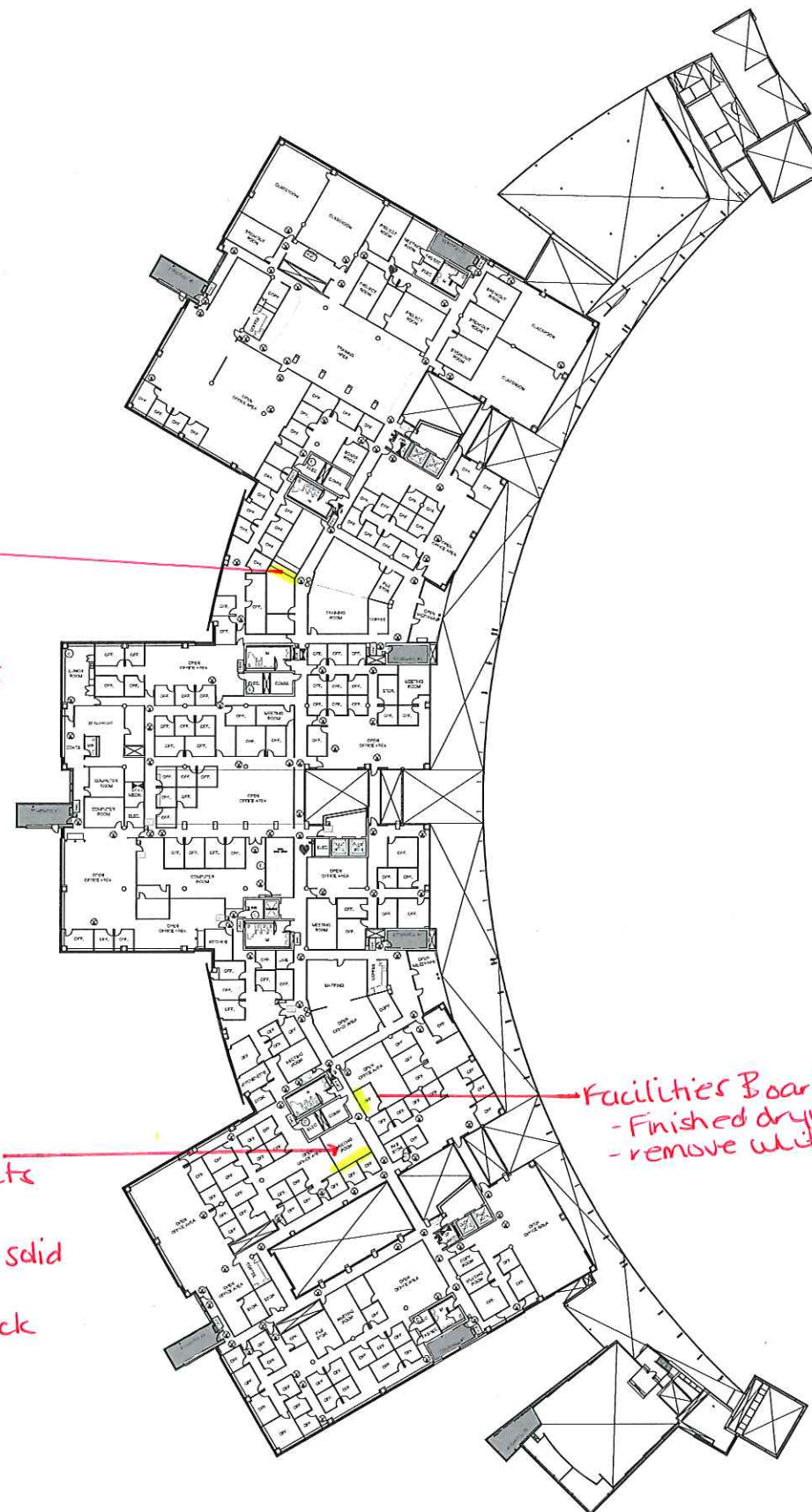

2-141  
 - remove vinyl wall board  
 - remove cabinets

2-047  
 - remove cabinets  
 - remove vinyl wall board  
 replace with solid base  
 - relocate clock

Facilities Boardroom  
 - Finished drywall base  
 - remove whiteboard

CONSTRUCTION NORTH



BUILDING NAME AND ADDRESS:  
 LINCOLN M. ALEXANDER BUILDING  
 OPP GENERAL HEADQUARTERS  
 777 MEMORIAL AVENUE  
 ORILLIA, ONTARIO

DRAWING:  
 2nd FLOOR

DATE:	SCALE:
FEBRUARY 4, 2008	NOT TO SCALE

FILE No.	DWG No.
2007-090	4 OF 10

ISSUE No.
1

LEGEND:

- MANUAL PULL STATION
- ⊙ EXIT SIGN
- ⊙ FIRE EXTINGUISHER
- ⊙ FIRE HOSE CABINET W/ FIRE EXTINGUISHER
- ⊙ SPRINKLER CONTROL VALVE (WET)
- ⊙ ELECTROMAGNETIC LOCKING DEVICE
- ♥ AUTOMATIC EXTERNAL DEFRIBILLATOR (AED)
- HAZARDOUS MATERIALS AREA
- EXIT STAIRWELL

3-165  
 - remove vinyl  
 wall board  
 & cabinets/  
 whiteboard

3-064  
 - remove vinyl  
 wall board &  
 cabinets / white  
 board

3-070  
 - remove vinyl wall board &  
 cabinets / white board

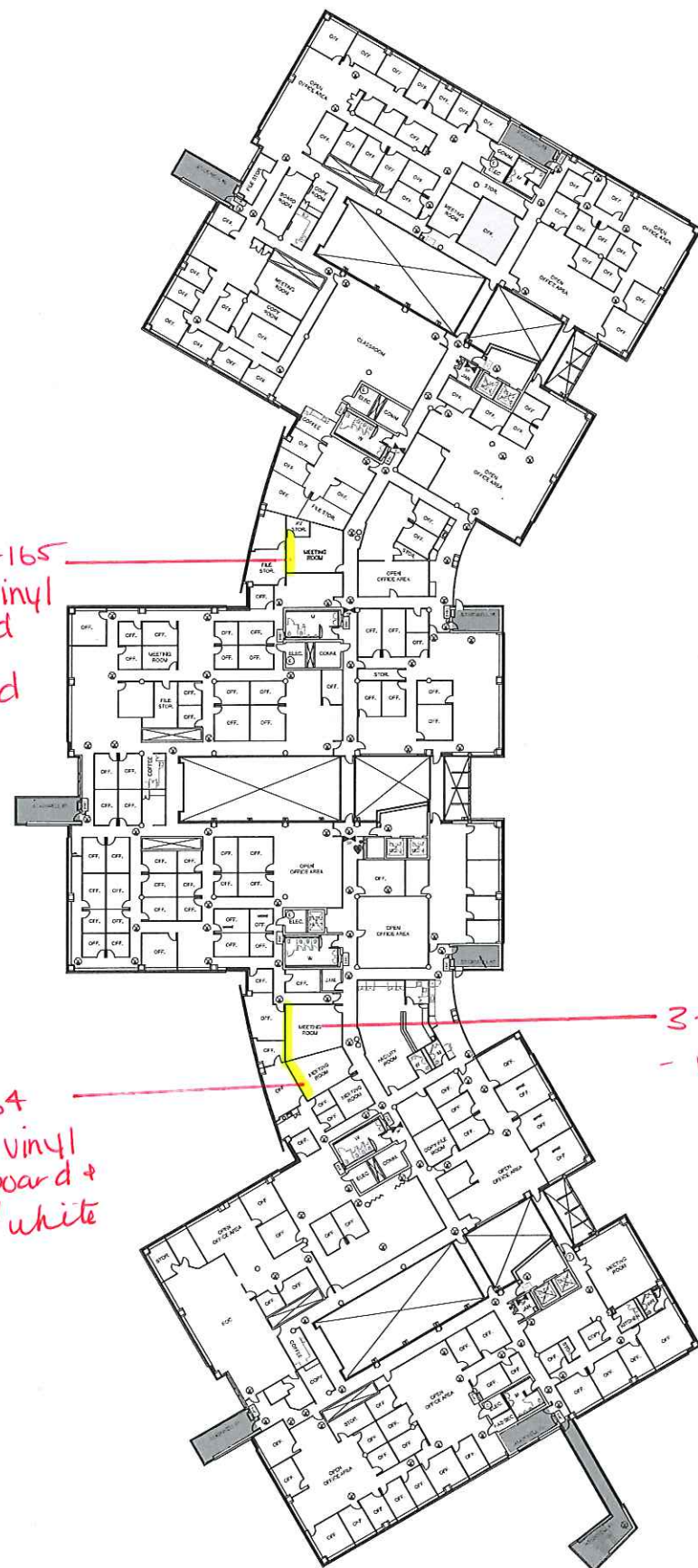

CONSTRUCTION NORTH



BUILDING NAME AND ADDRESS:  
 LINCOLN M. ALEXANDER BUILDING  
 OPP GENERAL HEADQUARTERS  
 777 MEMORIAL AVENUE  
 ORILLIA, ONTARIO

DRAWING:  
 3rd FLOOR

DATE: FEBRUARY 4, 2008	SCALE: NOT TO SCALE
---------------------------	------------------------

FILE No. 2007-090	DWG No. 5 OF 10
----------------------	--------------------

ISSUE No. 1	
----------------	--