REQUEST FOR TENDER RFT #21-01

Washroom New & Renewal – Various location

ADDENDUM NO. 5

The following additional instructions and amendments shall apply and govern the contract accordingly:

.ADD:

See attached Architect Addendum #4 (11pages)

Drawings/Detail sheets referenced in Addendum have also been uploaded to the documents section of bids and tenders.

END OF ADDENDUM NO. 5

1.0 INTENT

- 1.1 This Addendum is issued prior to receipt of Bid to provide clarifications and revisions to the Drawings and Specifications. The following additional instructions shall apply to and govern the Bid Documents.
- 1.2 Indicate receipt of this Addendum on the Tender Form.
- 1.3 This Addendum consists of three (1) page plus the listed attachments in Sections 4 and 5 below.

2.0 SCOPE

- 2.1 Pine Glen Public School
 - .1 Architectural Woodwork typical details and Specifications. This addendum clarifies typical cabinetry details and specifications for the Architectural Woodwork in Room 113 Kitchen and Room 143 Gym Office.
- 2.2 Dunsford District Elementary School
 - .1 Architectural Woodwork typical details and Specifications. This addendum clarifies typical cabinetry details and specifications for the Architectural Woodwork in Room 126A.

3.0 BIDDING REQUIREMENTS

- 3.1 Not used.

4.0 SPECIFICATIONS

- 4.1 ADD: Specification Section 06 40 00 Architectural Woodwork (7 Pages)

5.0 ARCHITECTURAL

- 5.1 ADD: Three Appendix A: Detail Sheets:
 - DSK 06.1 Base Cabinet Details
 - DSK 06.2 Base Cabinet Drawer Units
 - DSK 06.3 Upper Cabinets

END OF ADDENDUM #3

1 GENERAL**1.01 RELATED REQUIREMENTS**

- .1 Section 07 92 00 - Joint Sealants: Sealant materials and application.
- .2 Section 09 91 23 - Interior Painting: Site finishing materials and application.

1.02 REFERENCE STANDARDS

- .1 Architectural Woodwork Manufacturers Association of Canada (AWMAC)
 - .1 North American Architectural Woodwork Standards (NAAWS), 2021.
- .4 Canadian General Standards Board (CGSB)
 - .1 [CAN/CGSB-11.3-\[M87\]](#), Hardboard.
 - .2 [CAN/CGSB-71.20-\[M88\]](#), Adhesive, Contact, Brushable.
 - .3 [CAN/CGSB-71.19-\[M88\]](#), Adhesive, Contact, Sprayable.
- .5 CSA Group (CSA)
 - .1 **CSA 0112-M** Series [1977 (R2006)] Standards for Wood Adhesives.
 - .2 [CSA 0121-\[08\(R2013\)\]](#), Douglas Fir Plywood.
 - .3 [CSA 0141-\[05 \(R2014\)\]](#), Softwood Lumber.
 - .4 [CSA 0151-\[14\]](#), Canadian Softwood Plywood.
 - .5 [CSA 0153-\[M1980 \(R2014\)\]](#), Poplar Plywood.
 - .6 [CAN/CSA-Z809-\[08\(R2013\)\]](#), Sustainable Forest Management.
- .8 Health Canada/Workplace Hazardous Materials Information System (WHMIS)
 - .1 Safety Data Sheets (SDS).

1.03 PRE-INSTALLATION MEETING

- .1 Prior to enclosing framing, convene a meeting of contractor, casework fabricator, casework installer, framing subcontractor and Consultant.
 - .1 Review locations of backing required for casework installation as shown on shop drawings and as necessary for installation.
 - .2 Review method of attachment for backing to wall system.
 - .3 Review coordination with other affected sections.

1.04 ACTION AND INFORMATIONAL SUBMITTALS

- .1 Submit in accordance with Section 01 33 00 - Submittal Procedures.
- .2 Product Data:
 - .1 Prepare and submit material list in accordance with NAAWS, cross-referenced to specifications.
 - .2 Include manufacturer's instructions, printed product literature, data sheets and

catalogue pages for all materials and products to be incorporated into architectural wood casework and include product characteristics, performance criteria, dimensions and profiles, finish and limitations on use.

- .3 Hardware List:
 - .1 Submit hardware list cross-referenced to specifications.
 - .2 Include manufacturer's specification sheets indicating name, model, material, function, finish, BHMA designations and other pertinent information.
- .4 Shop Drawings:
 - .1 Prepare and submit shop drawings in accordance with NAAWS and as follows.
 - .2 Submit digital (PDF) sets of shop drawings for initial review in accordance with requirements of Division 01. Revise as directed, submit digital copies for final acceptance and distribution.
 - .3 Indicate details of construction, profiles, jointing, fastening and other related details.
 - .4 Indicate materials, thicknesses, finishes and hardware.
 - .5 Indicate locations of service outlets in casework, typical and special installation conditions, and connections, attachments, anchorage and location of exposed fastenings.
 - .6 Show location on casework elevations of backing required in supporting structure for attachment of casework.
 - .7 Indicate NAAWS quality grade where different from predominant grade specified.
 - .8 Include color schedule of all casework items, including all countertop, exposed, and semi-exposed cabinet finishes, finish material manufacturer, pattern, and color.
- .5 Samples:
 - .1 Physical samples not required, digital photo sample submissions acceptable.
 - .2 Submit statement of experience and qualifications of architectural wood casework fabricator.

1.05 QUALITY ASSURANCE

- .1 Perform Work of this Section by single architectural wood casework fabricator with minimum 5 years of current architectural casework production experience and having completed minimum one project in the past 5 years with value within 20% of the cost of the work of this Section.
- .3 Mock-ups:
 - .1 Not required.

1.07 DELIVERY, STORAGE AND HANDLING

- .1 Deliver, store and handle materials in accordance with Section 01 61 00 - Common Product Requirements and with manufacturer's written instructions.
- .2 Deliver wood casework only when area of work is enclosed, plaster and concrete work is dry, and area is broom clean and site environmental conditions are acceptable for installation.

- .3 Protect millwork against dampness and damage during and after delivery.
- .4 Store millwork in ventilated areas, protected from extreme changes of temperature and humidity, and within range recommended by NAAWS for location of project.
- .5 Store materials indoors in clean, dry, well-ventilated area.
- .6 Protect architectural woodwork and hardware from nicks, scratches, and blemishes.
- .7 Replace defective or damaged materials with new.

2 PRODUCTS

2.01 QUALITY GRADE

- .1 Provide all materials and perform all fabrication in accordance with NAAWS Premium Grade.
- .2 In case of conflict between Contract Documents and NAAWS grade requirements, Contract Documents govern.

2.02 LUMBER

- .1 Softwood and Hardwood Lumber: Sound lumber to specified NAAWS quality grade requirements, kiln-dried to moisture content recommended by NAAWS for location of the Work.
- .2 Machine stress-rated lumber is acceptable for all purposes.
- .3 Face framing, trims, molding, 6mm edge-banding, stiles and rails: White Birch species, in profiles indicated.

2.03 PANEL MATERIALS

- .1 Hardwood plywood: to CSA 0115-M1982 (R2001) Hardwood and Decorative Plywood, for exposed and semi-exposed surfaces:
 - .1 Veneer species: AA Grade Select White Birch
 - .2 Matching: Book
 - .3 Core: Minimum 5 ply plywood veneer waterproof core, laminated with waterproof adhesive.
 - .4 Thickness: 19 mm.
 - .5 Edge banding: 6mm solid white birch, square edge on all exposed surfaces.
 - .6 Bond: Type II.
 - .7 Grain direction: Vertical
- .2 Canadian softwood plywood (CSP): to [CSA 0151](#), standard construction, for concealed surfaces only.

- .3 Solid Surface Counters and Backsplashes:
Homogeneous solid sheets of filled plastic resin complying with ISSFA-2.
- .1 Product: Formica Everform
 - .2 Thickness: 12.7mm/1/2"
 - .3 Colour and Pattern: Luna Storm, Solid Surfacing (S1)
 - .4 Edges: Square edge, double eased with maximum 3mm radius, with drip groove.
 - .5 Backsplash: 12.7mm/1/2", coved at deck, square at top
 - .6 Accessories: Adhesives: For seams and drop edges, manufacturer's solid surface seaming adhesive; color to blend with sheet material.
 - .7 Acceptable alternates:
 - .1 Corian by Dupont
 - .2 Wilsonart Solid Surface

2.04 CASEWORK FABRICATION - GENERAL

- .1 Fabricate casework of specified core and surface finish materials to specified NAAWS quality grade.
 - .1 Construction type: Frameless.
 - .2 Door/drawer cabinet interface: Flush overlay.
- .2 Set nails and countersink screws apply plain wood filler to indentations, sand smooth and leave ready to receive finish.
- .3 Shop install cabinet hardware for doors, shelves and drawers. Recess shelf standards unless noted otherwise.
- .4 Shelving to cabinetwork to be adjustable unless otherwise noted.
- .5 Provide cutouts for plumbing fixtures, inserts, appliances, outlet boxes and other fixtures.
- .6 Shop assemble work for delivery to site in size easily handled and to ensure passage through building openings.
- .7 Obtain governing dimensions before fabricating items which are to accommodate or abut appliances, equipment and other materials.

2.05 WOOD CASEWORK FABRICATION

- .1 Fabricate casework bodies of specified veneered plywood panel materials in accordance with NAAWS requirements for grade specified and as follows.
 - .1 Exposed interior surfaces: Veneer of same species and cut and grade as exposed exterior surfaces.
 - .2 Semi-exposed surfaces: Veneer of same species as exposed exterior surfaces.

- .2 Fabricate door, drawer and panel surfaces of specified veneered plywood panel.
- .3 Drawer construction:
 - .1 Sides:
 - .1 NAAWS Premium grade: prefinished seven or nine ply hardwood veneer core with no internal voids, 12.7mm thickness.
 - .2 Bottoms: Hardwood plywood of same species as drawer sides, 12.7mm mm thick.
 - .3 Joinery: Meeting requirements of NAAWS for Grade specified.

2.12 SHOP APPLIED FINISH COATINGS

- .1 Finish system: NAAWS system 2, pre-catalyzed lacquer premium grade. Maximum VOC content of 55 g/l.
- .2 Apply finish system component materials in accordance with manufacturer's instructions.

2.13 CABINET HARDWARE

- .1 Cabinet hardware: to NAAWS quality grade specified and to ANSI/BHMA A156.9, designated by letter B and numeral identifiers as listed below.
- .2 Finish:
 - .1 Exposed hardware: Nickel unless otherwise noted.
 - .2 Semi-exposed hardware: Nickel unless otherwise noted.
- .3 Casework door hinges: concealed European style hinges minimum 125° opening, 3 dimensional independent adjustment, full or half overlay as required, integral soft-close function. 95° opening angle where doors open against walls. Two hinges per typical door, three hinges per door up to 1200mm tall, four hinges for full height doors. BLUM Cliptop Blumotion.
- .4 Pulls: U-shaped wire pulls, 89mm c/w screw fastening, dull nickel finish #195, Richelieu #33204 or approved alternate.
- .5 Shelf pilasters: adjustable recessed shelf pilasters, Knappe and Vogt 255 & 256, zinc.
- .6 Drawer slides:
 - .1 Slide type: Accuride 3832 series by Richelieu Ltd or approved equal, soft close
 - .2 Extension and capacity: full extension meeting requirements of NAAWS for type and size of drawer.
- .7 Door/Drawer bumpers: clear self adhesive rubber bumpers, provide two per door or drawer. Supply min. 1 spare bumper per door/drawer.

2.14 CABINET LOCKS

- .1 Cabinet locks: as listed below.

- .1 Door or drawer locks: provide one lock per drawer and each single door and one lock per paired doors, locate lock on right hand door typical.
- .2 Acceptable products:
 - Olympus 078
 - National Cabinet Lock C8702
 - Corbin CCL 02067
- .2 Keying: All locks keyed alike.
 - .1 Provide 2 keys per lock.
- .3 Finished to nickel

2.15 ACCESSORIES

- .1 Wood screws: steel, type and size to suit application.
- .2 Nails and staples: to [CSA B111](#) and [ASTM F 1667](#).
- .3 Splines: wood.
- .4 Sealant: in accordance with Section 07 92 00 - Joint Sealants.

3 EXECUTION

3.01 EXAMINATION

- .1 Verification of Conditions: verify conditions of substrates previously installed under other Sections or Contracts are acceptable for architectural woodwork installation in accordance with manufacturer's instructions.
 - .1 Visually inspect substrate.
 - .2 Inform Consultant of unacceptable conditions immediately upon discovery.
 - .3 Proceed with installation only after unacceptable conditions have been remedied.

3.02 INSTALLATION

- .1 Install architectural wood casework in accordance with NAAWS grade for respective items.
- .2 In case of conflict between Contract Documents and NAAWS grade requirements, Contract Documents govern.
- .3 Install prefinished millwork at locations shown on drawings.
 - .1 Position accurately, level, plumb straight.
- .4 Fasten and anchor millwork securely.
 - .1 Supply and install heavy duty fixture attachments for wall mounted cabinets.
- .5 Countersink mechanical fasteners at exposed and semi-exposed surfaces, excluding

installation attachment screws and screws securing cabinets end to end.

- .6 Use draw bolts in countertop joints.
- .7 Scribe and cut as required to fit abutting walls and to fit properly into recesses and to accommodate piping, columns, fixtures, outlets or other projecting, intersecting or penetrating objects.
- .8 At junction of plastic laminate counter back splash and adjacent wall finish, apply small bead of sealant in accordance with Section 07 92 00 - Joint Sealants.
- .9 Apply moisture barrier between wood framing members and masonry or cementitious construction.
- .10 Fit hardware accurately and securely in accordance with manufacturer's written instructions.
- .11 Make cutouts for inset equipment and fixtures using templates provided.

3.03 CLEANING

- .1 Progress Cleaning: clean in accordance with Section 01 74 00 - Cleaning.
 - .1 Leave Work area clean at end of each day.
- .2 Final Cleaning: upon completion remove surplus materials, rubbish, tools and equipment in accordance with Section 01 74 00 - Cleaning.

3.04 PROTECTION

- .1 Protect cabinet work from damage.
- .2 Protect installed products and components from damage during construction.
- .3 Repair damage to adjacent materials caused by architectural woodwork installation.

END OF SECTION

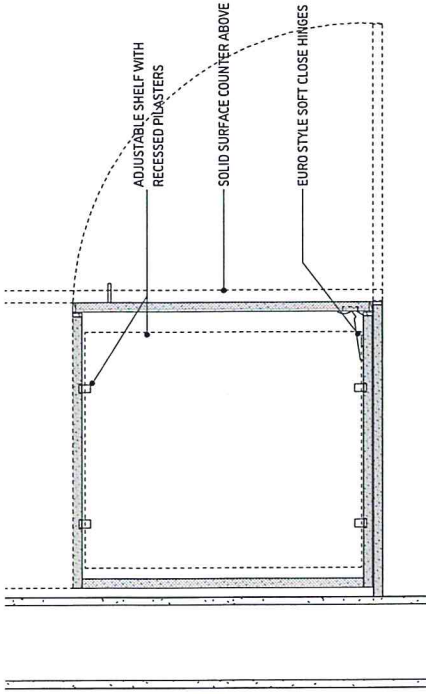

1 Base Cabinet Single Door Plan

1:10

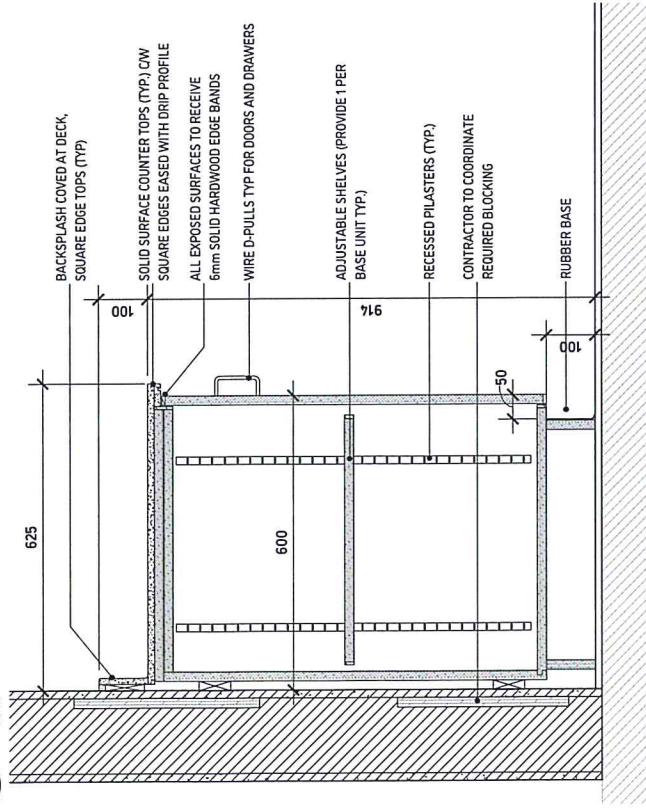

2 Base Cabinet Unit Section

1:10

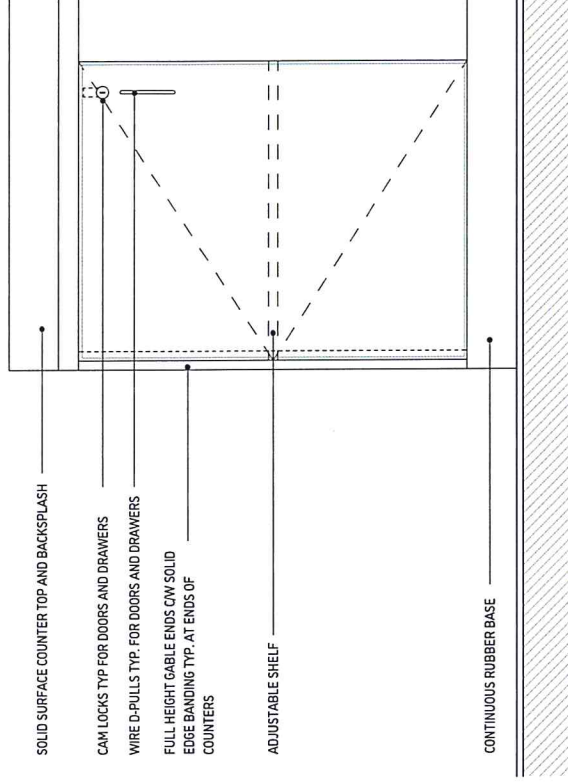

3 Base Cabinet Single Door Elevation

1:10

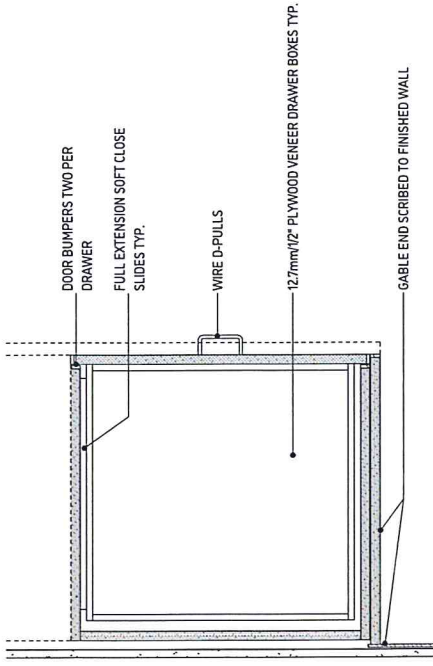

1 06 Base Cabinet Drawer Unit Plan

1:10

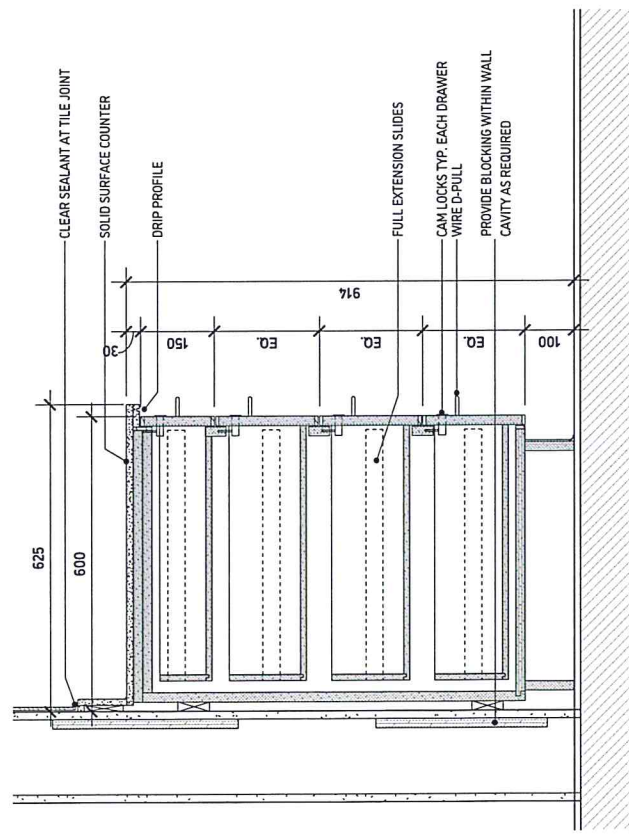

2 06 Base Cabinet Drawer Unit Section

1:10

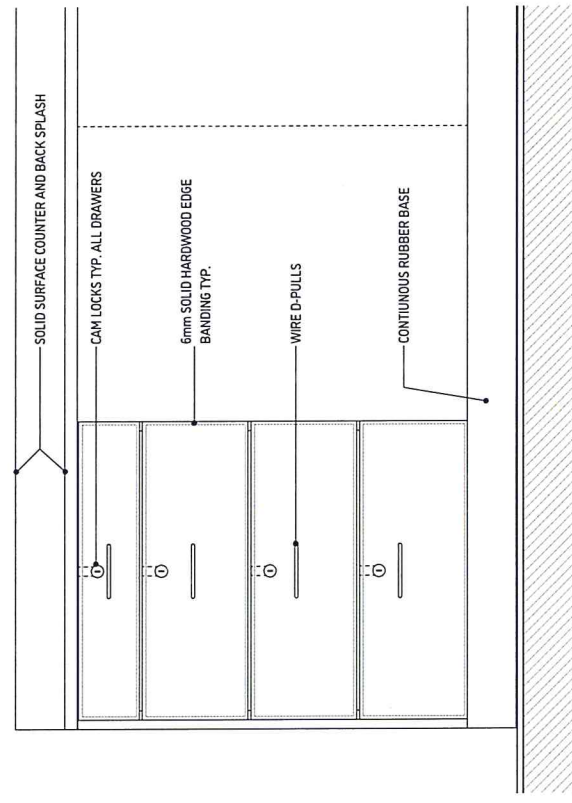

3 06 Base Cabinet Drawer Unit Elevation

1:10

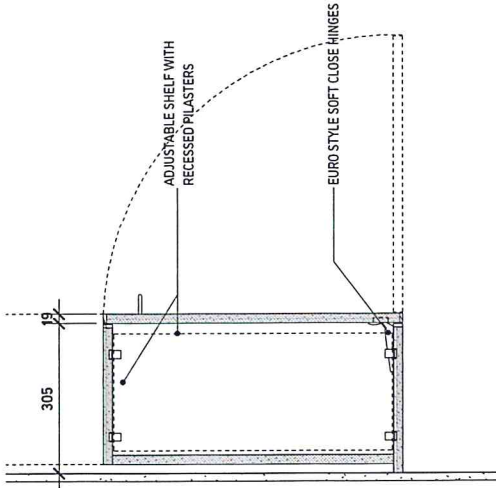

1 Upper Unit Single Door Plan

1:10

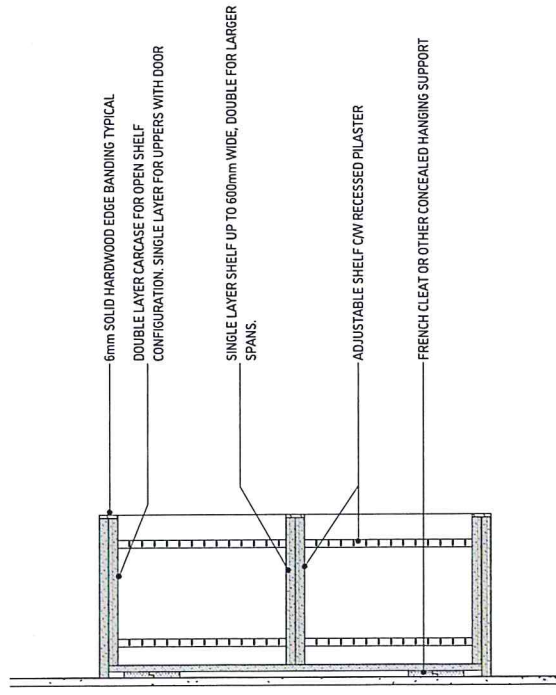

2 Upper Cabinet Unit Section (Open shelf version)

1:10

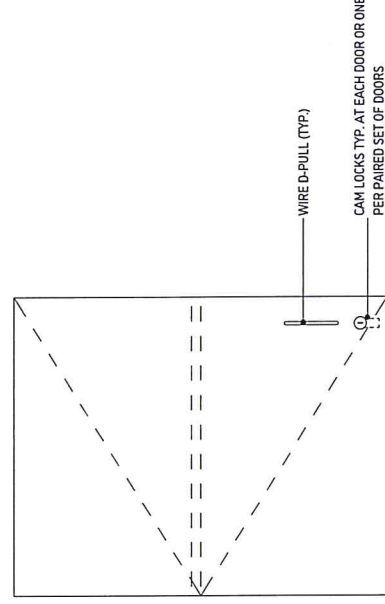

3 Upper Unit Single Door Elevation

1:10